

**GUARD RAIL REQUIRED**

**ON LEFT**  
 Sta. 43+70 to Sta. 43+96 Length 26 ft.  
 - 45+37 - 45+81 - 26'  
 - 47+52 - 47+76 - 26'  
 - 53+82 - 53+26 - 26'  
 - 57+22 - 57+66 - 26'

**ON RIGHT**  
 Sta. 43+70 to Sta. 43+96 - 26'  
 - 45+37 - 45+81 - 26'  
 - 47+52 - 47+76 - 26'  
 - 49+50 - 51+70 - 226'  
 - 53+06 - 57+46 - 240'  
**TOTAL THIS SHEET 856'**

**STONE BASE REQUIRED**

Sta. 43+00 to Sta. 47+00 Length 400 ft.

**NEW CULVERTS REQUIRED**

Sta. 43+825 Plain Concrete Culvert 1.4 cu. yds. (100%)  
 " 45+69 " " 3.0 " (234)  
 " 47+69 " " 4.8 " (364)  
 " 47+69 " " 6.3 " (474)  
 " 47+69 " " 0.8 " (63)  
 " 55+193 10" Con. Iron 32' Concrete Headwalls 2.7 " (204)  
 " 57+365 16" " 26' " 1.8 " (138)

PER. ROAD DIST. NO.	STATE	FED. AID PROJ. NO.	FED. AID PROJ. YEAR	SHEET NO.	TOTAL SHEETS
2	FL.	7	1964	6	16

PLAT 11/11/64  
 G.A. Reed  
 G.A.R.  
 D.R. Donahue  
 4/13/68

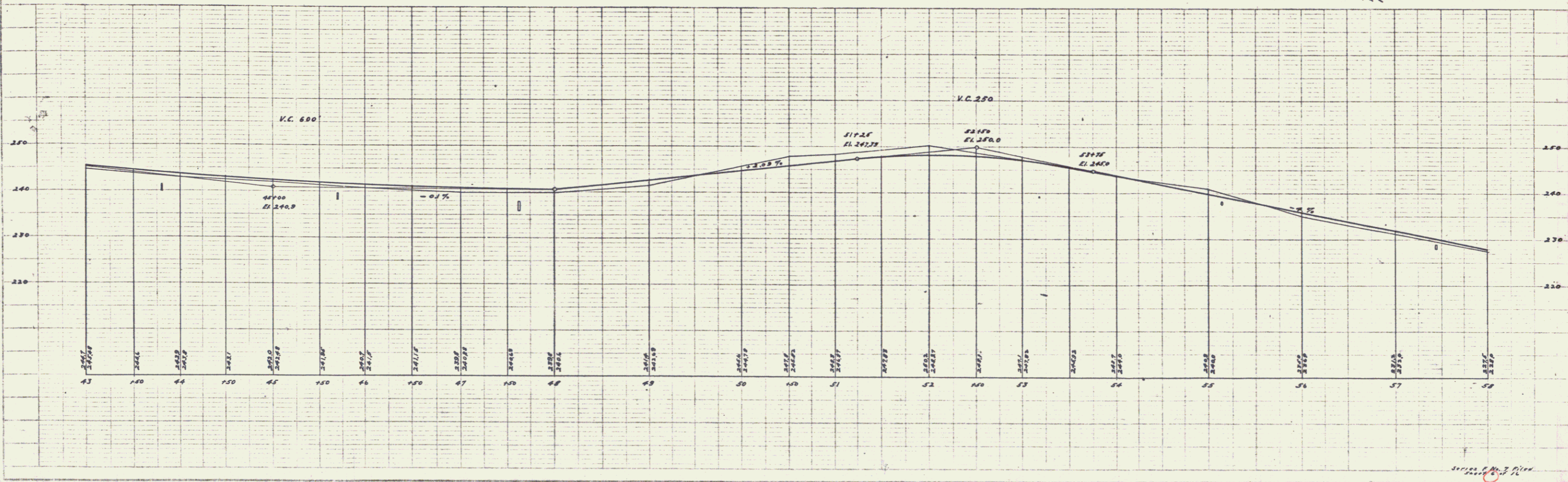
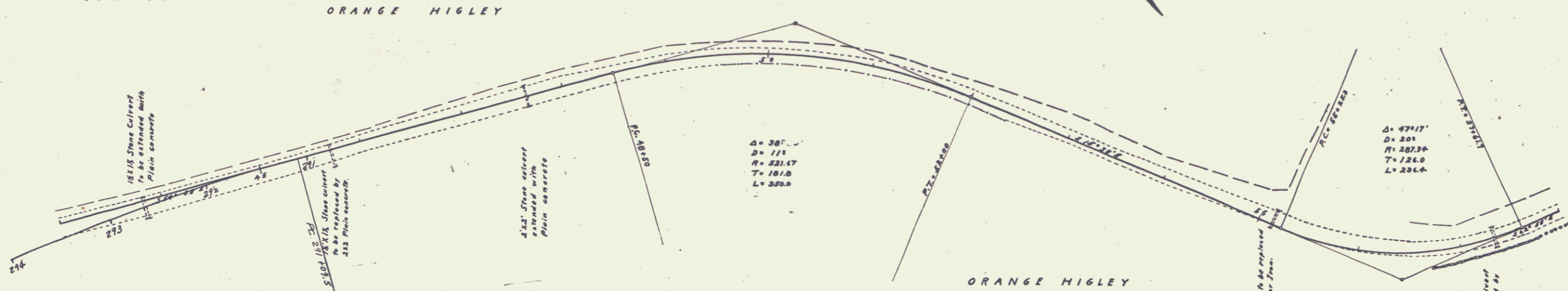

PLAT 11/11/64  
 G.A. Reed  
 G.A.R.  
 D.R. Donahue  
 4/13/68