

WOOD GUIDE RAIL REQUIRED

Cul. Sta.	Left	Right
439+00		

WOOD GUIDE POSTS REQUIRED

Cul. Sta.	Left	Right
432+00		
435+00		
442+00		

CABLE GUARD RAIL REQUIRED

Stations	Left	Right	Req. Length
431+00-437+36.8	96'	78'	174'
435+00	48'	48'	96'

NEW REIN. CONC. PIPE CULVERTS REQUIRED

Station	Diam.	Length	C.R.M.
432+00	24"	40'	34 cy
437+00	24"	40'	34 cy
442+30	15"	40'	14

CULVERT REPAIRS REQUIRED

Station	Size	Comp. H. Steel
439+00	4'x6'	15.6 cy 1067'

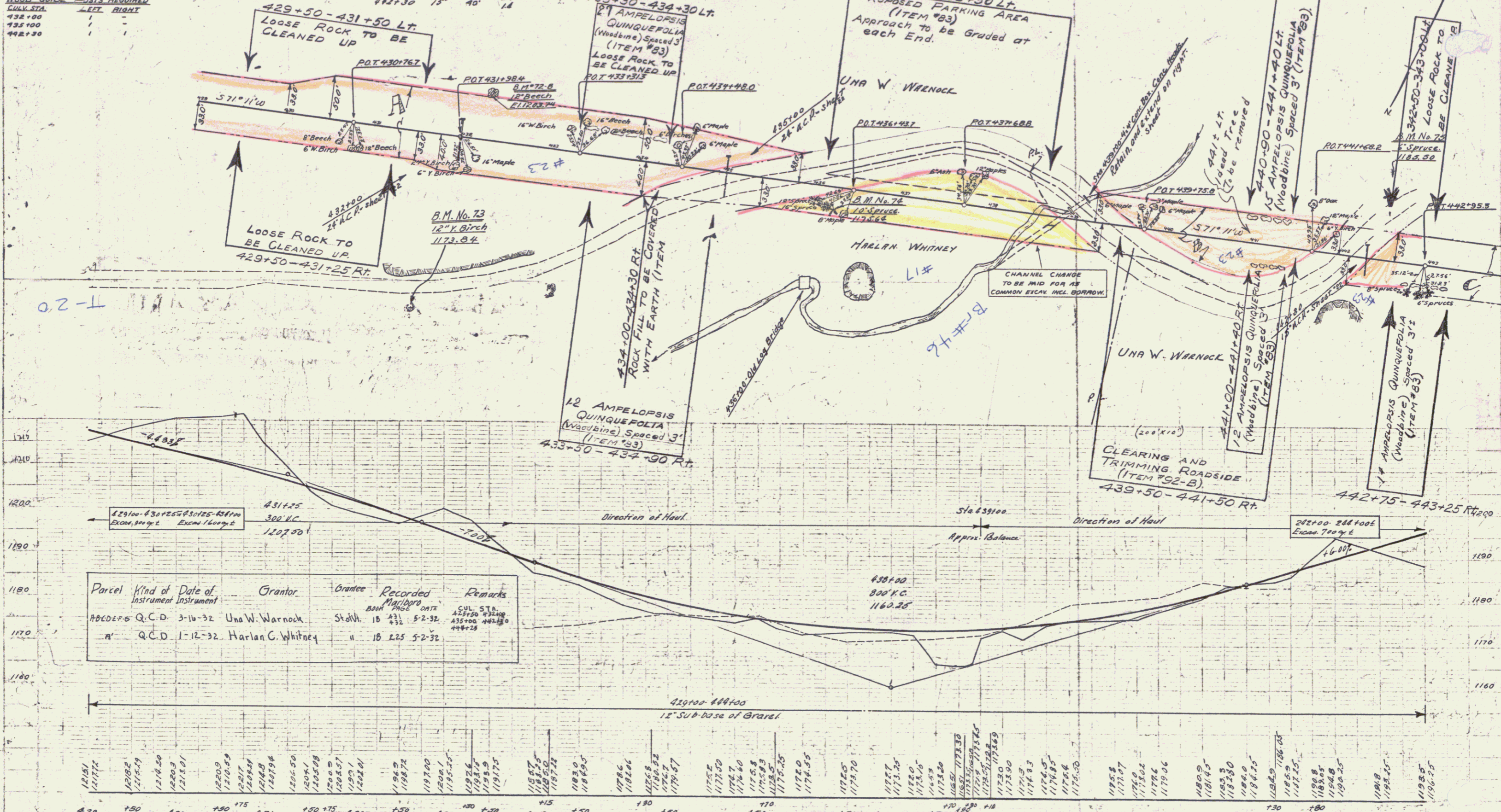

Parcel	Kind of Instrument	Date of Instrument	Grantor	Grantee	Recorded	Remarks
ABCEDEF-5	Q.C.D.	3-16-32	Una W. Warnock	Stoltz	18 231 5-2-32	CUL. STA. 432+00-437+36.8 435+00-442+30 444+25
"	Q.C.D.	1-12-32	Harlan C. Whitney	"	18 225 5-2-32	

Station	Elevation	Station	Elevation	Station	Elevation
429	1171.72	430	1175.49	431	1178.50
432	1178.50	433	1181.46	434	1184.42
435	1187.21	436	1191.75	437	1197.00
438	1202.75	439	1207.50	440	1212.25
441	1217.50	442	1222.25	443	1227.00
444	1231.75				

B.M. No. 72 Spike in root of 12" Birch, 198 ft. right of Sta. 431+48 Elev. 1173.84
 B.M. No. 74 Spike in root of 10" Spruce, 20 ft. right of Sta. 436+25 Elev. 1175.64
 B.M. No. 75 Spike in root of 6" Spruce, 70 ft. left of Sta. 442+50 Elev. 1186.50
 B.M. No. 72-B Spike in root of 12" Birch, 50' left of Sta. 437+00 Elev. 1203.74