

INDEX OF SHEETS

- SHEET NO. 1 TITLE PAGE
- " 2 TYPICAL CROSS-SECTION OF IMPROVEMENT { 2% CRUSHED STONE MIXED-IN-PLACE SURFACE COURSE WITH CUT-BACK ASPHALT AND TRICK COAT OF REFINED TAR (ITEMS 28 A, 28 B & 28 C)
- " 3 BANKING AND WIDENING TABLES
- " 4-8 PLAN AND PROFILE SHEET
- " 9 STANDARD SHEET; 30 - BARRICADES, SIGNS AND LIGHTS

FED. ROAD DIST. NO.	STATE	FED. AID PROJ. NO.	FISCAL YEAR	SHEET NO.	TOTAL SHEETS
9	VT.	63-D	1935	1	6

STATE OF VERMONT
STATE HIGHWAY DEPARTMENT

PLAN AND PROFILE OF PROPOSED
STATE HIGHWAY

FEDERAL AID PROJECT

TOWN OF WILMINGTON

Pin# 99R 834

BRATTLEBORO-BENNINGTON ROAD
FROM 955 FT WEST OF A CONCRETE ARCH
BRIDGE OVER BEAVER BROOK WESTERLY 0.212
MILES.

LENGTH OF PROJECT 11216 FT = 0.212 MILES

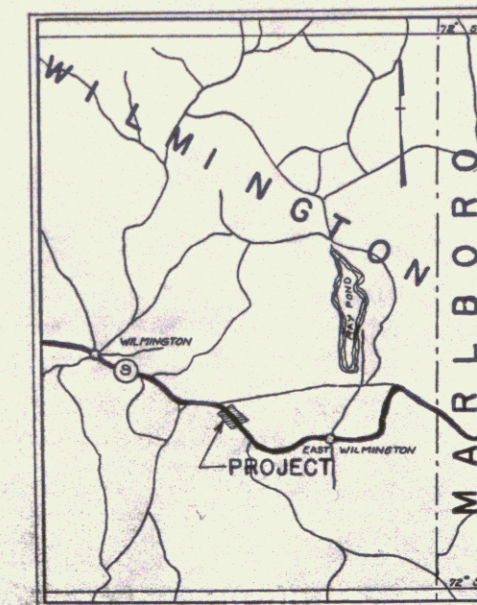

RIGHT-OF-WAY DIVISION
TOWN FILE
PERPETUAL

Town of VT 9
(To Be Returned To R.O.W. Division)

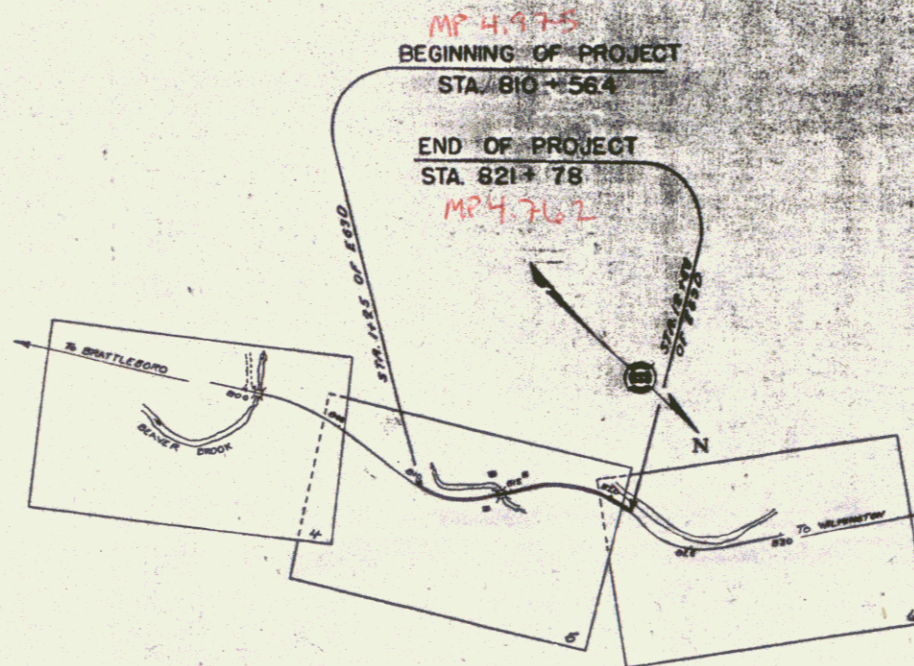

Note:
The alignment and grades for this project are to be the same as on the original plans originally submitted for F.A.P. E-63-D, except that the grade is raised 2 1/2 inches.

APPROVED: April 3 1935
H. P. [Signature]
COMMISSIONER OF HIGHWAYS
SUBMITTED BY ORDER OF THE STATE HIGHWAY BOARD

These plans are subject to such revisions as may be required by the Bureau of Public Roads and the Commissioner of Highways. Construction is to be carried on in accordance with the Plans and Standard Road and Bridge Specifications of 1930 including all subsequent approved Revisions, and such Revised Specifications and Special Provisions as are submitted with the Plans.

Route VT 9

CONVENTIONAL SIGNS

- COUNTY LINE.....
- TOWN LINE.....
- FENCE LINE.....
- STONE WALL.....
- UNFENCED PROPERTY.....
- GUARD RAIL.....
- TRAVELED WAY.....
- RAILROAD.....
- RETAINING WALL.....
- CENTER LINE.....
- SURVEY LINE.....
- CULVERT.....
- DROP INLET.....
- TROLLEY POLE.....
- POWER POLE.....
- TELEPHONE POLE.....
- TREES.....
- MEDGE.....

- GROUND ELEVATION.....
- GRADE ELEVATION.....

CURVE DATA

- DEFLECTION ANGLE..... Δ
- DEGREE OF CURVE..... D
- RADIUS OF CURVE..... R
- TANGENT DISTANCE..... T
- LENGTH OF CURVE..... L
- EXTERNAL DISTANCE..... E
- POINT OF INTERSECTION..... P. I.
- POINT OF CURVE..... P. C.
- POINT OF TANGENT..... P. T.
- POINT ON TANGENT..... P. O. T.

SCALES	
TITLE	1" = 500'
PLAN	1" = 80'
PROFILE	1" = 10'
CROSS-SECTIONS	1" = 5'

RECOMMENDED [Signature]
DISTRICT ENGINEER BUREAU OF PUBLIC ROADS
RECOMMENDED FOR APPROVAL [Signature]
CHIEF ENGINEER BUREAU OF PUBLIC ROADS
APPROVED [Signature]
DIRECTOR - BUREAU OF PUBLIC ROADS

CORRECT: April 3 1935
A. B. [Signature]
ROAD ENGINEER
SERIES F. NO. 63-D FILED
SHEET 1 OF 6

PLAN
 (Name)
 (Address)
 (City)
 (State)
 (Zip)

SECTION
 (Name)
 (Address)
 (City)
 (State)
 (Zip)

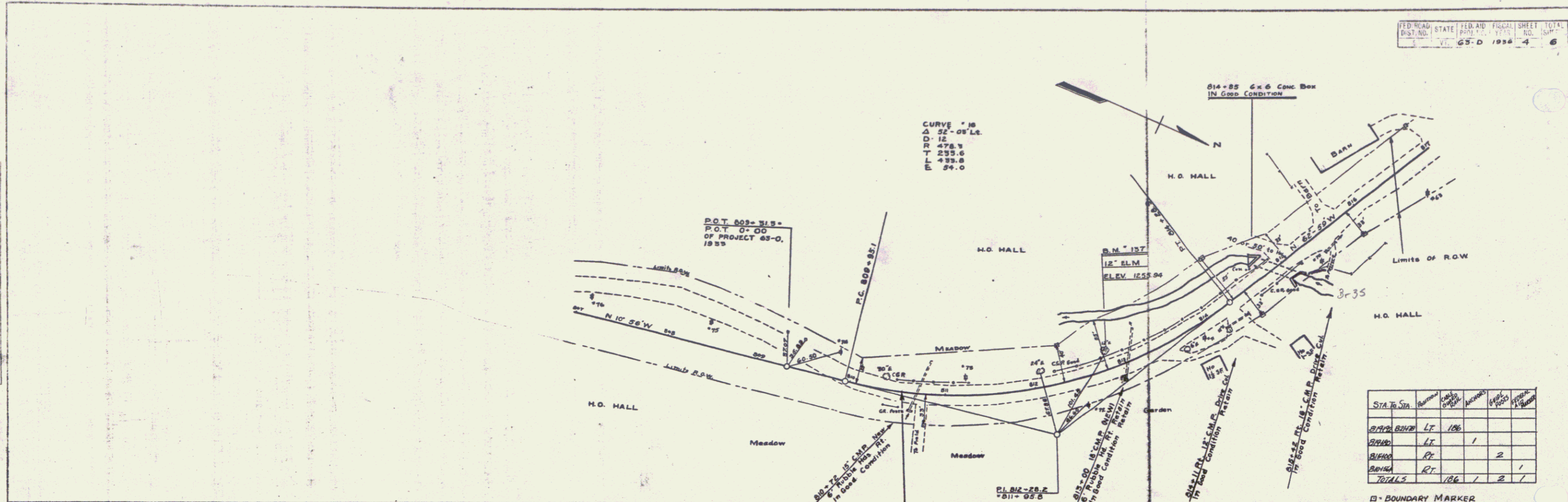

STA. TO STA.	REVISION	DATE	BY	REASON
812+28.2	LT	1936		
814+65.2	LT			
814+65.2	RT			
814+65.2	RT			
TOTALS				

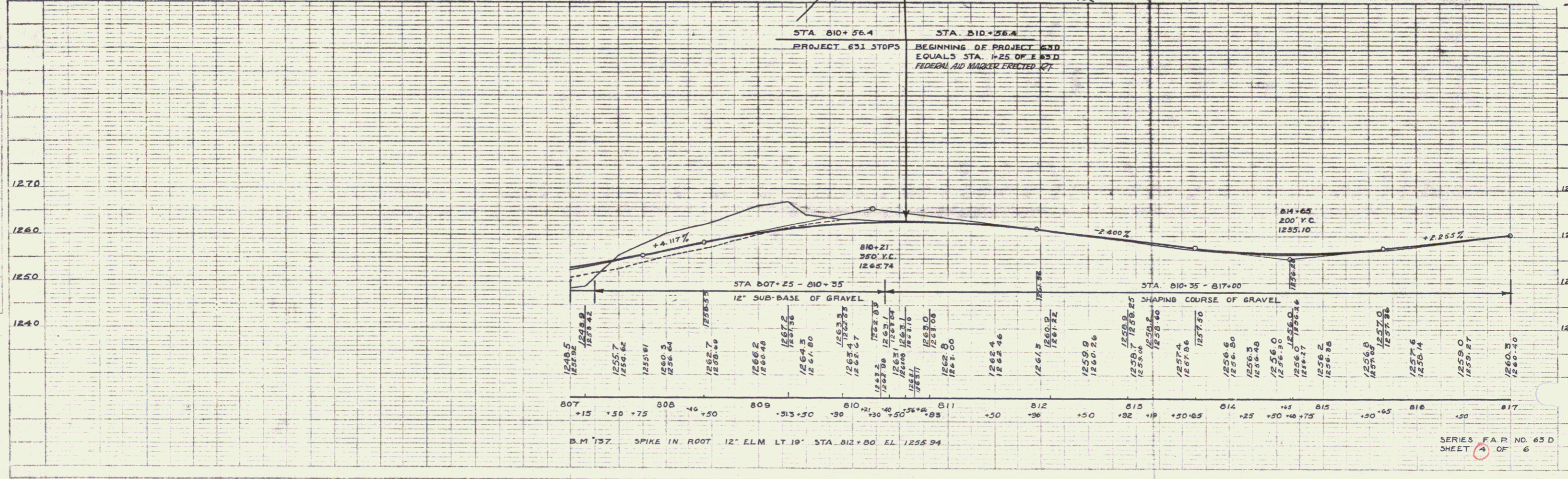

PLAN
 DATE: 8/14
 PROJECT: AMERICAN
 SHEET: 6A OF 6

PLAN
 DATE: 8/14
 PROJECT: AMERICAN
 SHEET: 6A OF 6

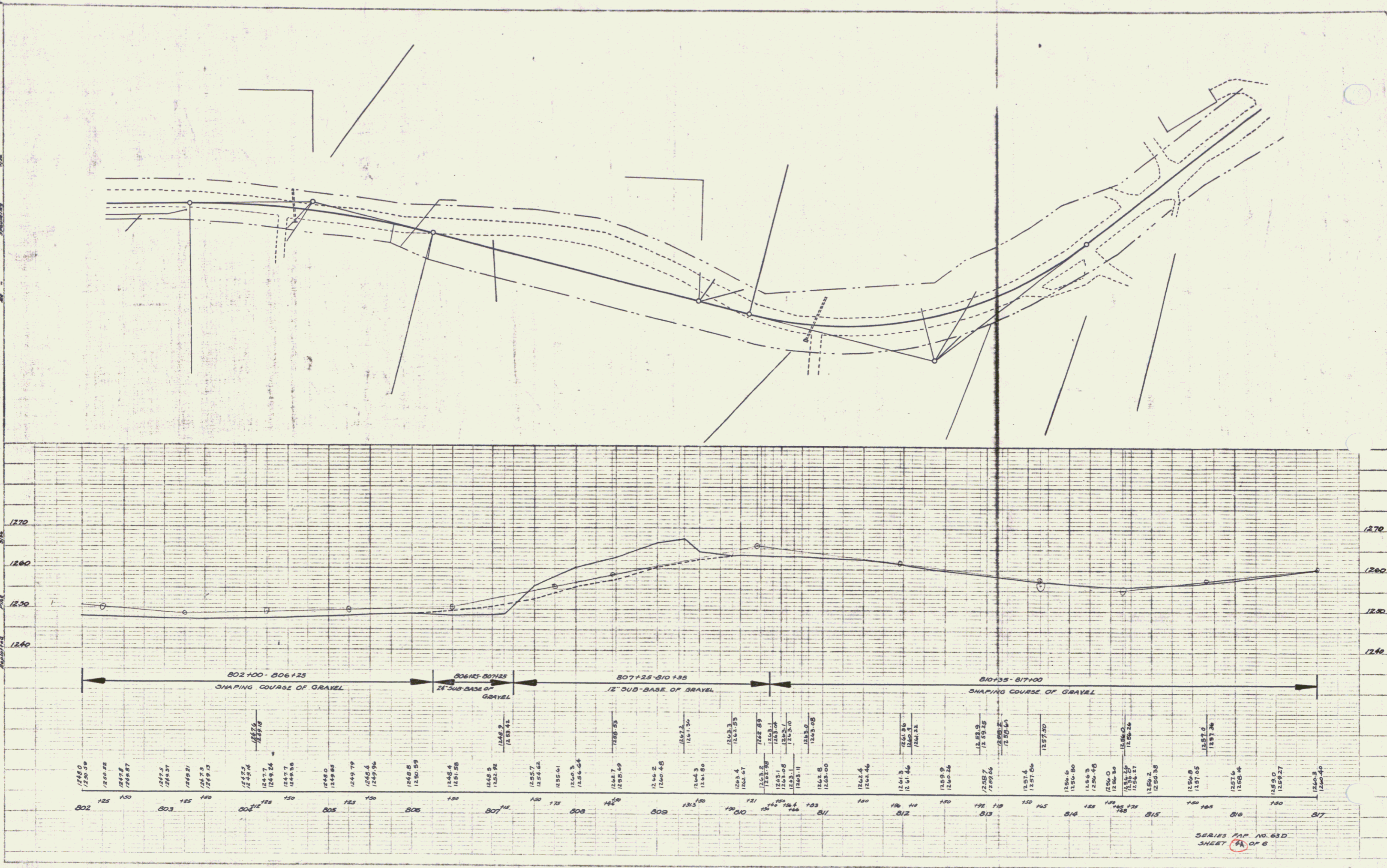

SERIES MAP NO. 63D
 SHEET 6A OF 6

