

Three Cable Guard Rail w/ Steel Posts
50+10 ~ 52+95 Lt.

CONSTRUCT DRIVE
50+00 Lt 60100 Lt
52+00 Lt
62+00 Lt

PARCEL: 6A,B,C STA: 55+45-57+77
GRANTOR: LOUISE B. EDDY,
FRANCIS W. & CHARLOTTE B. EDDY
TAKING: 3.4 AC REM: 92.6 AC
RIGHTS: DRAINAGE 65+00 Lt
WATER PIPE LINE 57+05-57+85
TITLE TAKEN: W.D. 12/11/63
RECORDED: WOODFORD BK22 Pg. 227 DT 1/19/64

Sleeve for Water Pipes, Item 431, to be installed under roadway Excavation to be done for 85' French Excavation of Earth, Item 103-A. New 3/4" x 1.315" Seamless Copper Water Tube, Item 590-A.

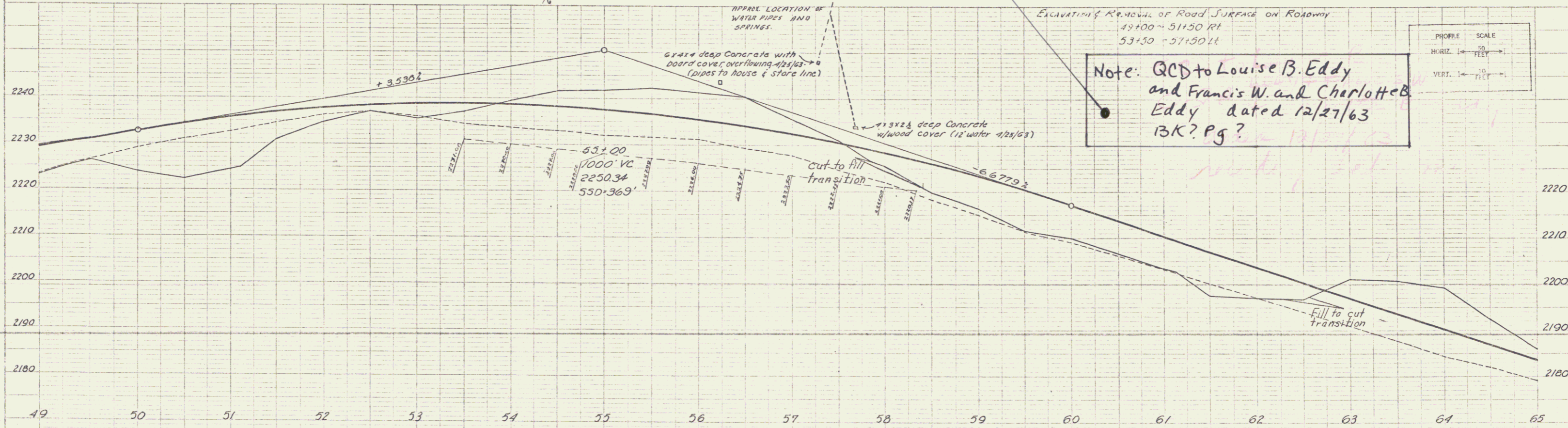
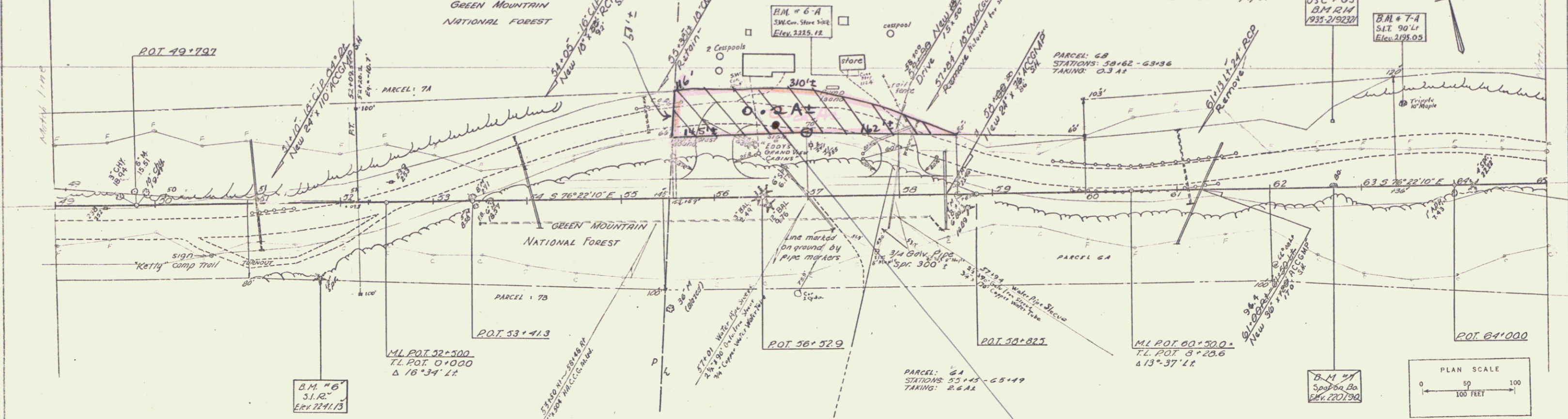

Note: QCD to Louise B. Eddy and Francis W. and Charlotte B. Eddy dated 12/27/63 BK? Pg?

PROFILE SCALE
HORIZ. 1" = 50 FEET
VERT. 1" = 10 FEET

PLAN SCALE
0 50 100 FEET

WOODFORD-SEARSBURG
Proj. F.F.L.H. 010-1(3)
Sheet #11 of 81 sheets