

WOOD GUARD RAIL REQUIRED			CABLE GUARD RAIL REQUIRED			NEW CAST IRON PIPE CULVERTS REQUIRED		
Sta.	Left	Right	Sta.	Left	Right	Sta.	Diom.	Length
48310.3	26'	26'	488160	92'	80'	492121	15"	39'
492127								75'

105-0 1931 5 47

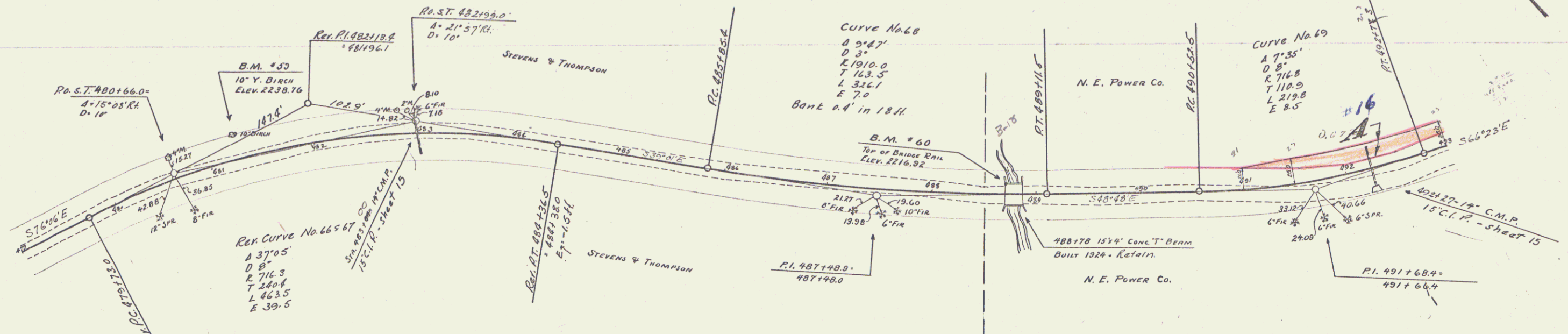

PARCEL INSTRUMENT	DATE	GRANTOR	GRANTEE	RECORDED	REMARKS
A-B-C	11-10-33	N. ENG. POWER CO.	WOODFORD	11-0-11	BOOK PAGE DATE
				19	259 12-1-33

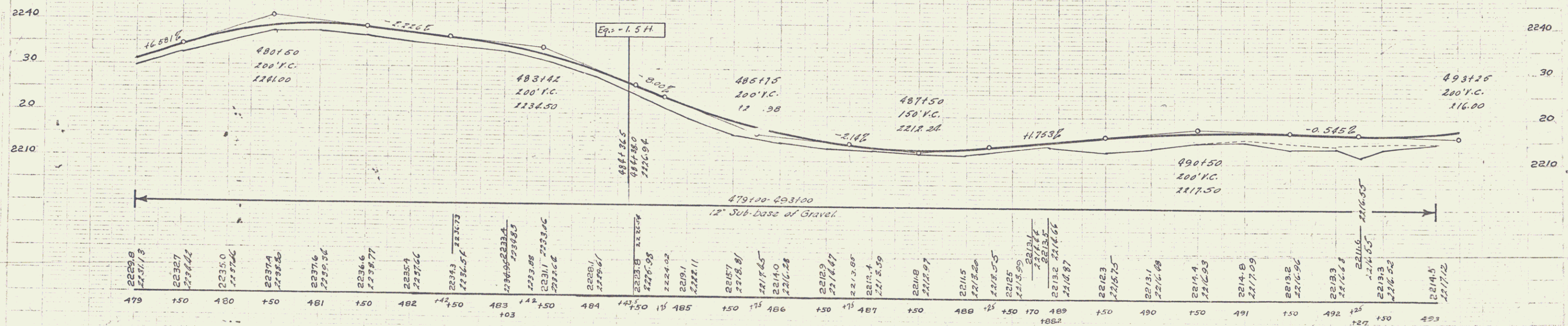

B.M. No. 59. 10" Yellow birch, 20 ft left of Sta. 48126. Elev. 2238.76  
 B.M. No. 60. Top of bridge rail, 9.5 ft left of Sta. 488170. Elev. 2216.92

SERIES F. No. 105-D  
 SHEET 5 of 47