

POTNAM
B. MACCHI
D. MACCHI
6/1/34

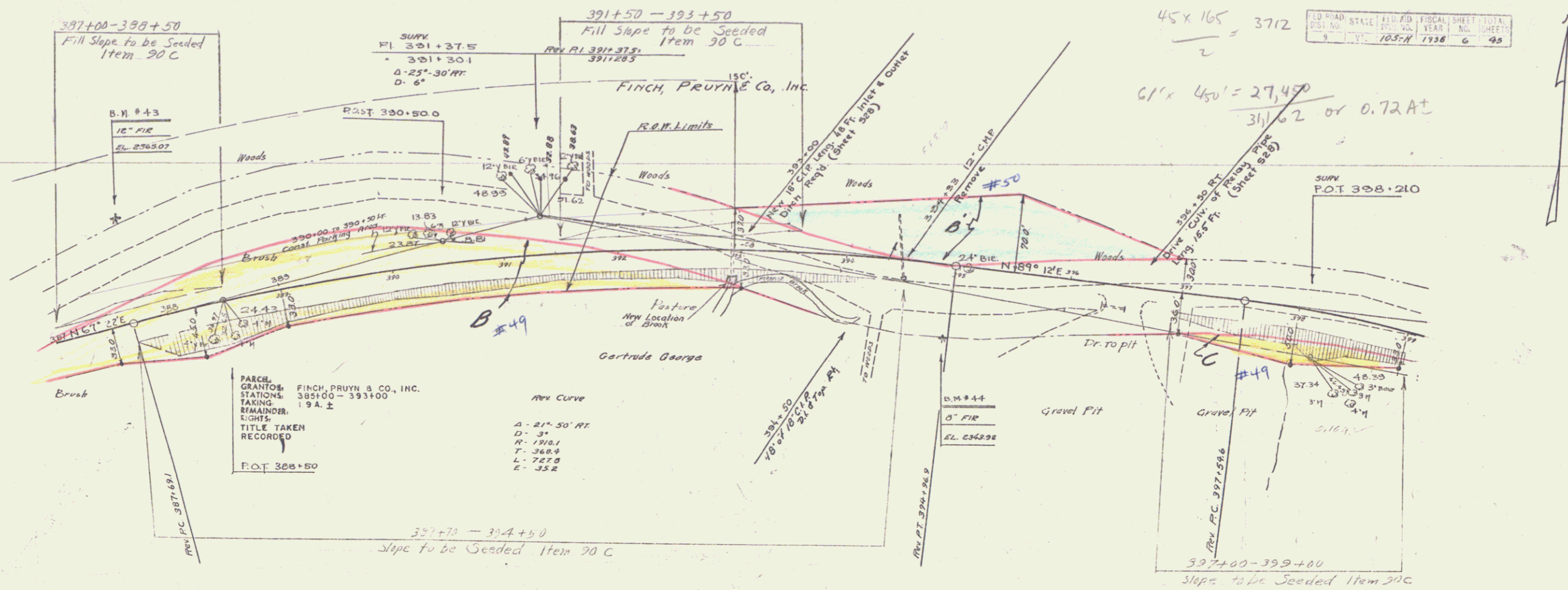

45 x 165 = 3712
 61' x 450' = 27,450
 311.62 or 0.72 AT

PARCEL GRANTOR: FINCH, PRUYN & CO., INC.
 STATIONS: 385+00 - 393+00
 TAKING: 19 A. 2
 REMAINDER
 SIGHTS
 TITLE TAKEN
 RECORDED
 P.O.T. 386+50

PARCEL	KIND OF INSTRUMENT	DATE OF INSTRUMENT	GRANTOR	GRANTEE	RECORDED BOOK PAGE DATE	REMARKS
49	A.B.C.	M.O. 6-27-35	GERTRUDE GEORGE	SPOTT	18 358 6-27-35	
50	A.D.C.	O.C.D. 8-6-35	FINCH, PRUYN & CO., INC.	"	18 352 8-10-35	

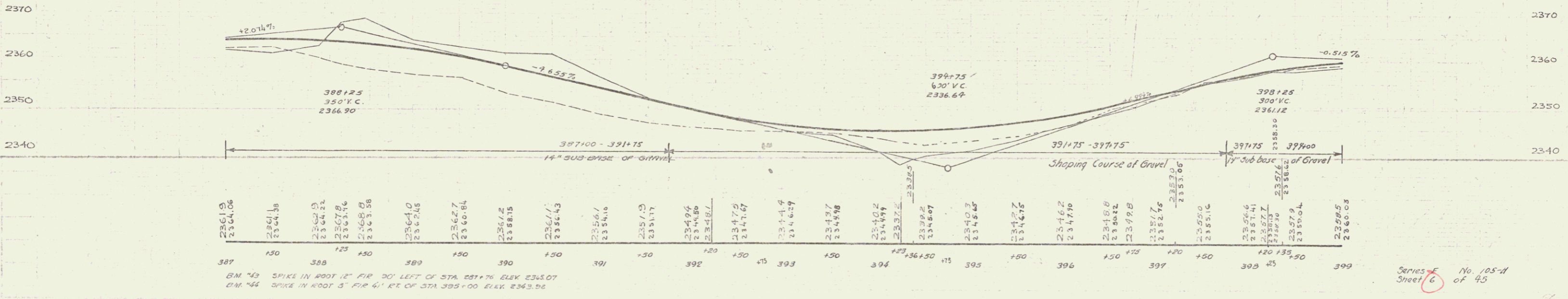

B.M. #43 SPIKE IN ROOT 12' FIR 50' LEFT OF STA. 387+76 ELEV. 2363.07
 B.M. #44 SPIKE IN ROOT 3' FIR 41' RT. OF STA. 395+00 ELEV. 2363.56

Series No. 105-H
 Sheet 6 of 45