

INDEX OF SHEETS

SHEET NO. 1	TITLE PAGE
" 2	TYPICAL CROSS-SECTION OF IMPROVEMENT (BITUMINOUS MACADAM SURFACE COURSE)
" 3	BANKING & WIDENING TABLES
" 4-11	PLAN & PROFILE SHEETS
" 12	STANDARD STRUCTURE SHEET 528 (PIPE CULVERTS)
" 13	" " " " " " 530 (GUARD RAIL)
" 14	" " " " " " 531 (BOUNDARY MARKERS)
" 15	SIGNS & LIGHTS " " 540
" 16-15	CROSS SECTIONS

Standard Sheet 528 approved by the Chief Engineer July 11, 1933.
 Standard sheet 530 approved by the Chief Engineer Aug. 15, 1933.
 Standard sheet 531 approved by the Chief Engineer July 25, 1934.

STATE OF VERMONT
 STATE HIGHWAY DEPARTMENT

PLAN AND PROFILE OF PROPOSED
 STATE HIGHWAY
 FEDERAL AID PROJECT

TOWN OF WOODFORD
 BENNINGTON-BRATTLEBORO ROAD
 FROM A POINT NEAR THE RESIDENCE OF NEWTON
 HAGER SOUTHEASTERLY 2.009 MILES.
 LENGTH OF PROJECT 10611.1 FT. = 2.009 MILES

Pin# 99R824

FED. ROAD DIST. NO.	STATE	FED. AID PROJ. NO.	FISCAL YEAR	SHEET NO.	TOTAL SHEETS
9	VT.	105-H	1936	1	45

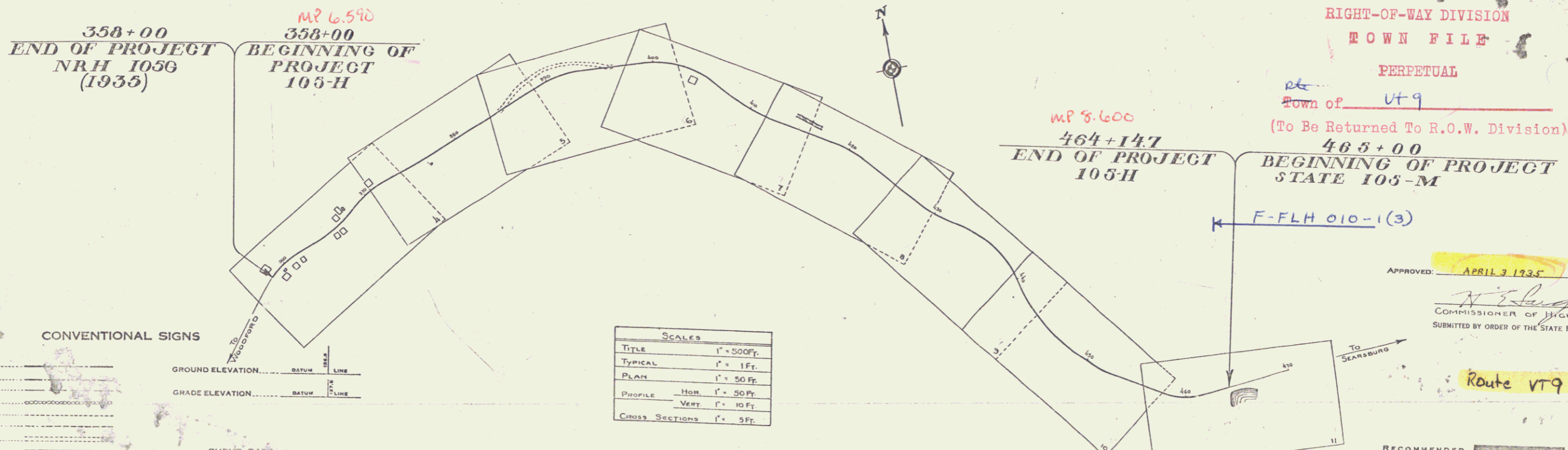
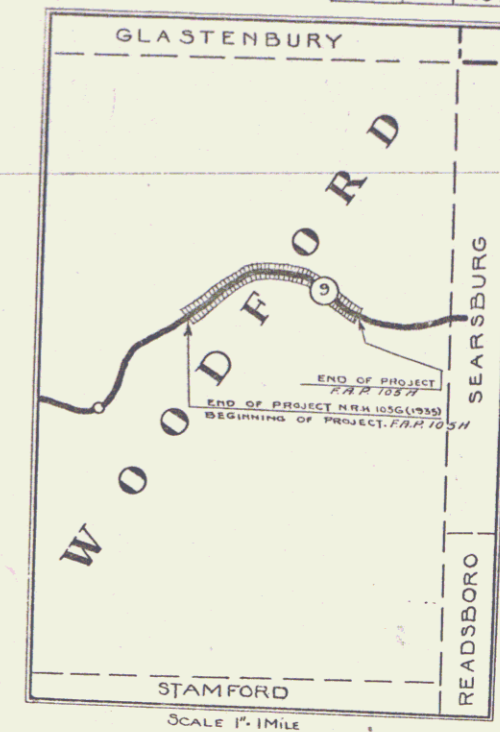

RIGHT-OF-WAY DIVISION
 TOWN FILE

PERPETUAL
 Town of VT9
 (To Be Returned To R.O.W. Division)
 465+00
 BEGINNING OF PROJECT
 STATE 105-M

F-FLH 010-1(3)

APPROVED: APRIL 3 1935
W. E. August
 COMMISSIONER OF HIGHWAYS
 SUBMITTED BY ORDER OF THE STATE HIGHWAY BOARD

Route VT9

CONVENTIONAL SIGNS

COUNTY LINE	-----
TOWN LINE	-----
FENCE LINE	-----
STONE WALL	-----
UNFENCED PROPERTY	-----
GUARD RAIL	-----
TRAVELED WAY	-----
RAILROAD	-----
RETAINING WALL	-----
CENTER LINE	-----
SURVEY LINE	-----
CULVERT	-----
DROP INLET	-----
TROLLEY POLE	-----
POWER POLE	-----
TELEPHONE POLE	-----
TREES	-----
HEDGE	-----

GROUND ELEVATION	BATHY	LINE
GRADE ELEVATION	BATHY	LINE

CURVE DATA

DEFLECTION ANGLE	D.
DEGREE OF CURVE	D.
RADIUS OF CURVE	R.
TANGENT DISTANCE	T.
LENGTH OF CURVE	L.
EXTERNAL DISTANCE	E.
POINT OF INTERSECTION	P. I.
POINT OF CURVE	P. C.
POINT OF TANGENT	P. T.
POINT ON TANGENT	P. O. T.

SCALES

TITLE	1" = 500 FT.
TYPICAL	1" = 1 FT.
PLAN	1" = 50 FT.
PROFILE - Hor.	1" = 50 FT.
Profile - Vert.	1" = 10 FT.
CROSS SECTIONS	1" = 5 FT.

NOTE
 These plans are subject to such revisions as may be required by the Bureau of Public Roads and the Commissioner of Highways. Construction is to be carried on in accordance with the plans and standard road and bridge specifications of 1930 including all subsequent approved revisions, and such Revised Specifications and Special Provisions as are submitted with the Plans.

RECOMMENDED _____
 DISTRICT ENGINEER BUREAU OF PUBLIC ROADS
 RECOMMENDED FOR APPROVAL _____
 CHIEF ENGINEER SURVEY PUBLIC ROADS
 APPROVED _____
 DIRECTOR - BUREAU OF PUBLIC ROADS

CORRECT: APRIL 3 1935
W. E. August
 ROAD ENGINEER

SERIES P. No. 105-H FILED
 SHEET 1 OF 45