

INDEX OF SHEETS - USPW Project NRH 105-G (1935)

SHEET NO. 1	TITLE PAGE
" 2	TYPICAL CROSS-SECTION OF IMPROVEMENT - BITUMINOUS MACADAM SURFACE COURSE
" 3	BANKING & WIDENING TABLES
" 3-11	PLAN & PROFILE SHEETS
" 12	STANDARD STRUCTURE SHEET 3-28 (Pipe Culverts)
" 13	" " " 3-29 (Box Culverts)
" 14	" " " 3-30 (Guard Rail)
" 15	" " " 3-31 (Boundary Markers)
" 16	" " " 38-11 (Barricades, Signs & Lights)
" 27-49	CROSS SECTIONS

STATE PROJECT 105-5

SHEET NO. 1	TITLE PAGE
" 2	TYPICAL CROSS-SECTION OF IMPROVEMENT (BITUMINOUS MACADAM SURFACE COURSE)
" 3	BANKING & WIDENING TABLES
" 3-11	PLAN & PROFILE SHEETS
" 12	STANDARD STRUCTURE SHEET 3-30 (Guard Rail)
" 13	" " " 3-31 (Boundary Markers)
" 14	" " " 38-11 (Barricades, Signs & Lights)
" 17-27	CROSS SECTIONS

STANDARD SHEETS 3-28 & 3-29 APPROVED BY THE CHIEF ENGINEER ON JULY 16, 1933.  
 STANDARD SHEET 3-30 APPROVED BY THE CHIEF ENGINEER ON AUG. 15, 1933.  
 STANDARD SHEET 3-31 APPROVED BY THE CHIEF ENGINEER ON JULY 25, 1934.

STATE OF VERMONT  
 STATE HIGHWAY DEPARTMENT

PLAN AND PROFILE OF PROPOSED  
 STATE HIGHWAY

U.S. PUBLIC WORKS HIGHWAY PROJECT  
**TOWN OF WOODFORD**  
 BENNINGTON-BRATTLEBORO ROAD  
 FROM 100 FEET WEST OF SCHOOLHOUSE EASTERLY 1.409 MILES  
 TO A POINT NEAR THE RESIDENCE OF NEWTON HAGAR  
 LENGTH OF USPW NRH 105-G (1935) 7444.7 FT. = 1.409 MI.

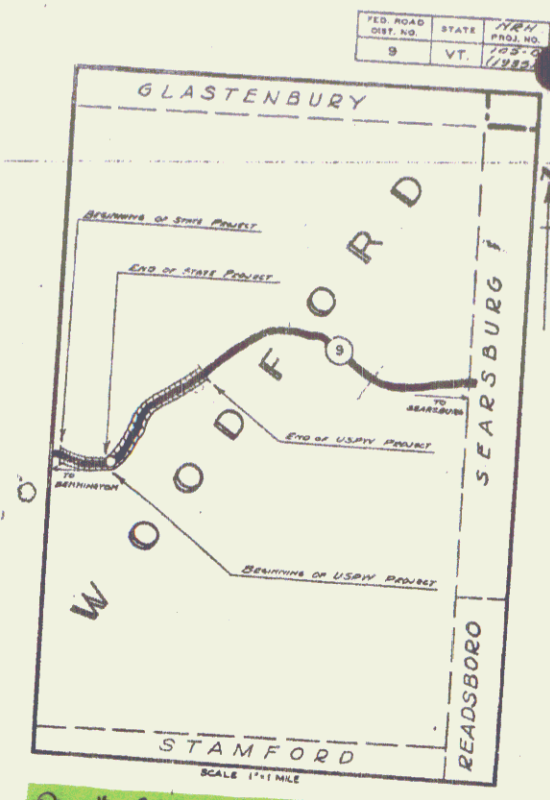

Pin # 99R022  
 Project: NRH 105-G  
 Route: VT 9

RIGHT-OF-WAY DIVISION  
 TOWN FILE  
 PERPETUAL  
 Town of VT 9  
 (To Be Returned To R.O.W. Division)

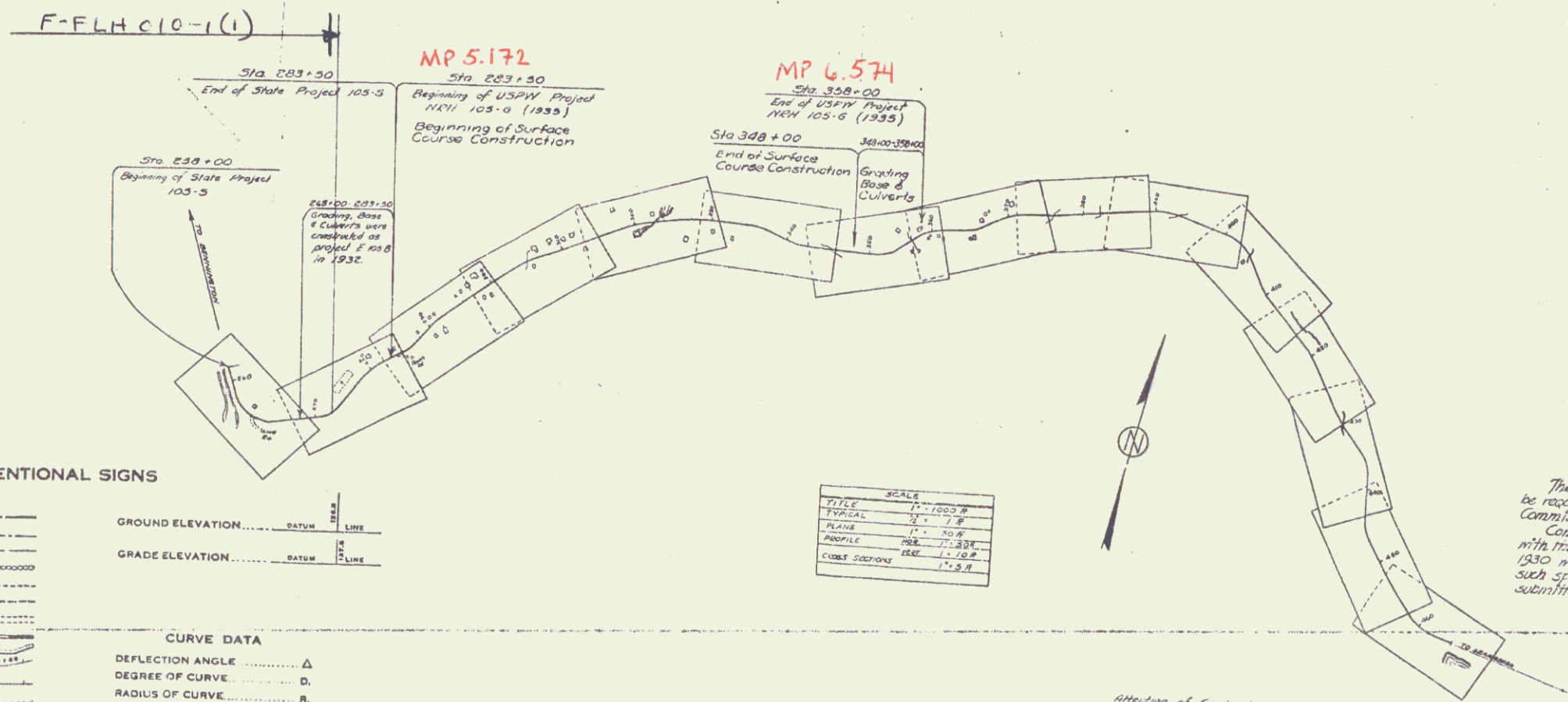

CONVENTIONAL SIGNS

COUNTY LINE	GROUND ELEVATION
TOWN LINE	FENCE LINE
STONE WALL	UNFENCED PROPERTY
GUARD RAIL	TRAVELED WAY
RAILROAD	RETAINING WALL
CENTER LINE	SURVEY LINE
CULVERT	DROP INLET
TROLLEY POLE	POWER POLE
TELEPHONE POLE	TREES
HEDGE	

CURVE DATA

DEFLECTION ANGLE	Δ
DEGREE OF CURVE	D
RADIUS OF CURVE	R
TANGENT DISTANCE	T
LENGTH OF CURVE	L
EXTERNAL DISTANCE	E
POINT OF INTERSECTION	P. I.
POINT OF CURVE	P. C.
POINT OF TANGENT	P. T.
POINT ON TANGENT	P. O. T.

TITLE	SCALE
TYPICAL	1" = 100.0'
PLAN	1" = 10.0'
PROFILE	1" = 10.0'
CROSS SECTIONS	1" = 10.0'

Attention of Contractors is called to the fact that the State Highway Board reserves the right to extend this project westerly at the same contract price. Said cost of extension not to exceed 2.5% of the amount of the contract.

These plans are subject to such revisions as may be required by the Bureau of Public Roads or the Commissioner of Highways.  
 Construction is to be carried on in accordance with the Standard Road & Bridge Specifications of 1930 with all subsequent approved revisions and such specifications and special provisions as are submitted with the plans.

APPROVED: Sept. 10, 1934  
 H. C. ...  
 COMMISSIONER

RECOMMENDED FOR APPROVAL  
 DISTRICT ENGINEER  
 RECOMMENDED FOR APPROVAL  
 CHIEF ENGINEER  
 APPROVED  
 BUREAU OF PUBLIC ROADS

CORRECT  
 SHEET 1