

Parcel	Kind of instrument	Date of instrument	Grantor	Grantee	Recorded Woodford	Remarks
32 A-B	Q.C.D.	3-26-35	Fanny J. Morgan	St. J. W.	11 371	3-29-35
32 A'	Q.C.D.	4-24-35	Geo. I. Knapp	"	11 359	4-26-35
33 A"	Q.C.D.	3-15-35	Onesiphor Bett	"	11 351	4-26-35
27 A"	Q.C.D.	10-30-33	Geo. I. Knapp	"	18 252	12-1-33
28 A"	Q.C.D.	11-1-33	Geo. I. Knapp	"	18 251	12-1-33
26 C	Q.C.D.	10-10-33	Fanny J. Morgan	"	18 257	12-1-33

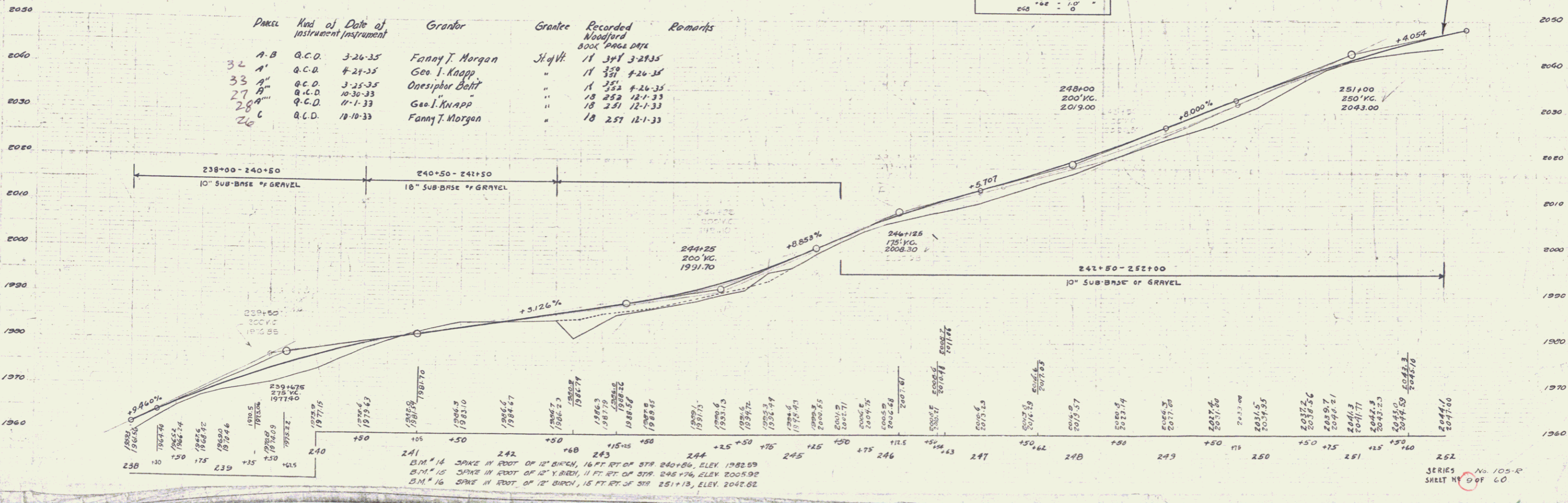

B.M. #14 SPIKE IN ROOT OF 12' BIRCH, 16 FT. RT. OF STA. 240+80, ELEV. 1982.59
 B.M. #15 SPIKE IN ROOT OF 12' Y. BIRCH, 11 FT. RT. OF STA. 245+76, ELEV. 2005.92
 B.M. #16 SPIKE IN ROOT OF 12' BIRCH, 15 FT. RT. OF STA. 251+13, ELEV. 2042.82