

| PARCEL | INSTRUMENT | DATE | GRANTOR | GRANTEE | RECORDED | REMARKS |
|--------|------------|----------|----------------------|----------|----------|---------|
| 7 | A.B. | 10-11-60 | T.J. MALLORY | WOODFORD | ST OF 17 | |
| 8 | W.D. | 10-10-60 | HARRIET & TWITCHELL | WOODFORD | ST OF 18 | |
| 9 | W.D.O.E. | 10-10-60 | LAURA & HANLEY CAREY | WOODFORD | ST OF 18 | |
| 6 | R | 10-11-60 | | | | |

FED. ROAD DIST. STATE TOTAL
 DIST. STATE TOTAL
 ER#B 1939 5 57
 WOODFORD

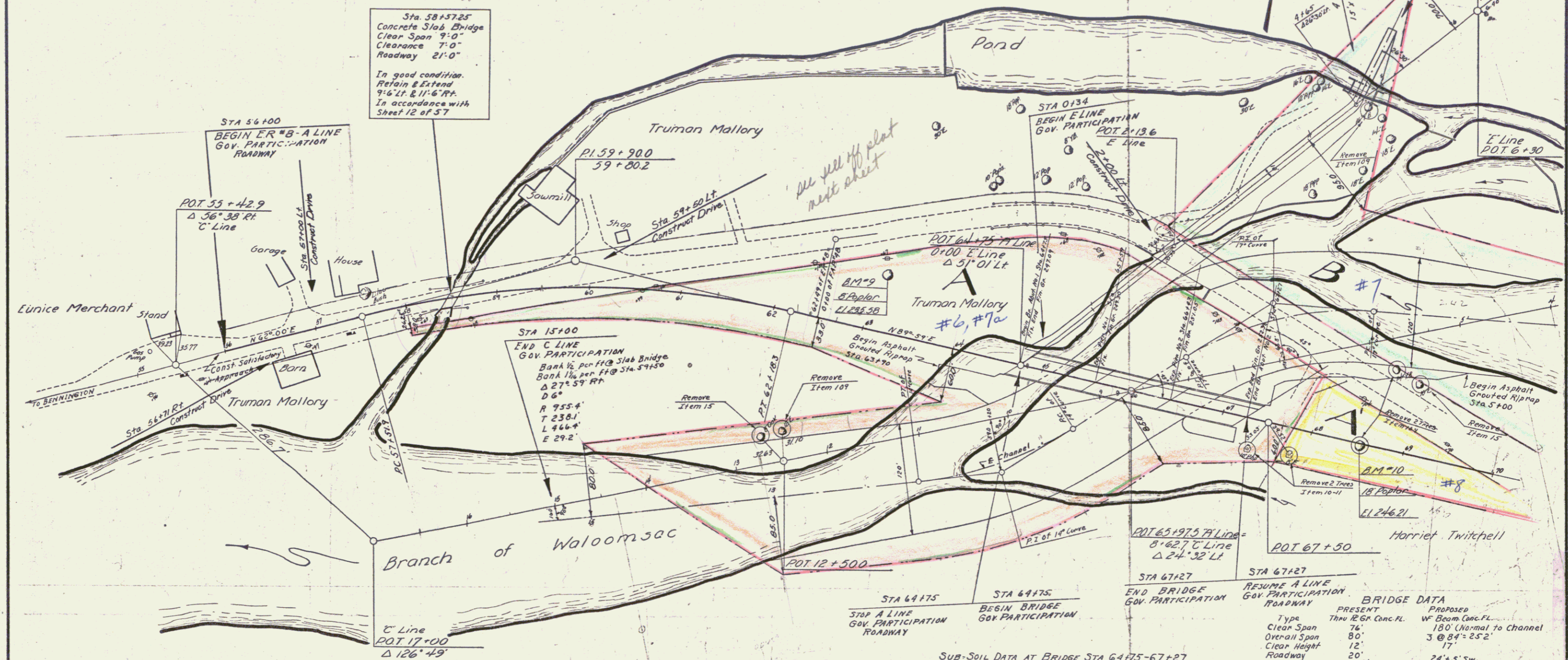

Sta. 58+57.25
 Concrete Slab Bridge
 Clear Span 9'-0"
 Clearance 7'-0"
 Roadway 21'-0"
 In good condition.
 Retain & Extend
 9'-6" T. & 11'-6" R.
 In accordance with
 Sheet 12 of 57

*all yell off plot
 next sheet*

STA 15+00
 END C LINE
 GOV. PARTICIPATION
 Bank 1/2 per FF@ Slab Bridge
 Bank 1/2 per FF@ Sta. 54+50
 Δ 27° 54' R
 D 6°
 R 755.4
 T 238.1
 L 466.4
 E 29.2

STA 64+75
 STOP A LINE
 GOV. PARTICIPATION
 ROADWAY

STA 64+75
 BEGIN BRIDGE
 GOV. PARTICIPATION

STA 67+27
 END BRIDGE
 GOV. PARTICIPATION

STA 67+27
 RESUME A LINE
 GOV. PARTICIPATION
 ROADWAY

| BRIDGE DATA | |
|--------------|--------------------------|
| PRESENT | PROPOSED |
| Type | Thru 126' Conc. Fl. |
| Clear Span | 76' |
| Overall Span | 180' (Normal to Channel) |
| Clear Height | 3 @ 8'4" = 25'2" |
| Roadway | 17' |
| Waterway | 24' S.W. = 2500' |

See sh. 73-18 Inc of 57

SUB-SOIL DATA AT BRIDGE STA 64+75-67+27
 Boulders & Coarse Gravel
 Impossible to take Wash Borings
 Each foundation will be subject to
 inspection by the Public Roads Administration
 before any concrete is placed.

WOODFORD

Surveyed by Barrett
 Designed by
 Drawn by
 Traced by Rogers
 Checked by
 Series ER No. 8 Filed
 Sheet 5 of 57 Sheets