

WOOD GUARD RAIL REQUIRED  
ON RIGHT  
Sta 145+38 to Sta 145+62 Length 24 ft  
" 150+38 " 150+62 " 24 ft  
" 144+100 " 144+12 " 12 ft

CABLE GUARD RAIL REQUIRED  
ON LEFT  
Sta 148+100 to Sta 152+123 Length 823 ft  
" 153+25 " 156+100 " 75 ft

NEW CURVES REQUIRED  
Sta 145+50 to Sta 145+70 Length 20' Lane  
Curve Class B (U-26.5) 14' Curv  
Beam Steel 16' 20"  
Sta 150+50 to Sta 150+70 Length 20' Lane  
Curve Class A (U-25) 35' Curv  
Beam Steel 58' 18"

CURVE No. (REVISED)  
Δ = 29° 13' Lt.  
D = 10"  
R = 573.0  
T = 122.9  
L = 242.2  
E = 13.0

PROJ. NO.	STA.	YEAR	SHEET NO.	TOTAL SHEETS
9	FRBA	1950	14	40

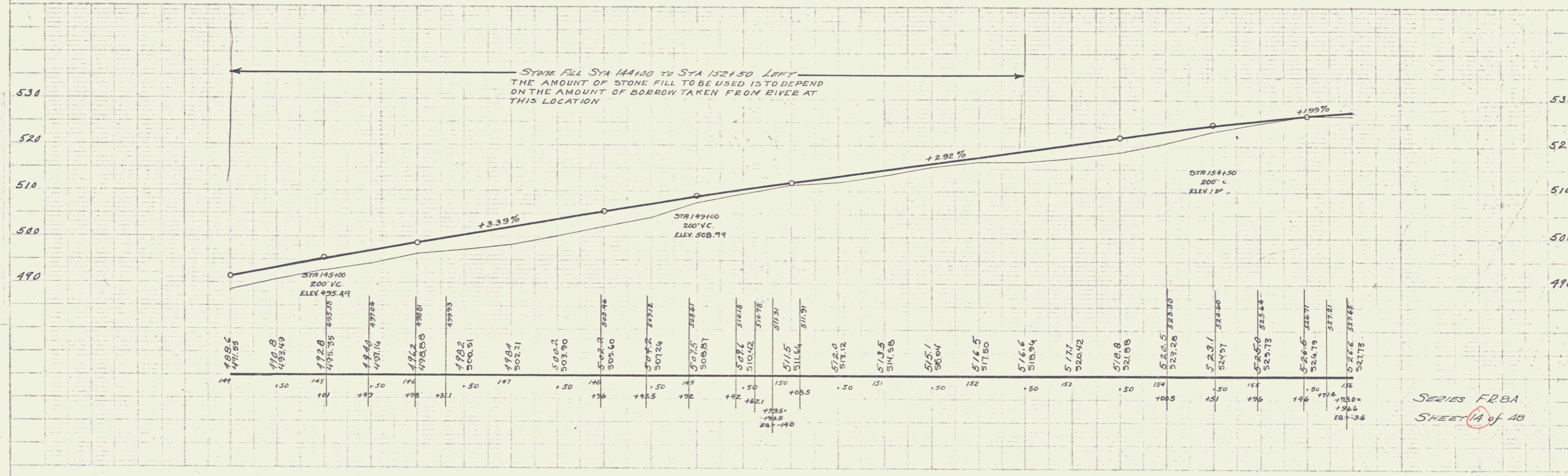
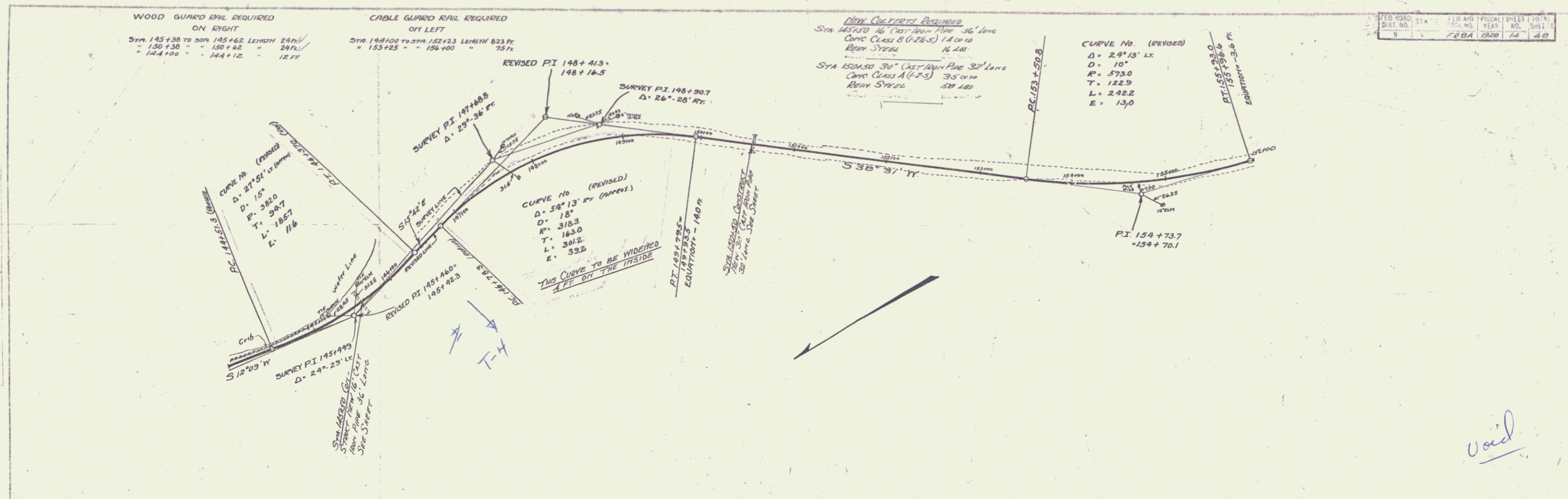

void

SERIES FRBA  
SHEET 14 of 40

MP 2.95 13