

WOOD GUARD RAIL REQUIRED  
ON LEFT

Sta 123+08 TO Sta 123+32	LENGTH	24 FT
124+08	"	24 FT
124+32	"	24 FT
124+56	"	24 FT

ON RIGHT

Sta 121+88 TO Sta 121+92	LENGTH	24 FT
123+08	"	24 FT
124+08	"	24 FT
124+32	"	24 FT
124+56	"	24 FT

CABLE GUARD RAIL REQUIRED  
ON LEFT

Sta 120+25 TO Sta 121+77 LENGTH 152 FT

BORROW  
Sta 120+00 TO 125+00 LEFT  
BORROW TO BE OBTAINED FROM  
THIS SECTION AT THE DISCRETION  
OF THE ENGINEER

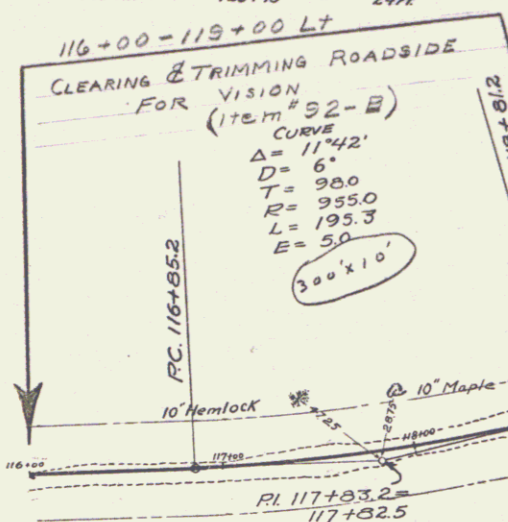

$PI = 7+69 \pm FFLH105(14)$

$PI = 125+43.4 = 125+32.2$

New Curbs Required

Sta 121+60 24" Cast Iron Pipe 28' Long  
Cone Class A (1.2-A) 28' Long  
Rein. Steel 34 LB

Sta 123+20 16" Cast Iron Pipe 32' Long  
Cone Class B (1.2-B) 27' Long  
Rein. Steel 33 LB

Sta 124+20 30" Cast Iron Pipe 34' Long  
Cone Class A (1.2-A) 35' Long  
Rein. Steel 50 LB

Sta 126+55 16" Cast Iron Pipe 28' Long  
Cone Class B (1.2-B) 27' Long  
Rein. Steel 33 LB

DIST. NO.	STATE	FED. AID	FISCAL YEAR	SHEET NO.	TOTAL SHEETS
9	VT		FEB 1928	18	48

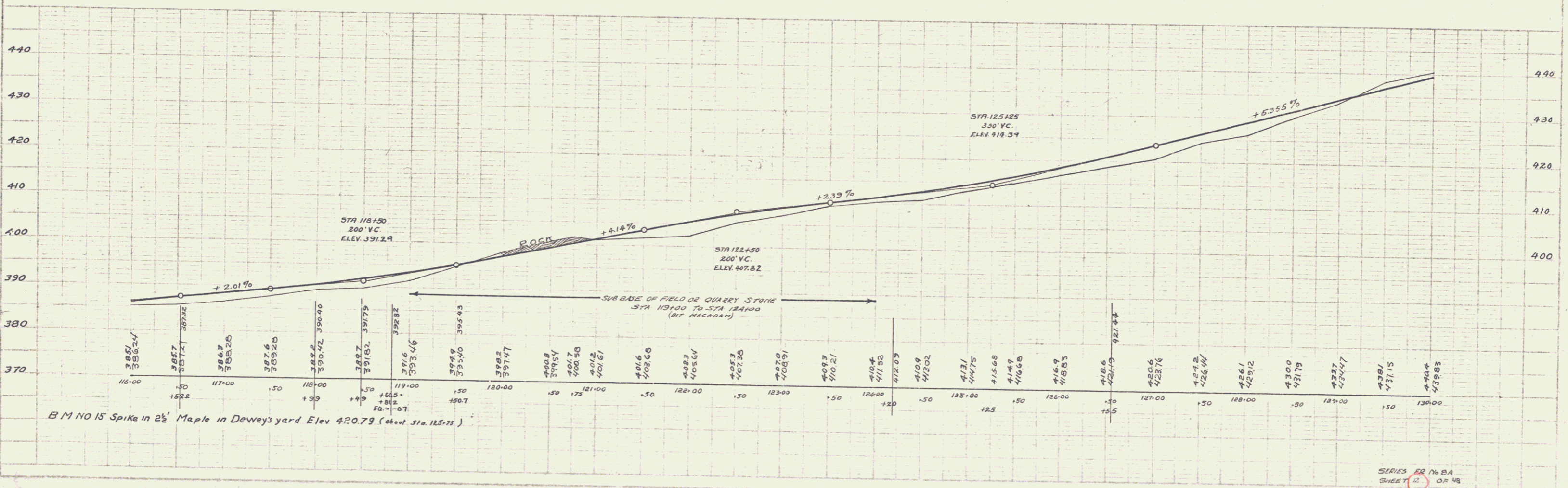
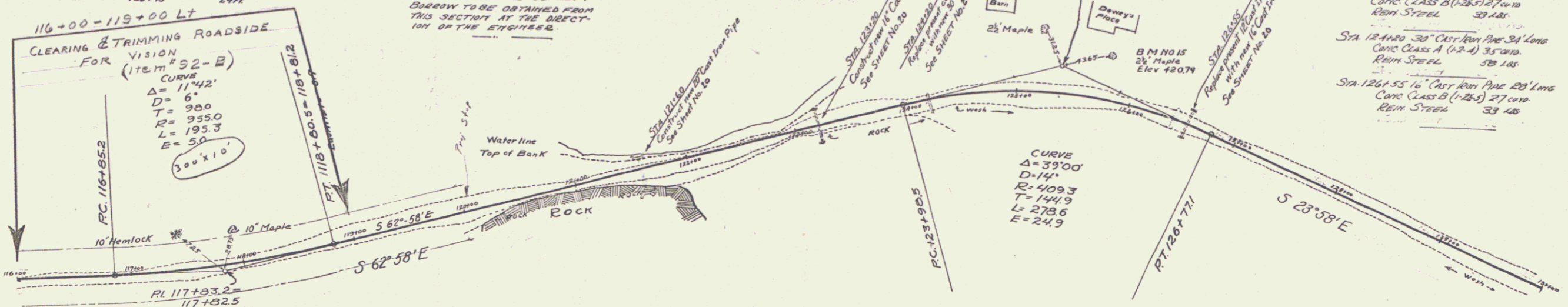

B.M. NO 15 Spike in 2 1/2 Maple in Dewey's yard Elev 420.79 (about Sta. 115+75)

SERIES FOR No. 2A  
SHEET 12 OF 48