

$\Delta 16^{\circ}20' E$
 $D 4'$
 $R 1432.7$
 $T 205.6$
 $L 408.3$
 $E 14.7$

OLD PAVEMENT STA 95+00 TO
 98+50 IS TO BE REMOVED. THIS
 TO BE PAID AS SOLID ROCK EXCAV. ITEM 10

- NOTE -

ALL CUTTING OF TREES BETWEEN
 BEGINNING OF PROJECT AND STA.
 110+80 SHALL BE PAID AS CLEARING
 & GRUBBING, ITEM 13.

PARCEL	INSTRUMENT	DATE	GRANTOR	GRANTEE	RECORDED	REMARKS
#9	A	W.D.O.E. 7-6-40	W.L. SHIELDS AND ANNA T. SHIELDS		BOOK PAGE DATE 1 542 7-6-40	

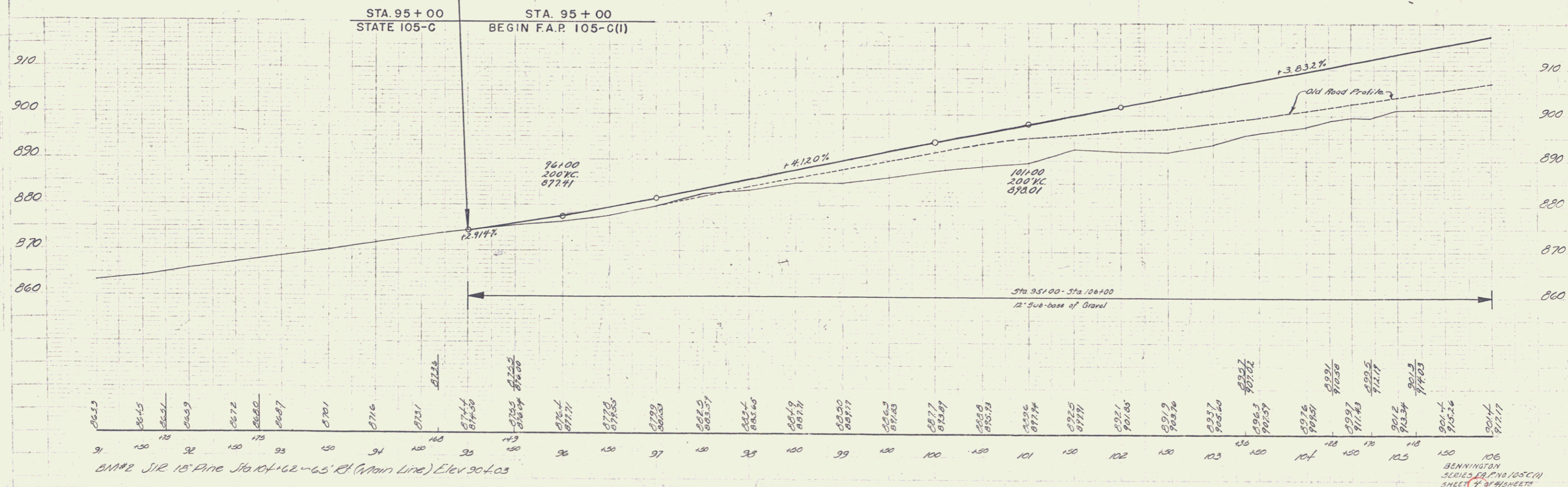

B.M.#2 S.R. 15' Pine Sta. 104+62-65' E. (Main Line) Elev. 904.03

BENNINGTON
 SERIES 105-C
 SHEET 4 OF 4

