

FED. ROAD DIST. NO.	STA. I	PLAN. NO.	FISCAL YEAR	SHEET NO.	TOTAL SHEETS
210			1938	2	3

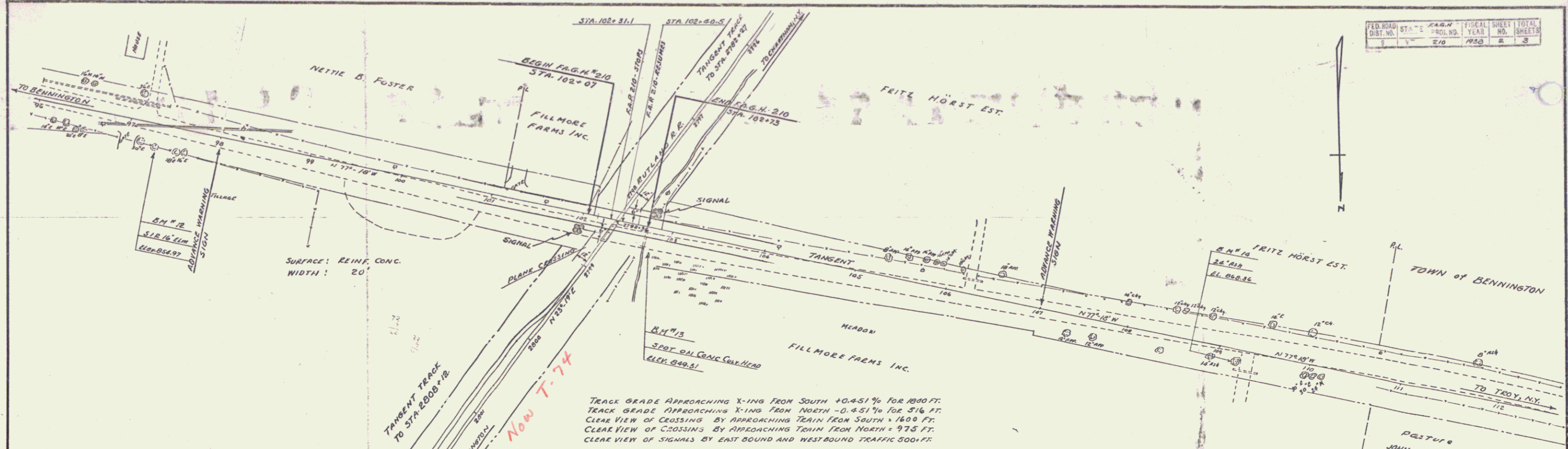

TRACK GRADE APPROACHING X-ING FROM SOUTH +0.451% FOR 1000 FT.
 TRACK GRADE APPROACHING X-ING FROM NORTH -0.451% FOR 516 FT.
 CLEAR VIEW OF CROSSING BY APPROACHING TRAIN FROM SOUTH - 1600 FT.
 CLEAR VIEW OF CROSSING BY APPROACHING TRAIN FROM NORTH - 973 FT.
 CLEAR VIEW OF SIGNALS BY EAST BOUND AND WEST BOUND TRAFFIC 500 FT.

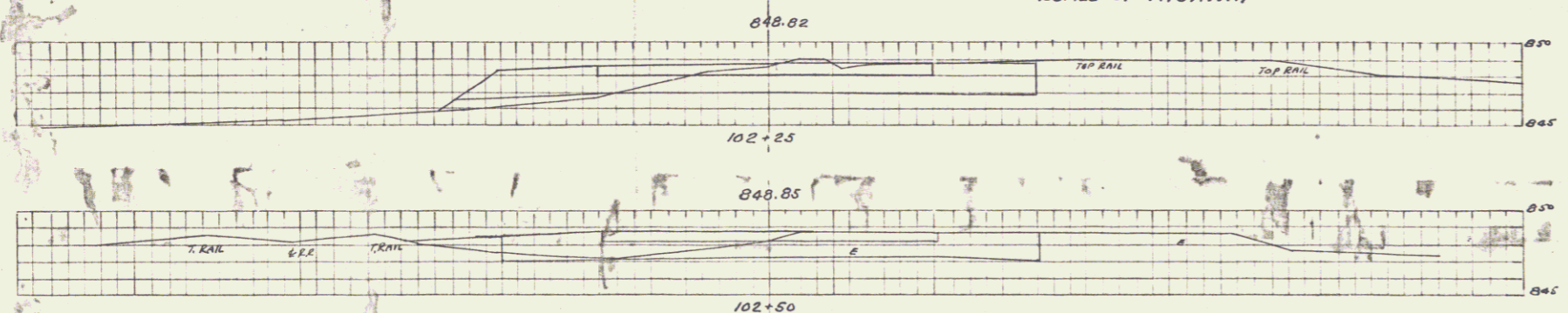
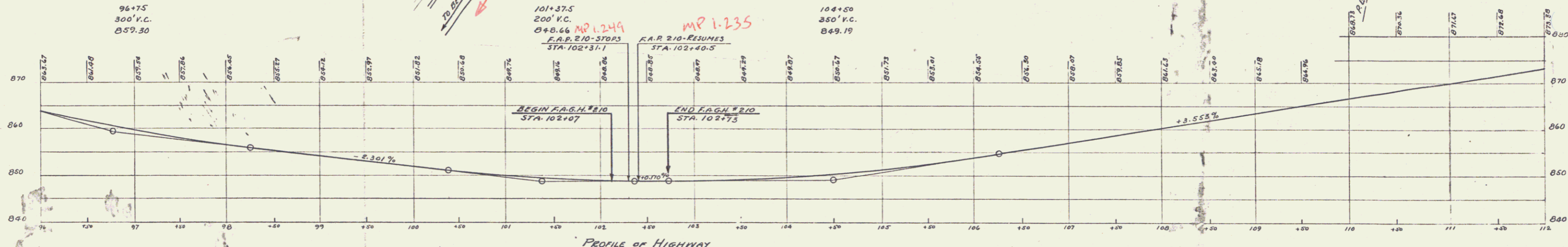

ADVANCED WARNING SIGNS WILL BE ERECTED, IF THEY ARE NOT ALREADY IN PLACE, IN ACCORDANCE WITH "MANUAL ON UNIFORM TRAFFIC CONTROL DEVICES ON STREETS AND HIGHWAYS" (1934)

AUTOMATIC FLASH SIGNAL
GRADE CROSSING AT ANTHONY
 OVER
RUTLAND RAILROAD
 VT. F.A.G.H.-210 - BENNINGTON, VT.
 ROUTE VT. 9 - STA. 102+35.8

ESTIMATED QUANTITIES

REQUIRED: 2 SIGNALS WITH WIRING & WARNING SIGNS	Surveyed by Designed by Drawn by J.M.P. Traced by J.M.P. Checked by Series F.A.G.H. No. 210 Sheet 2 of 3
	8/27/37 8/27/37 Filed