

INDEX OF SHEETS

SHEET NO. 1 TITLE PAGE

- 2 TYPICAL CROSS-SECTION OF IMPROVEMENT
- 3 BANKING & WIDENING TABLES
- 4-11A LAYOUT SHEETS - PLAN & PROFILE
- 12 BRIDGE SUPERSTRUCTURE DETAILS, S.I.B. 20-NO. 25-75; 60 FT SPAN SQUARE ADUT DETAILS
- 13 DETAILS OF ABUTMENT NO. 1 & 2
- 14 SB 20 TYPICAL DETAILS
- 15 SB 5 CABLE GUARD RAIL
- 16 326 PIPE CULVERTS
- 17 530 GUARD RAIL, C.E.M., FED. AID MARKERS
- 18 531 BOUNDARY MARKERS
- 19 5011 BARRICADES, SIGNS & LIGHTS
- 20 540 BARRICADES, SIGNS & LIGHTS
- 21-53 CROSS-SECTIONS

Standard sheet 526 approved by the Chief Engineer on July 16, 1933.

Standard sheet 530 approved by the Chief Engineer on Aug. 15, 1933.

Standard sheet 531 approved by the Chief Engineer on July 25, 1934.

(To Be Returned To R.O.M. Division)

NOESIAID AVN-C-LEHIN

2 1/2" CRUSHED STONE MIXED-W/ PLACK SURFACE COURSE WITH CUT-BACK ASPHALT AND TRAC COAT OF REFINED TAR - ITEMS 210, 211, 212

STATE OF VERMONT
STATE HIGHWAY DEPARTMENT

PLAN AND PROFILE OF PROPOSED
STATE HIGHWAY

FEDERAL AID PROJECT

TOWN OF WILMINGTON Pin# 992803

BRATTLEBORO-BENNINGTON ROAD

BEGINNING AT A POINT 2000 FT. SOUTHEASTERLY FROM TOWN ROAD TO JACKSONVILLE AND RUNNING NORTHWESTERLY 0.576 MILES TO STA. 810+56.4 (BEGINNING OF F.A. PROJECT 63-D) THEN RESUMING AT STA. 821+78 (END OF F.A. PROJECT 63-D) AND CONTINUING NORTHEASTERLY 1.300 MILES TO A CONCRETE ARCH BRIDGE 700 FT. WEST OF WILMINGTON VILLAGE LIMITS.

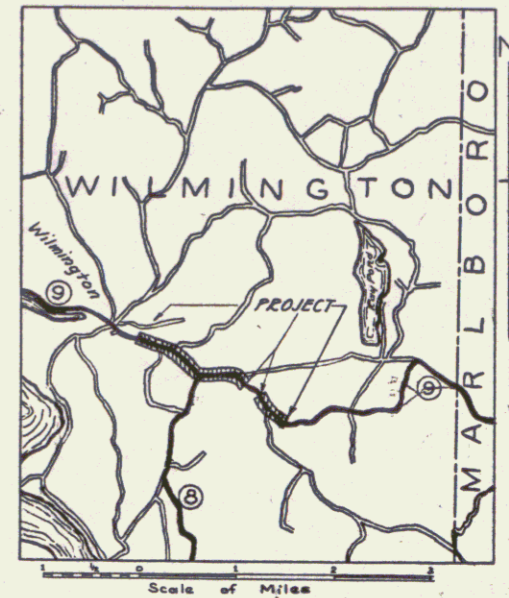

LENGTH OF PROJECT EXCL. BRIDGE OVER 20 FT. SPAN, 9848.8 FEET = 1.865 MILES
LENGTH OF PROJECT INCL. BRIDGE OVER 20 FT. SPAN, 9912.8 FEET = 1.877 MILES

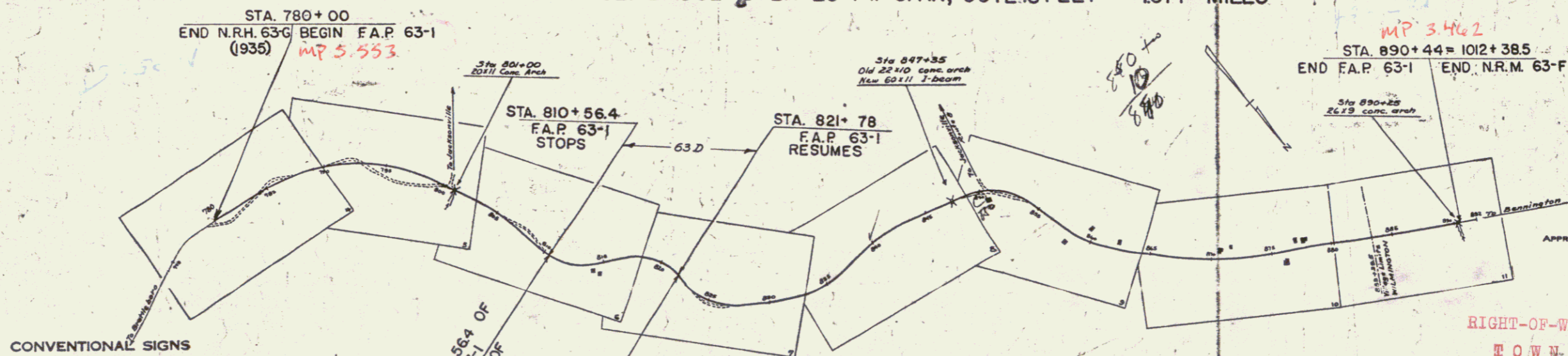

CONVENTIONAL SIGNS

- COUNTY LINE
- TOWN LINE
- FENCE LINE
- STONE WALL
- UNFENCED PROPERTY
- GUARD RAIL
- TRAVELED WAY
- RAILROAD
- RETAINING WALL
- CENTER LINE
- SURVEY LINE
- CULVERT
- DROP INLET
- TROLLEY POLE
- POWER POLE
- TELEPHONE POLE
- TREES
- HEDGE

GROUND ELEVATION

GRADE ELEVATION

CURVE DATA

- DEFLECTION ANGLE
- DEGREE OF CURVE
- RADIUS OF CURVE
- TANGENT DISTANCE
- LENGTH OF CURVE
- EXTERNAL DISTANCE
- POINT OF INTERSECTION
- POINT OF CURVE
- POINT OF TANGENT
- POINT ON TANGENT

SCALES

TITLE 1 IN = 500 FT

PLAN 1 IN = 30 FT

PROFILE HOE. 1 IN = 30 FT

VERT 1 IN = 10 FT

SECTIONS HOE. 1 IN = 5 FT

VERT 1 IN = 5 FT

These plans are subject to such revisions as may be required by the Bureau of Public Roads or the Commissioner of Highways.

Construction is to be carried on in accordance with the plans and standard road and bridge specifications of 1930 including all subsequent approved revisions and such revised specifications and special provisions as are submitted with the plans.

MP 3.462

STA. 890+44 = 1012+38.5

END F.A.P. 63-1 END N.R.M. 63-F

APPROVED: APRIL 15 1935

A. H. Lamm
COMMISSIONER OF HIGHWAYS

SUBMITTED BY ORDER OF THE STATE HIGHWAY BOARD

RIGHT-OF-WAY DIVISION
TOWN FILE

PERPETUAL
Route VT 9
Town of VT 9
(To Be Returned To R.O.)

RECOMMENDED

RECOMMENDED FOR APPROVAL

APPROVED

DIRECTOR - BUREAU OF PUBLIC ROADS

CORRECT: APRIL 15 1935

A. H. Lamm
ROAD ENGINEER

SERIES F. NO. 63-1 FILED
SHEET 1 OF 53

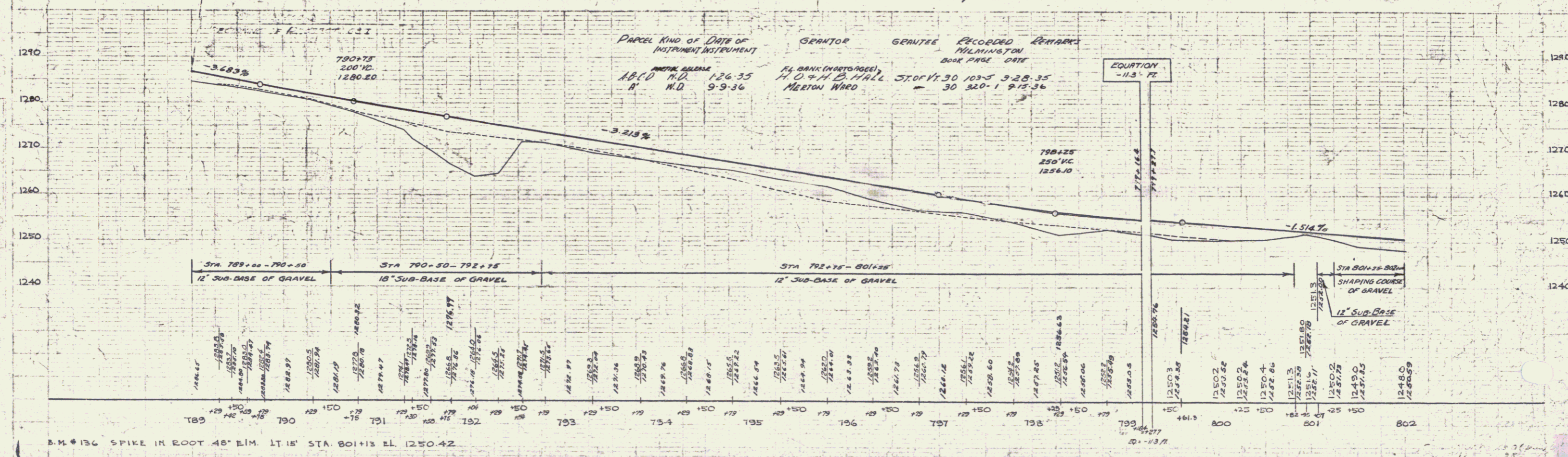
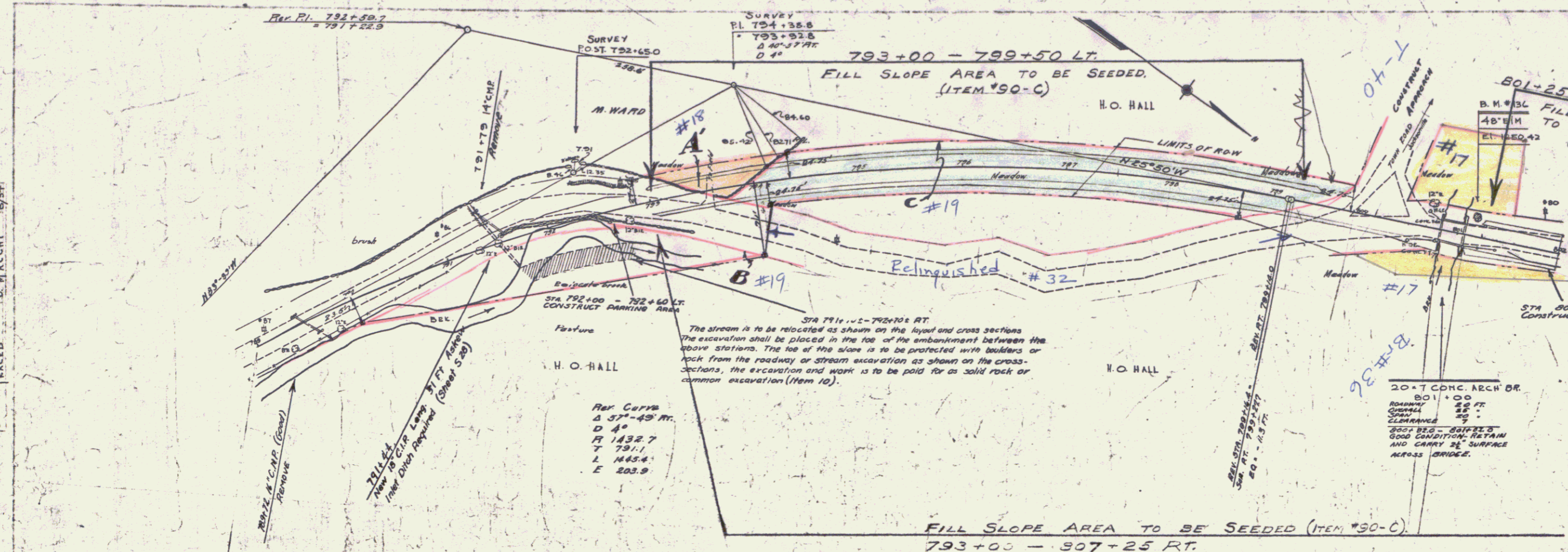

PARCEL	KIND OF INSTRUMENT	DATE OF INSTRUMENT	GRANTOR	GRANTEE	RECORDED	REMARKS
ABCD	M.D.	126-35	H.O. & H.B. HALL	ST. OF Vt. 30	103-5	3-28-35
A	M.D.	9-9-36	MERTON WARD	30	320-1	9-15-36

PUTINAM 8/24
B. MACCHI 8/24

PUTINAM 8/24
B. MACCHI 8/24

B.M. #136 SPIKE IN ROOT 48" LIM. 11' STA. 801+13 EL. 1250.42

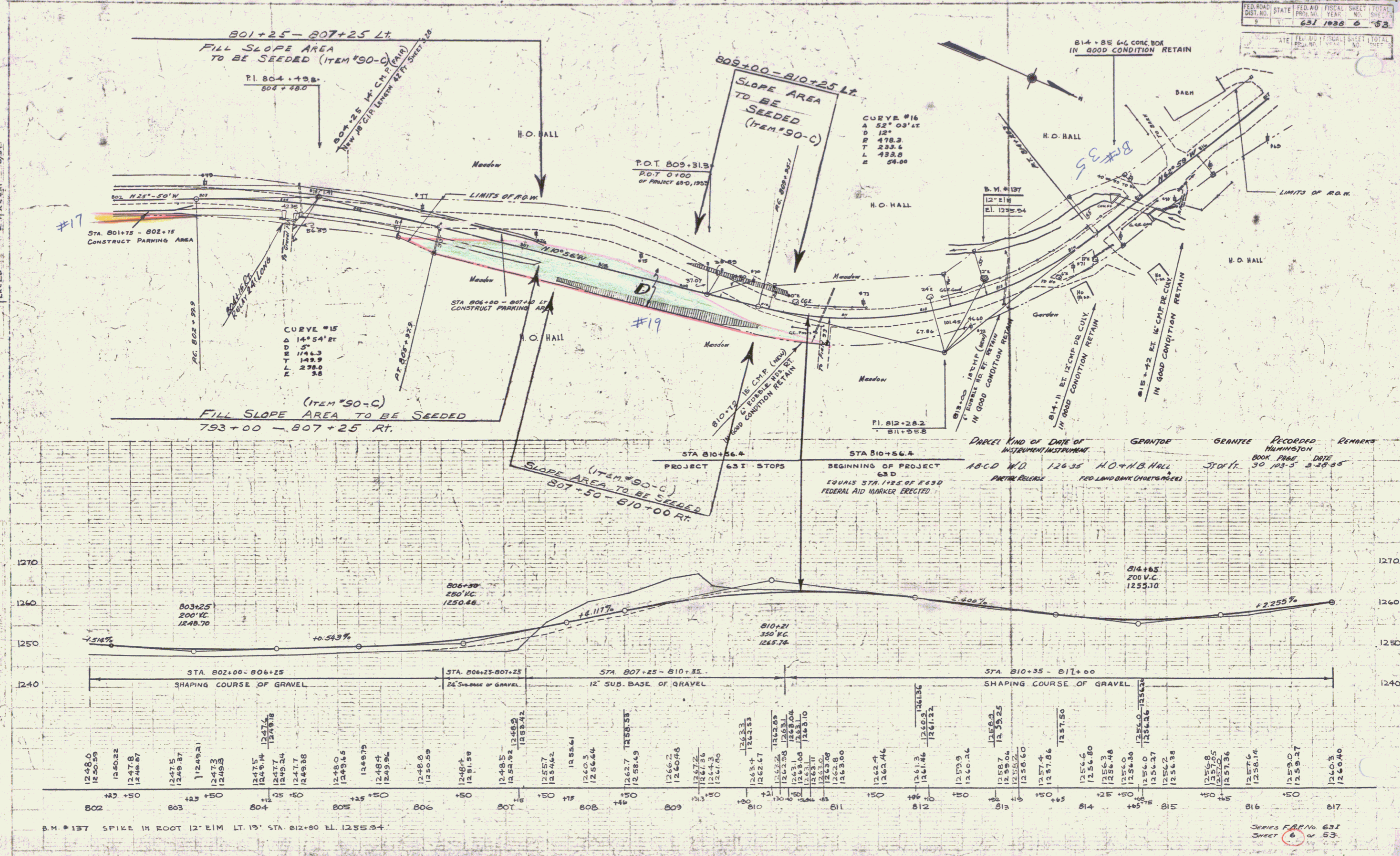

POTNAM
 D. WILSON
 8/24
 8/24

POTNAM
 D. WILSON
 8/24
 8/24

B.M. #137 SPIKE IN ROOT 12" ELM LT. 19' STA. 812+80 EL. 1255.34

SERIES F.P.R. No. 631
 SHEET 6 OF 53
 4

FED. ROAD DIST. NO.	STATE	FED. AID PROJ. NO.	FISCAL YEAR	SHEET NO.	TOTAL SHEETS
3	VT	651 (1938)	7	53	

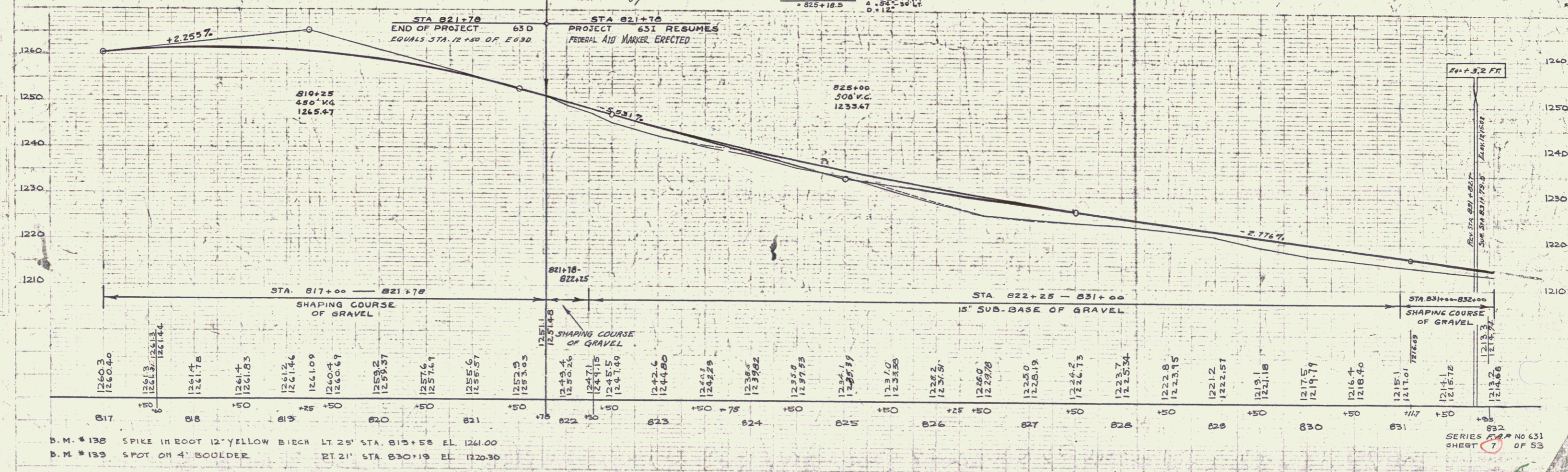
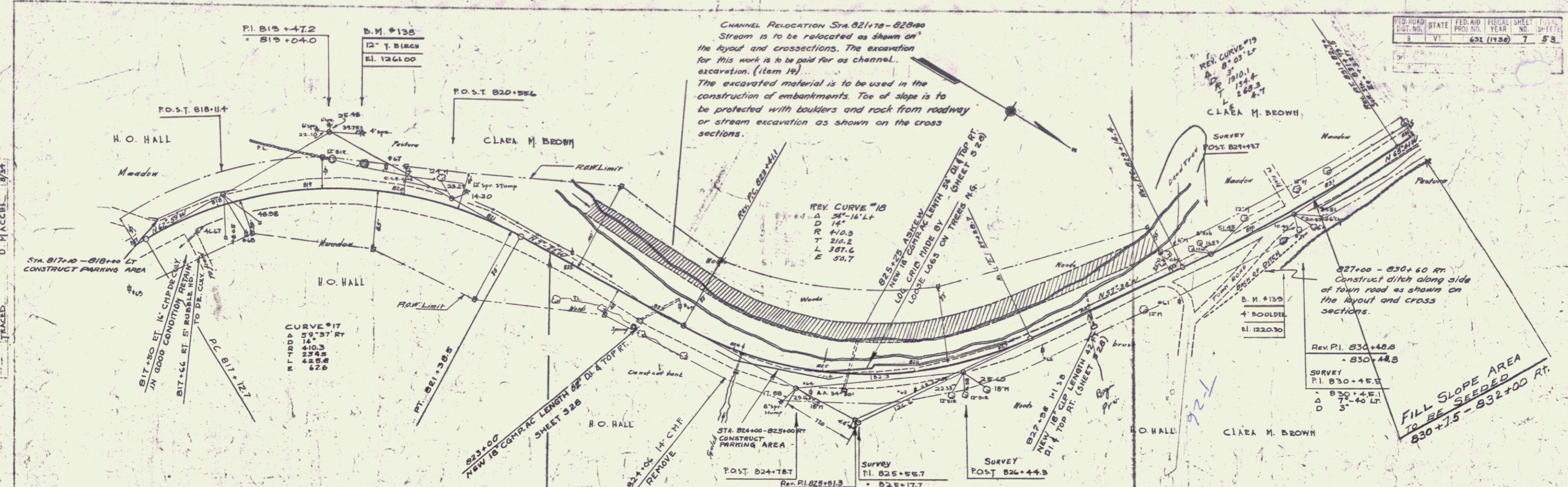

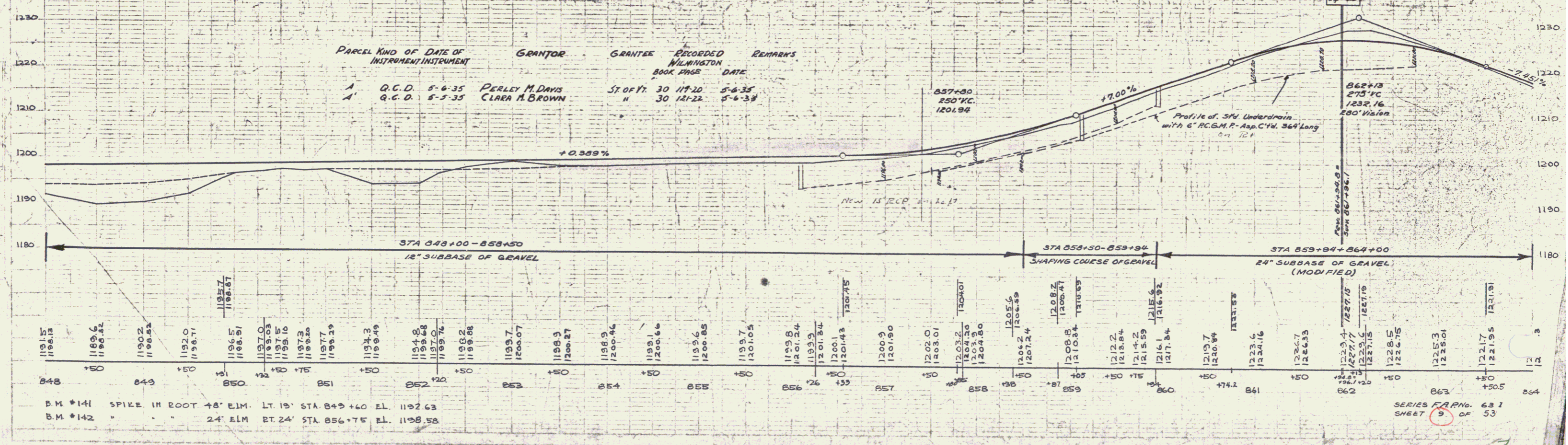
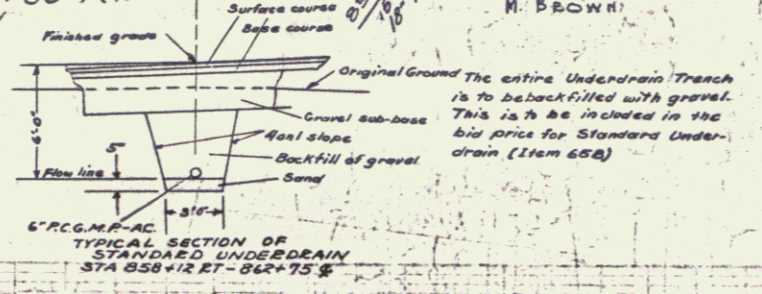
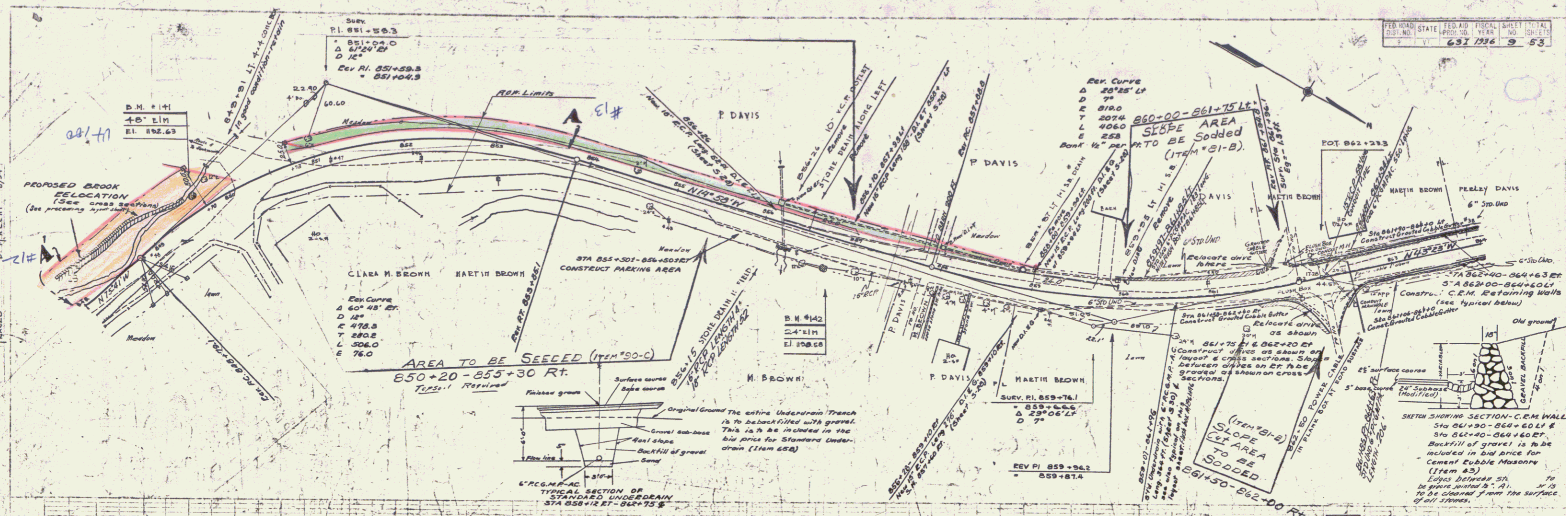

B.M. #141 SPIKE IN ROOT +8' ELM. LT 15' STA 849+40 EL. 1192.63
 B.M. #142 24' ELM. RT 24' STA 856+75 EL. 1198.58

SERIES 7A PNO. 631 OF 53 SHEET 9

DESIGNED BY
 D. MACCHI 8/34

DESIGNED BY
 D. MACCHI 8/34

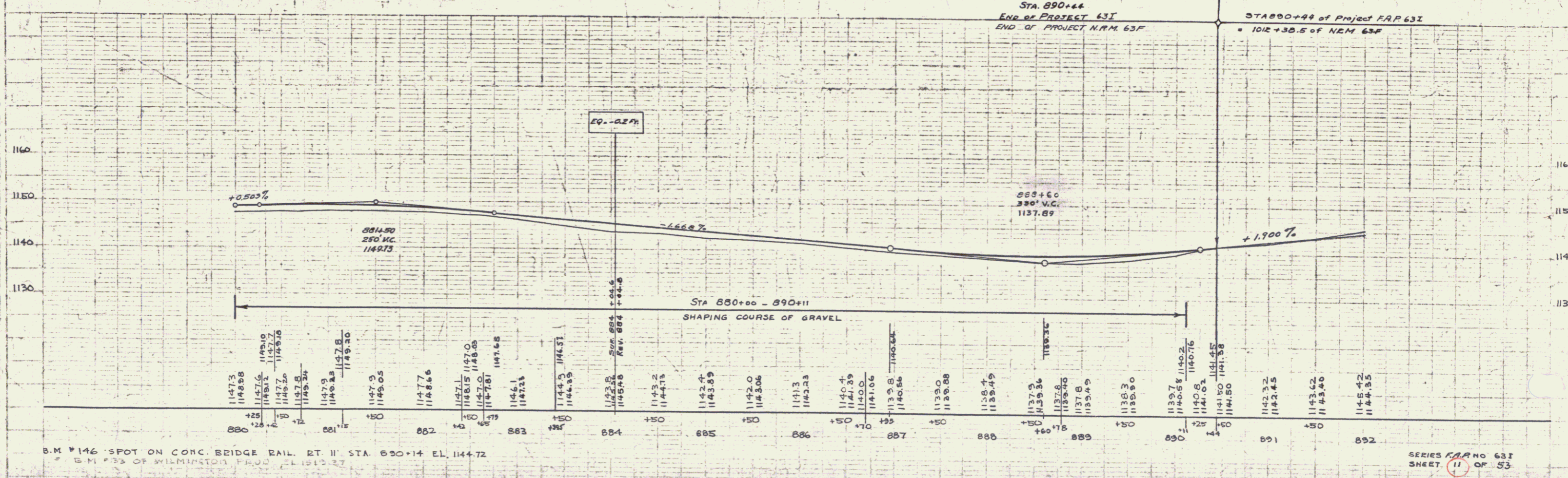
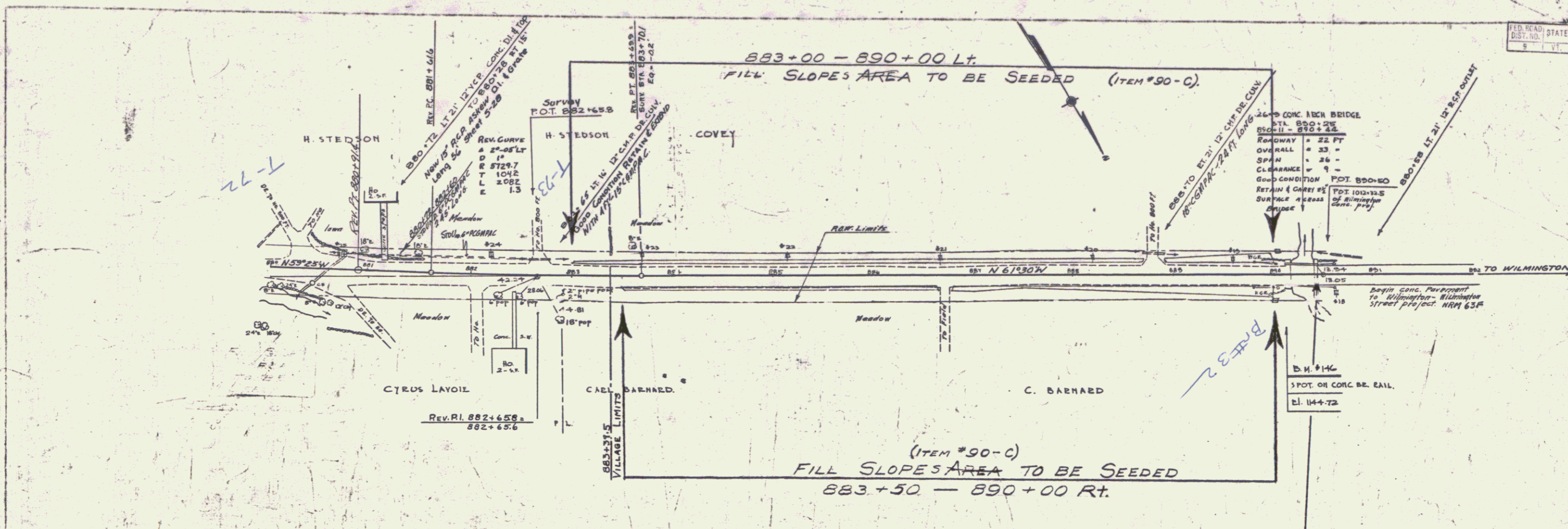

B.M. #146 SPOT ON CONC. BRIDGE RAIL RT. II STA. 890+14 EL. 1144.72
 B.M. #33 OF WILMINGTON PROJ. 11 1913-37

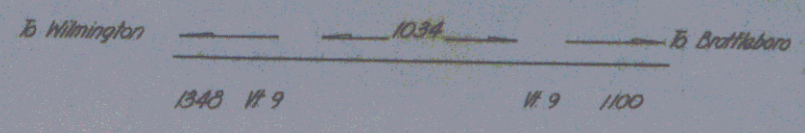

TURNING MOVEMENT
1949 - 24 Hour Annual Average Traffic
Jct. W 9 & W 8
Wilmington



PARCEL	# 1, A, B, & C
INSTRUMENT	W.D.O.C.
DATE	11-10-49
GRANTOR	MARTIN A. BROWN, Sr.
GRANTEE	ST OF VT.
RECORDED BOOK	WILMINGTON
PAGE	33
DATE	295-296
REMARKS	11-23-49 # 1 ON SHEET 29

WOOD GROWTH	PLANT	AMOUNT
1.50	1	1
3.00	1	1
3.00	1	1
3.00	1	1

NOTE: STA. 0+90-12+00
All Row Slopes To Be Seeded
Item 61

ESTIMATED QUANTITIES

WILMINGTON-WHITINGHAM

Served to Spaulding
Designed by
Drawn by
Checked by
Series S No. 160(3) Item
Sheet 27 of 128 Sheets

Sheet 118

VT 100 x 9