

BRIDGE DATA	
	PROPOSED
TYPE	1.5M CON. TL
SPANS (CLEAR)	90'
CLEAR HEIGHT	9.5'
WATER WAY	111.1'
LENGTH OVERALL	84'
ROADWAY WIDTH	32' x 4.5W

PARCEL	INTRUMENT	DATE	GRANTOR	GRANTEE	RECORDED	REMARKS
A	Q.C.D.	2-26-39	HARRY E. ELIZABETH COVEY	ST. W.	BOOK 31	PAGE 245 2-26-39
A	Q.C.D.	4-27-39	THE DOVER LUMBER CO.	ST. W.	31	13-4 5-3-39

BORING DATA

Station	Soil Description
1136.5	1/2 in. Sand & Fill
1130.5	Gravel & Boulders
1128.5	1129.6 Sand & Cobbles
	1123.6 Gravel & Sand
	1124.6 Gravel & Sand
	1122.1 Gravel & Boulders

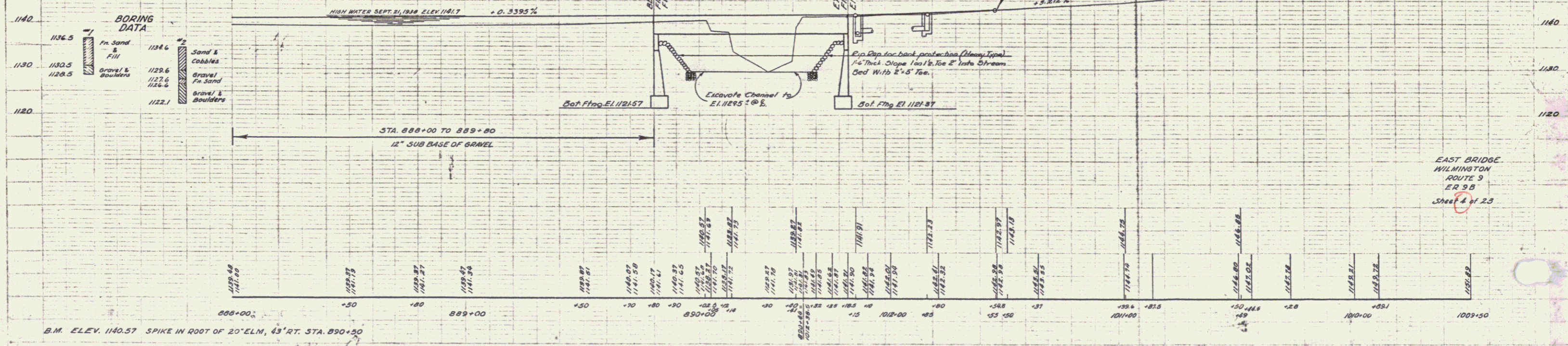

B.M. ELEV. 1140.57 SPIKE IN ROOT OF 20' ELM. 43' RT. STA. 890+50

EAST BRIDGE
WILMINGTON
ROUTE 9
ER 9 B
Sheet 2 of 23