

FAP 105E

STATION	STATION	EL.	LT.
767+00	768+00	1590.00	1
768+00	769+00	1590.00	1
769+00	770+00	1590.00	1
770+00	771+00	1590.00	1
771+00	772+00	1590.00	1
772+00	773+00	1590.00	1
773+00	774+00	1590.00	1
774+00	775+00	1590.00	1
775+00	776+00	1590.00	1
776+00	777+00	1590.00	1
777+00	778+00	1590.00	1
778+00	779+00	1590.00	1
779+00	780+00	1590.00	1
780+00	781+00	1590.00	1
781+00	782+00	1590.00	1
782+00	783+00	1590.00	1

Feb 10
105-I 1936 4A 25'
105 E 1936 6 B

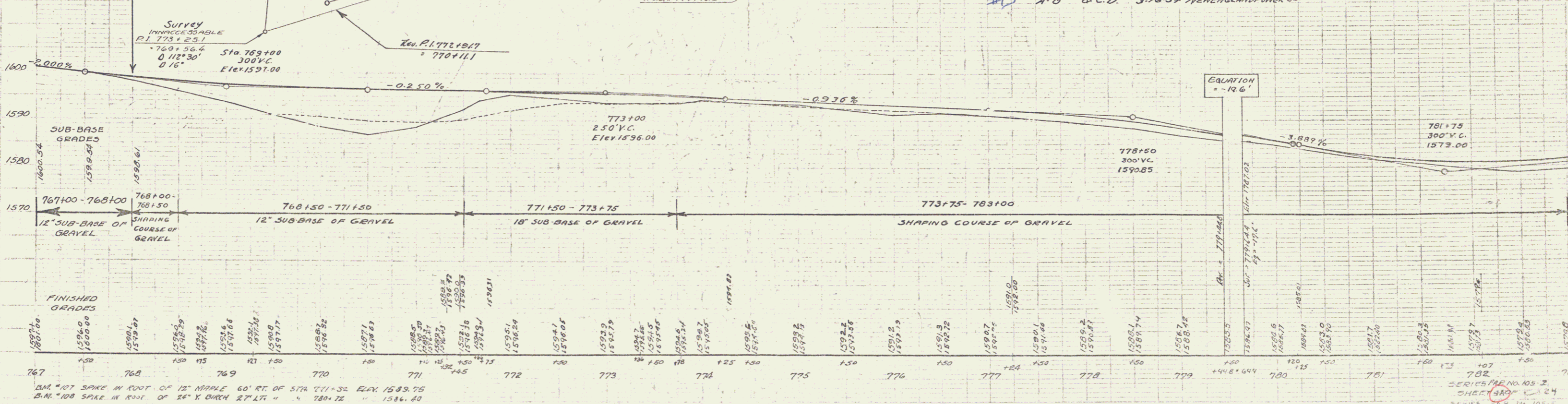
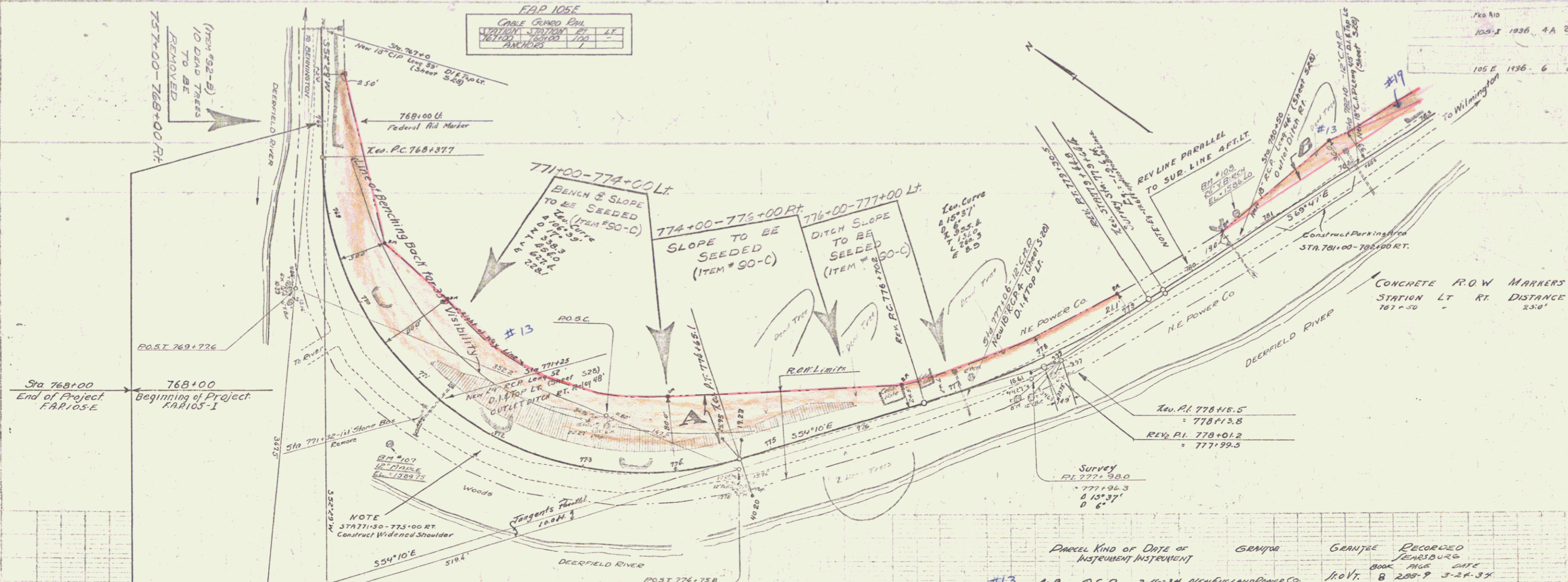

BM #107 SPIKE IN ROOT OF 12" MAPLE 60' RT. OF STA. 771+32 ELEV. 1589.75
 BM #108 SPIKE IN ROOT OF 24" X BURN 27' LT. " " 780+72 " 1586.49

DEERFIELD RIVER
 TANGENTS POINT 100' N
 NEW 12" CURVE
 DEERFIELD RIVER
 NE POWER CO.
 CONCRETE PAVING STA. 781+00-783+00 RT.
 EQUATION = -12.6'
 GRADES
 SUB-BASE GRADES
 FINISHED GRADES