

GUIDE POSTS OF WOOD		CABLE GUARD RAIL			
STATION	LEFT	STATION	LEN	LENGTH	CONST. PAVING
525+00	1	522+35	17.87	36	80 178
527+21	1	527+21	17	24	40 64
529+00	1				
531+50	1				

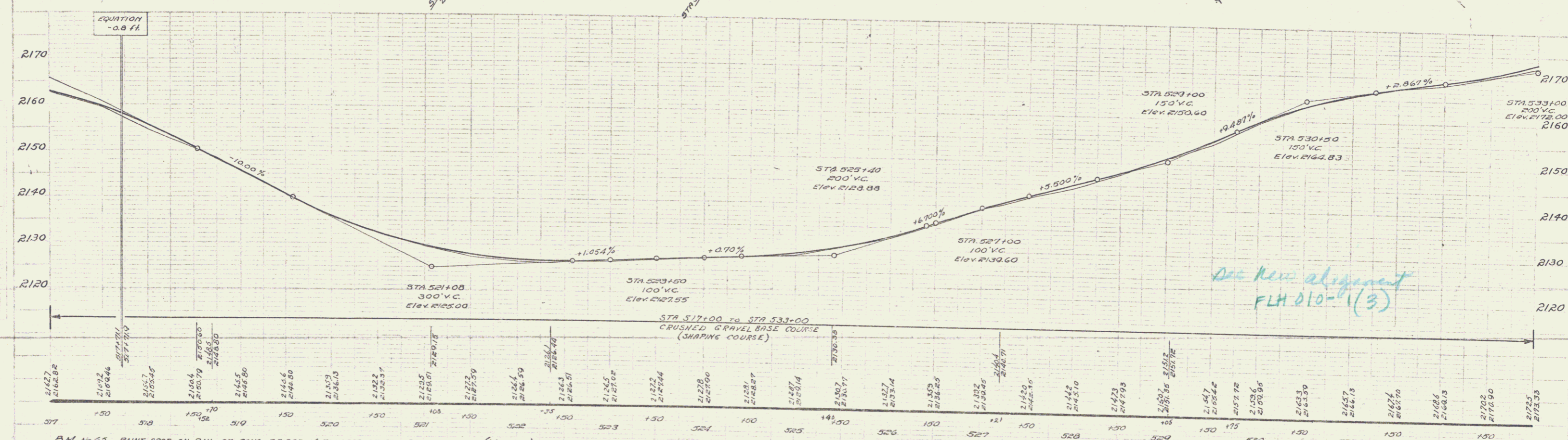
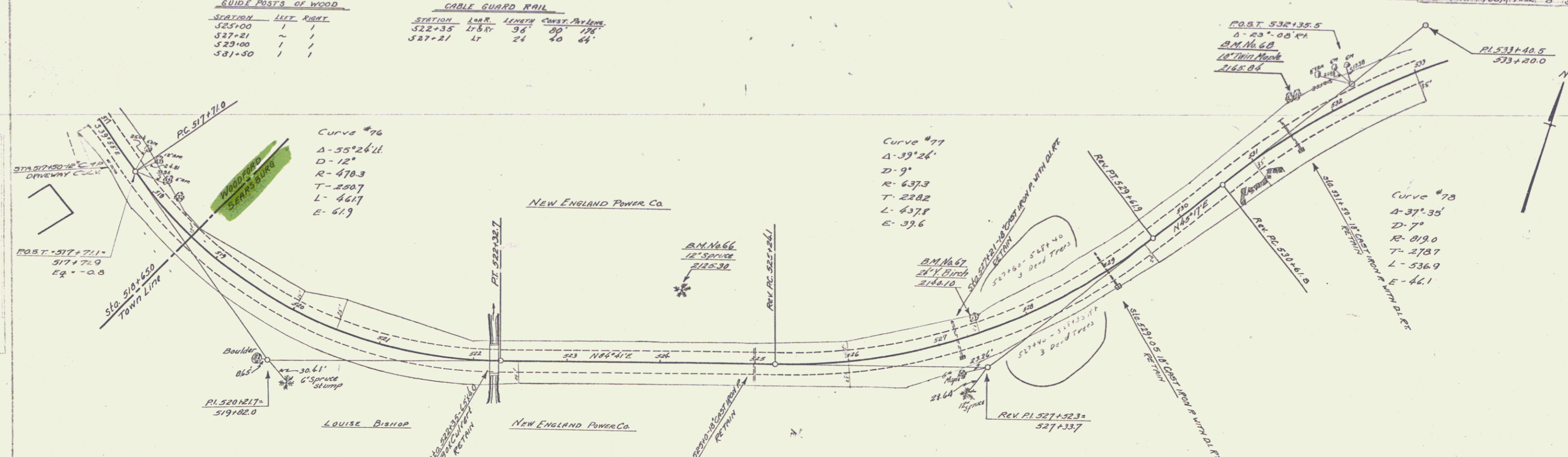

B.M. No. 65 PAINT SPOT ON RAIL OF CONC. BRIDGE 6 FT. LEFT OF STA 524+25 ELEV. (MISSING)
 B.M. No. 66 SPIKE IN ROOT OF 12" SPRUCE 80 FT. LEFT OF STA 524+25 ELEV. 2129.30
 B.M. No. 67 SPIKE IN ROOT OF 24" YELLOW BIRCH 10 FT. LEFT OF STA 527+43 ELEV. 2140.10
 B.M. No. 68 SPIKE IN TRUNK OF 18" TWIN MAPLE 29 FT. LEFT OF STA 531+72 ELEV. 2165.84