

#13 Leland P. & Pauline H. Beebe
(A.O. 131) STA 484+90 - 485+52.1
COND 11/12/58
RECORDED: DORSET - BK 43 - PG 373 - 11/14/58

#14 Roy E. & Anna A. Wilbur
(A.O. 332) STA 485+47 - 486+96.2
COND 11/12/58
RECORDED: DORSET - BK 43 - PG 373 - 11/14/58

#15 Frank V. Jr. & Mary A. Read
(A.O. 332) STA 488+79 - 489+81
COND 11/12/58
RECORDED: DORSET - BK 43 - PG 373 - 11/14/58

#16 Lester K. & Marjorie W. Roberts
(A.O. 11) STA 488+15 - 488+84.2
COND 11/12/58
RECORDED: DORSET - BK 43 - PG 373 - 11/14/58

TABLE OF BRIDGE QUANTITIES

| ITEM NO. | ITEM | UNIT | NET | OVER | TOTAL | FINAL |
|----------|-----------------------------------|------|---------|------|---------|---------|
| 106-C | Unclassified Channel Excavation | c.y. | 279.4 | 279 | 3073 | 2978 |
| 107 | Structure Excavation | c.y. | 20 | 2 | 44 | 44 |
| 561-B | Bituminous Concrete | tons | 77 | 12 | 89 | 89 |
| 401-B | Concrete Class B (Mod) | c.y. | 376 | 19 | 395 | 384 |
| 402 | Reinforcing Steel | lb. | 45,356 | - | 45,356 | 44,947 |
| 403 | Spiral Reinforcement (3070#) | l.s. | 1 | - | 1 | 1 |
| 404A | Structural Steel | lb. | 115,925 | 2320 | 119,245 | 115,065 |
| 407 | Asphalt-Asbestos Coating | s.y. | 12 | - | 12 | 0 |
| 501 | Furn. Equip. for Driving Piles | l.s. | 1 | - | 1 | 1/2 |
| 502-B | Treated Timber Piling | l.f. | 2100 | - | 2100 | 2172 |
| 521 | Stone Fill (Heavy Type) | c.y. | 880 | 88 | 968 | 880 |
| 556-C | Granite Bridge Curb | l.f. | 180 | - | 180 | 180 |
| 572 | Bridge Railing | l.f. | 138 | - | 138 | 138 |
| 522 | Stone Fill (for Slope Protection) | c.y. | - | - | - | 184 |

LIST OF BRIDGE SHEETS

| SHEET NO. | DESCRIPTION |
|-----------|---|
| 25 | Preliminary Information Sheet |
| 14A | Plan (20 Scale) |
| 26 | Earthwork Sheet |
| 28 | Details of Abutments |
| 27 | Superstructure & Approach Slab Details |
| 27 | Reinforcing Steel Schedule |
| 3435 | Std. Dwg. SCB 42-5B (Mod. for 44' Rdwy) |
| 33 | Std. Dwg. SB - 20-56 |
| 3637 | Std. Dwg. SB - 56-57 |
| 39 | Std. Dwg. SB A3 30° Skew-57 (Mod. for 44' Rdwy) |
| 134-136 | Channel Sections |

Construct Drives
L.F.
485+60 - 485+90 - 486+90
486+45 - 486+75 - 486+75

Bituminous Concrete Curb
L.F.
485+50 - 485+60
485+90 - 486+45
486+75 - 486+80

Three Cable Guard Rail with Steel Posts Item 543
L.F.
483+00 - 483+80
483+80 - 483+80
Rt.
485+56 ~ 485+80
486+69 ~ 486+93
486+81 ~ 486+85
486+86 ~ 487+16

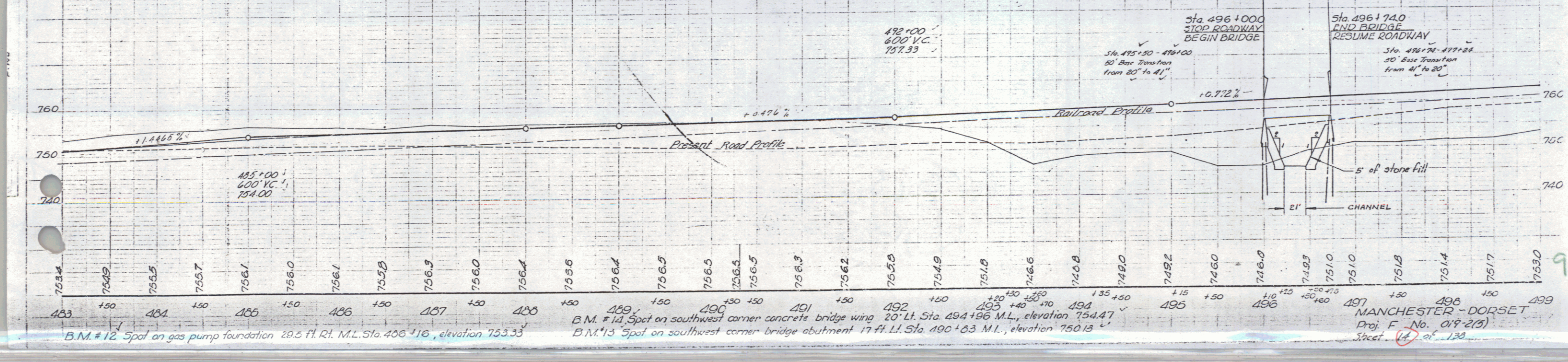

B.M. #12 Spot on gas pump foundation 29.5 ft. R.L. M.L. Sta. 406+16, elevation 753.33

B.M. #14 Spot on southwest corner concrete bridge wing 20' Lt. Sta. 494+96 M.L., elevation 754.47
B.M. #13 Spot on southwest corner bridge abutment 17 ft. Lt. Sta. 490+63 M.L., elevation 750.13

MANCHESTER - DORSET
Proj. F. No. 019-2(3)
Sheet 14 of 138