

on Cross Sections (Sheets 24 & 25, 31 & 32) This work to be paid for as Common Exc. Incl. Burrow, Item 10-11

PARCEL	INSTRUMENT	DATE	GRANTOR	GRANTEE	RECORDED BOOK	RECORDED PAGE	RECORDED DATE	REMARKS
A'	WDOE	7-14-41	HAMILTON HADDEN	ST. OF VT. 41	201	201	7-22-41	CULV. STA. 355 + 65

NOTE: The present road surface (e'l of 342+50 to 357+00) including section of Road Approach Sta 4+00 of A Line is to be removed to a depth of 5' Item 10 This area is then to be covered with approved Bitrow to a depth of 1' Item 10-11 The material removed shall be used in embankments on the project

The work is to be done until the Relocation is open to travel

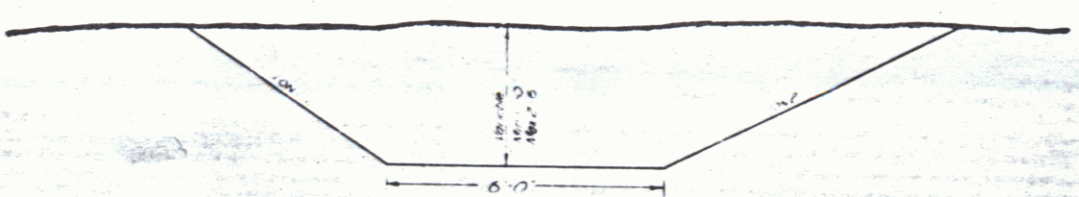

INTERCEPTING DITCH Sta 346+00-351+00 Right - Sta 1+50-6+50 on Base Line  
To be paid for as Common Exc. Incl. Burrow Item 10-11

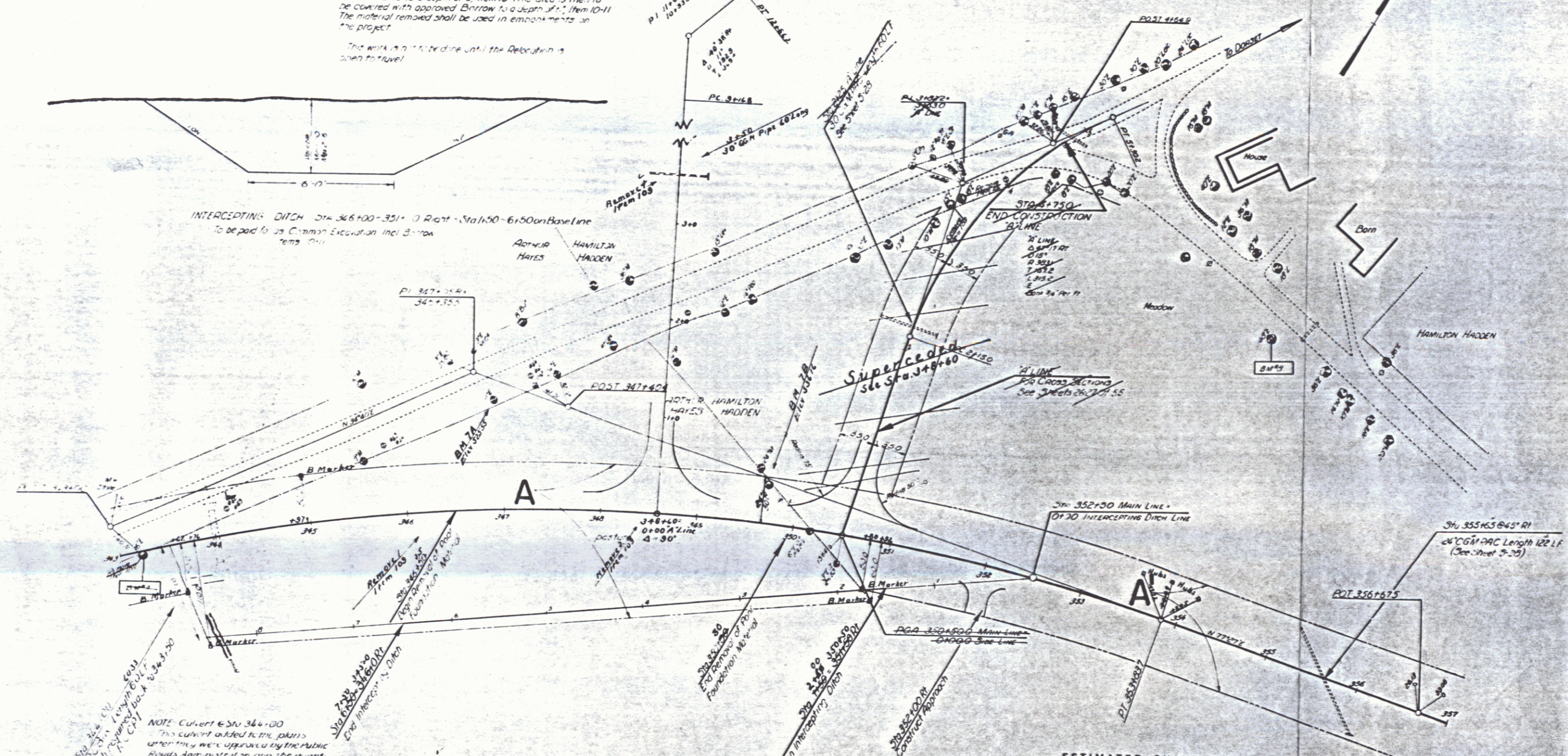

NOTE: Culvert @ Sta 344+00 This culvert added to the plans when they were approved by the public works Administration and the quantities are not included in the plans This to be handled by a change in a.s.g.r. 314c

Δ 42'47" Rt  
D. 3"  
R 190' L  
T 140' L  
L 142' L  
E 141' L

ESTIMATED QUANTITIES	

MANCHESTER

Surveyed by LW Brownell  
Designed by LW Brownell  
Drawn by LW Brownell  
Traced by J.O. Clark  
Checked by  
Series J.N.F.P. No. 52C.1 F. 44  
Sheet 7 of 15 Sheets