

EXCAVATION & REMOVAL OF EXISTING PAVEMENT ITEM 101

STATION	STATION	POS.
1442+75	1444+00	RT
U.S. 2 RELOCATION NO. 10		
62+00	65+50	RT.

FILLS TO BE MADE OF GRANULAR MATERIALS

STATION	STATION
U.S. 2 RELOCATION NO. 10	65+50
67+53	

FOR SUMMARY OF LANDSCAPE MATERIALS SEE SHEET 6 OF 118

DRILLING & BLASTING OF SOLID ROCK SUB GRADE ITEM 114 (MOD)

STATION	STATION
MAINLINE	
1431+00	1440+00
1448+50	1448+00
1435+87	1435+27
1436+85	1436+81
1437+77	1437+10
1437+30	1437+50
1440+77	1444+00

CONTROL OF ACCESS IS COMPLETE ON THIS SHEET

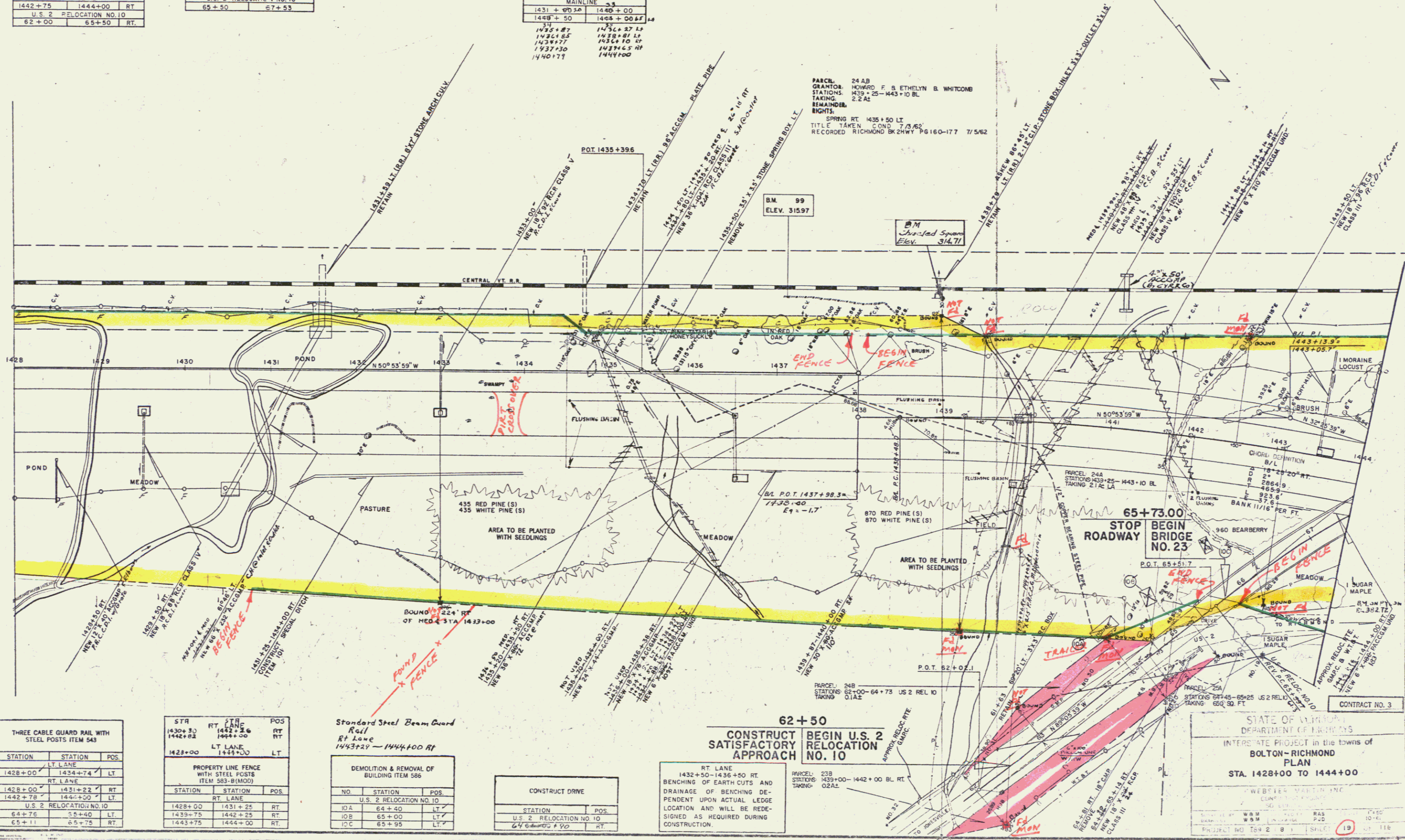

THREE CABLE GUARD RAIL WITH STEEL POSTS ITEM 543

STATION	STATION	POS.
1428+00	1434+74	LT
1428+00	1431+22	RT
1442+78	1444+00	LT
U.S. 2 RELOCATION NO. 10		
64+76	65+40	LT
65+11	65+75	RT

PROPERTY LINE FENCE WITH STEEL POSTS ITEM 583-B(MOD)

STATION	STATION	POS.
1428+00	1431+25	RT
1439+75	1442+25	RT
1443+75	1444+00	RT.

DEMOLITION & REMOVAL OF BUILDING ITEM 586

NO.	STATION	POS.
U.S. 2 RELOCATION NO. 10		
10A	64+40	LT.
10B	65+00	LT.
10C	65+95	LT.

CONSTRUCT DRIVE

STATION	POS.
U.S. 2 RELOCATION NO. 10	
64+00	65+00
64+00	65+00

CONSTRUCT BEGIN U.S. 2 FACTORY APPROACH NO. 10

RT LANE 1432+50-1436+50 RT. BENCHING OF EARTH CUTS AND DRAINAGE OF EARTH CUTS DEPENDENT UPON ACTUAL LEDGE LOCATION AND WILL BE REDESIGNED AS REQUIRED DURING CONSTRUCTION.

62+50 CONSTRUCT BEGIN U.S. 2 FACTORY APPROACH NO. 10

STATE OF VERMONT DEPARTMENT OF TRANSPORTATION INTERSTATE PROJECT IN THE TOWNS OF BOLTON-RICHMOND PLAN STA. 1428+00 TO 1444+00

WEATHERS ENGINEERING INC.

PROJECT NO. 159 2 8 19

cast + Bow 21