

1354+37	1358+93	LT.
1359+43	1360+70	RT.

THREE CABLE GUARD RAIL WITH STEEL POSTS ITEM 543		
STATION	STATION	POS.
1352+00	1362+77	LT.
		RT. LANE
1355+32	1361+75	RT.

CONSTRUCT DRIVE (FARM ACCESS)		
SEE SHEET 135 OF 328		
STATION	STATION	POS.
1357+63		LT.
1357+83		RT.

Use by Permit only  
Settlement Report 7/4/16 - Atty Frank  
approved by Asst. Atty. Gen. Peck  
State has fee ownership - State here has  
the right to deny to the wheelers the  
use of these access point today if it  
desires to do so, with or without cause

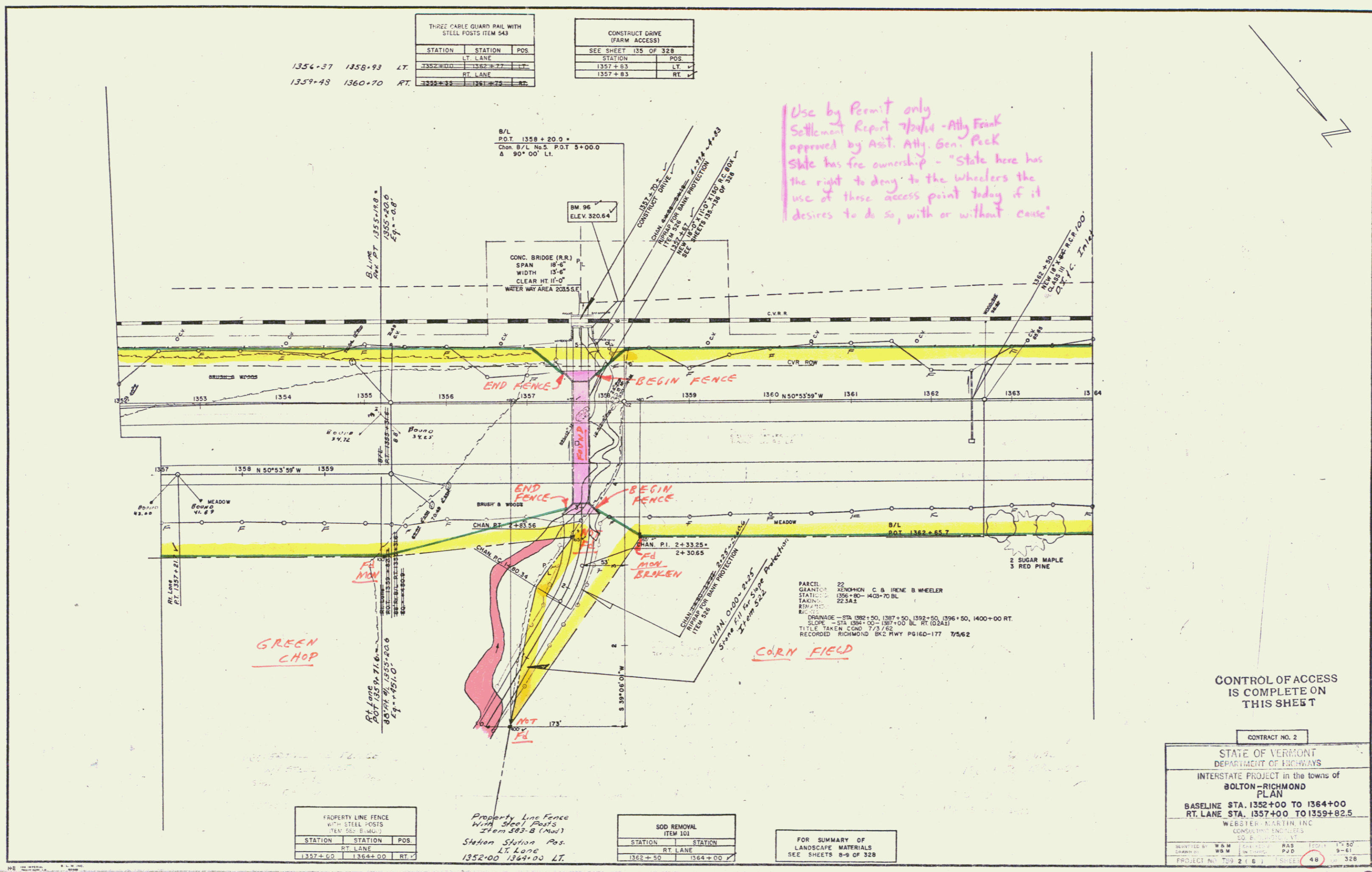

GREEN CHOP

CORN FIELD

PROPERTY LINE FENCE WITH STEEL POSTS (ITEM 543-B (Mod))		
STATION	STATION	POS.
1357+00	1364+00	RT.

Property Line Fence With Steel Posts (Item 543-B (Mod)) Station Station Pos. LT. Lane 1352+00 1364+00 LT.

SOD REMOVAL ITEM 101		
STATION	STATION	
		RT. LANE
1362+50	1364+00	

FOR SUMMARY OF LANDSCAPE MATERIALS SEE SHEETS 8-9 OF 328

CONTROL OF ACCESS IS COMPLETE ON THIS SHEET

CONTRACT NO. 2

STATE OF VERMONT  
DEPARTMENT OF HIGHWAYS

INTERSTATE PROJECT in the towns of  
**BOLTON-RICHMOND**  
PLAN

BASELINE STA. 1352+00 TO 1364+00  
RT. LANE STA. 1357+00 TO 1359+82.5

WEBSTER MARTIN INC  
CONSULTING ENGINEERS  
100 B. STATE ST.  
ST. ALBANS, VT 05478

SUBMITTED BY: W & M  
CHECKED BY: W & M  
DESIGNED BY: RAS  
DATE: 11/15/16  
PROJECT NO: T09 2 (16)  
SHEET 48 OF 328

Const + Rd  
16