

PART OF THE LAND ACQUIRED BY THE STATE OF VERMONT FROM RUSSELL G. HALLOCK & RACHEL L. HALLOCK BY W.D. DATED APR. 25, 1957 & RECORDED IN BK. 20, PG. 449 OF THE TOWN OF BOLTON LAND RECORDS.

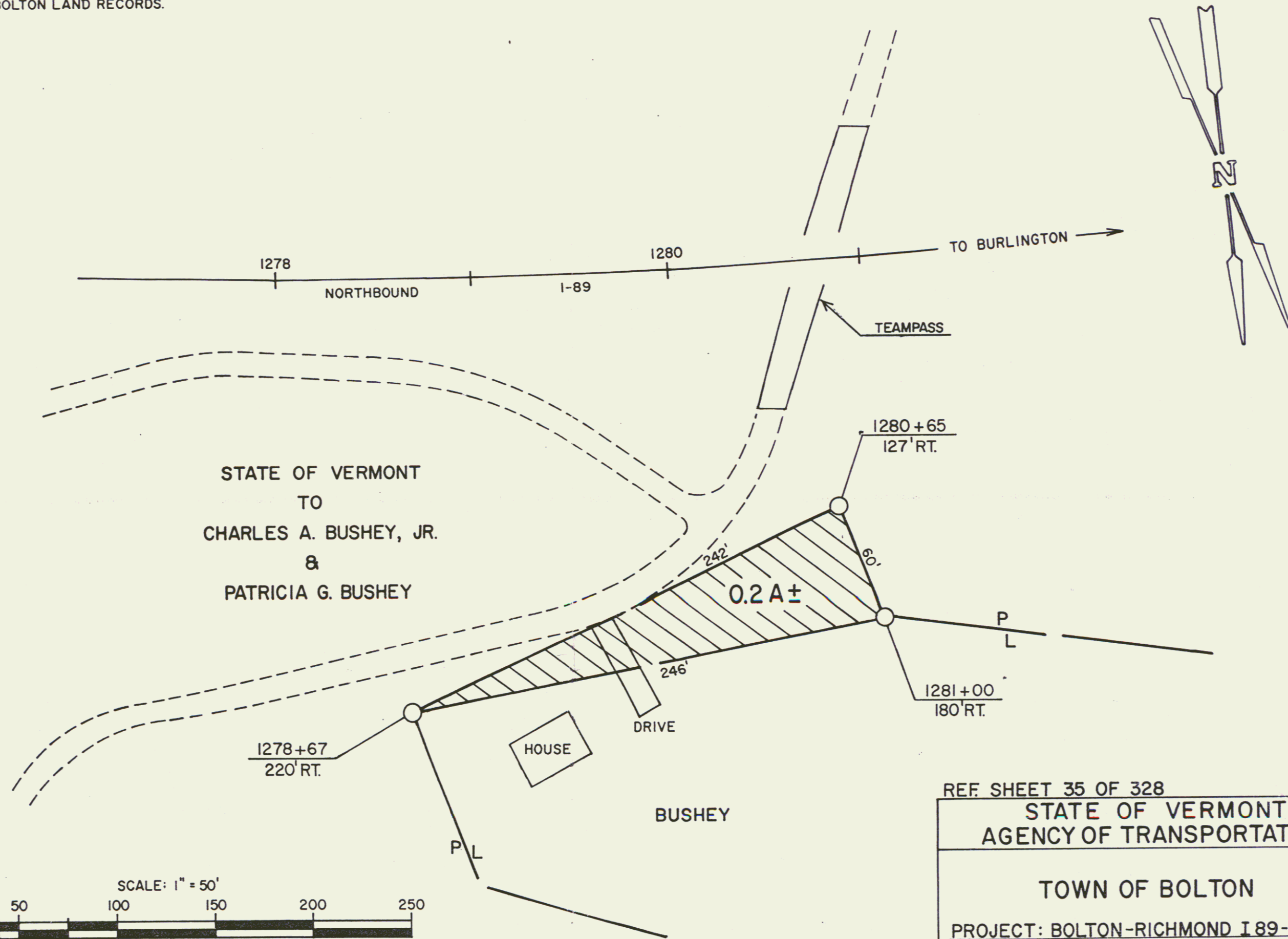

STATE OF VERMONT
TO
CHARLES A. BUSHEY, JR.
&
PATRICIA G. BUSHEY

BUSHEY

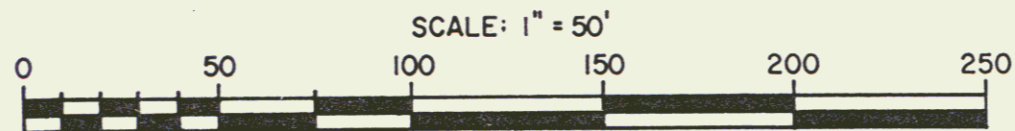

REF. SHEET 35 OF 328		
STATE OF VERMONT AGENCY OF TRANSPORTATION		
TOWN OF BOLTON (35B)		
PROJECT: BOLTON-RICHMOND I 89-2 (8)		
APPROX SCALE 1" = 50'	DATE 3-7-84	DRAWN BY D.E.M.