

EXCAVATION & REMOVAL OF EXISTING PAVEMENT ITEM 101				EXCAVATION & REMOVAL OF LANE TRANSITION ITEM 101 SEE SPECIAL PROVISION NO.				SOD REMOVAL ITEM 101				THREE CABLE GUARD RAIL WITH STEEL POSTS ITEM 543				REMOVAL & DISPOSAL OF PRESENT GUARD RAIL ITEM 510				PROPERTY LINE FENCE ITEM 585-B (MOD) W/STEEL POSTS				EXCAVATION & REMOVAL OF ROAD SURFACE ON ROADWAYS ITEM 116-A				PLANK GUARD RAIL WITH PRESERVATIVE TREATMENT ITEM 541-A (BARRICADE)				EXCAVATION & REMOVAL OF TEMPORARY APPROACH ITEM 101 SEE SPECIAL PROVISION NO.																							
LOCA	STA	STA	POS	LOCA	STA	STA	POS	LOCA	STA	STA	POS	LOCA	STA	STA	POS	LOCA	STA	STA	POS	LOCA	STA	STA	POS	LOCA	STA	STA	POS	LOCA	STA	STA	POS	LOCA	STA	STA	POS																				
U.S. 2-8	16+50	22+00		RT LANE	1187+50	1192+00	LT	U.S. 2-8	19+50	22+50		LT LANE	1181+75	1194+25	LT	LT LANE	1200+00	1201+46	LT	LT LANE	1200+00	1203+88	LT	U.S. 2-8	22+00	26+40		U.S. 2-8	24+65	28+40		RT LANE	1191+00	1202+50	LT																				

INDICATES PROPERTY OWNER PLOT NUMBER.

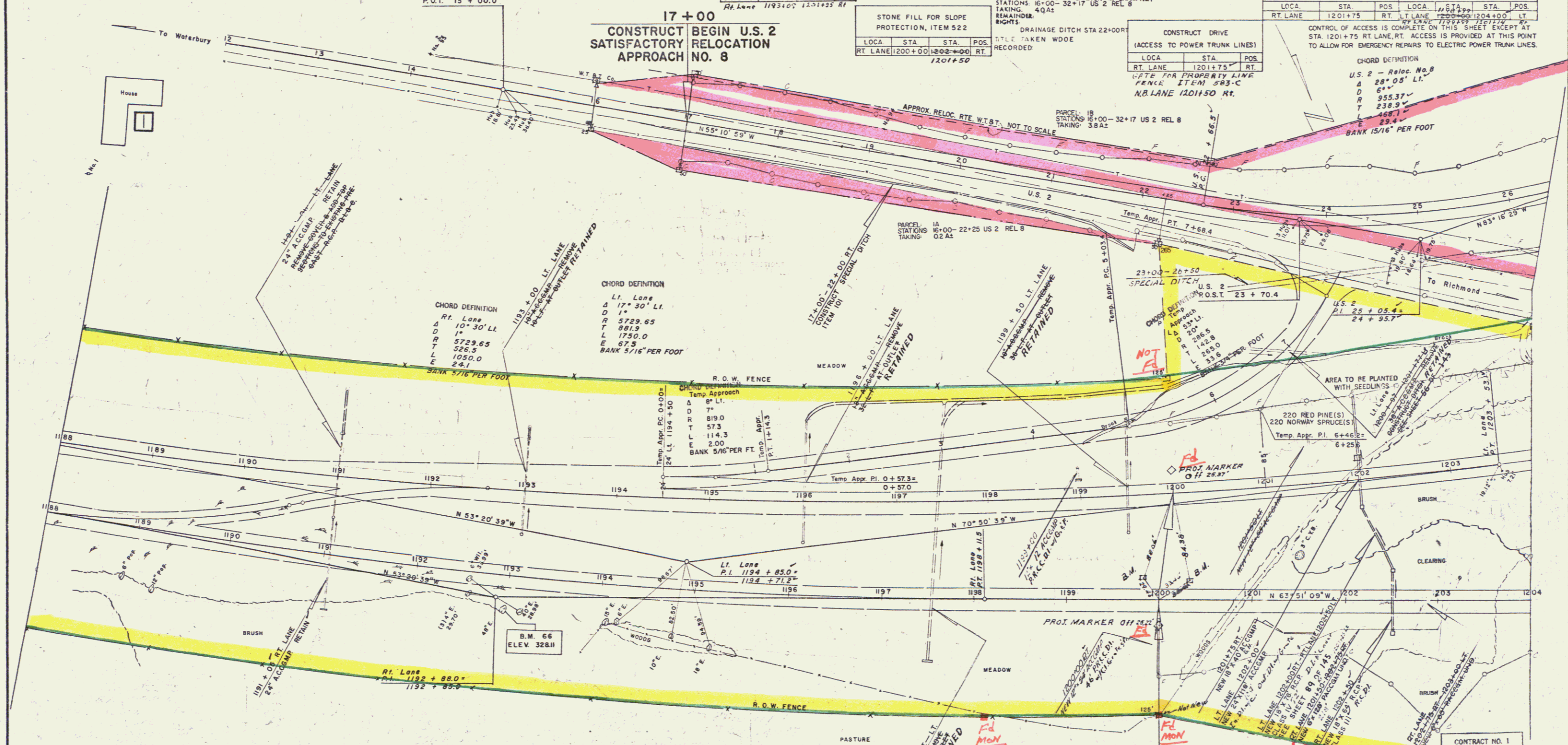

LOCA	STA	STA	POS
RT LANE	1202+50	1204+00	