

TYPE B

# STATE HIGHWAY DEPARTMENT

## PLAN AND PROFILE OF PROPOSED STATE HIGHWAY

FEDERAL AID PROJECT

TOWNS OF

### MANCHESTER, SUNDERLAND AND ARLINGTON

### MANCHESTER-BENNINGTON ROAD

FROM THE CONCRETE PAVEMENT IN MANCHESTER VILLAGE SOUTHERLY 8.736 MILES

LENGTH OF PROJECT INCLUDING BRIDGES OVER 20 FOOT SPAN= 46,128.6 FEET= 8.736 MILES  
LENGTH OF PROJECT EXCLUDING BRIDGES OVER 20 FOOT SPAN= 45,951.6 FEET= 8.702 MILES



SCALE - 1 INCH = 4 MILES

STA 0+00 MP 2.512  
BEGINNING OF PROJECT

STA 465+00  
END OF PROJECT  
MP 1.852

SCALES  
Plan 1 in = 50.0 ft  
Profile Hor 1 in = 50.0 ft  
Vert 1 in = 10.0 ft  
Cross Sections 1 in = 5.0 ft

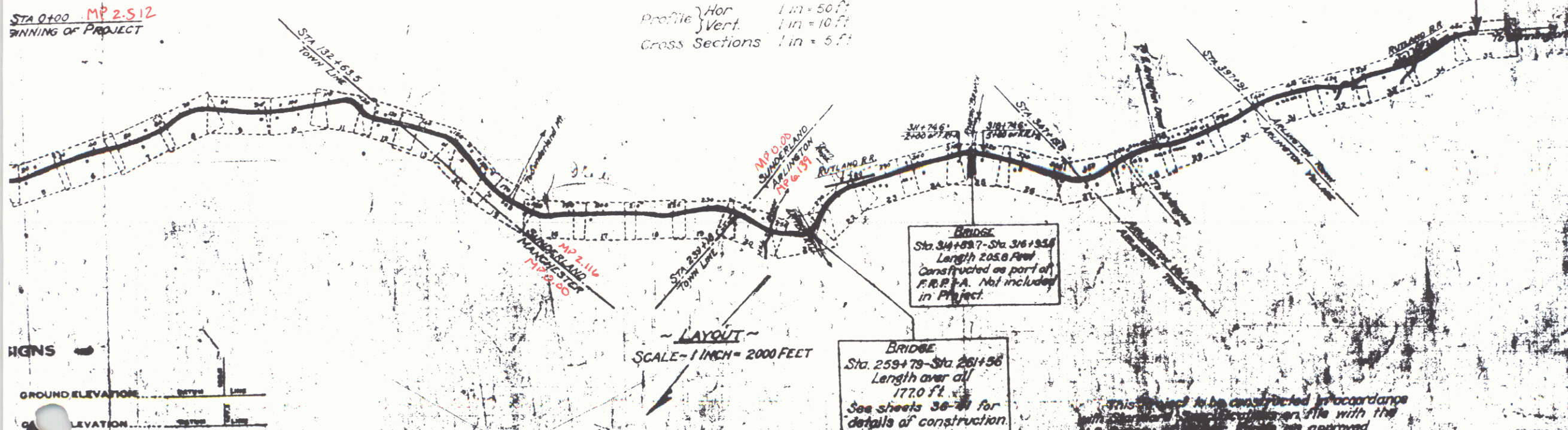

BRIDGE  
Sta. 34+63.7 - Sta. 316+85.6  
Length 202.6 Feet  
Constructed as part of  
F.R.R.P.A. Not included  
in Project.

BRIDGE  
Sta. 259+75 - Sta. 261+56  
Length over all  
177.0 ft  
See sheets 36-37 for  
details of construction.

LAYOUT  
SCALE - 1 INCH = 2000 FEET

VERTICAL CURVES  
GROUND ELEVATION  
PROPOSED ELEVATION

CURVE DATA  
DEFLECTION ANGLE  
DEGREE OF CURVE  
RADIUS OF CURVE  
TANGENT DISTANCE

Pin# 99K75  
11129  
VTR 7A  
Project No. F104A

1