

MATERIAL FOR GRADINGS OF APPROACHES SHALL BE OBTAINED FROM STREAM BED ELEVATION
 MATERIAL FOR SUPERSTRUCTURE OF APPROACHES SHALL BE OBTAINED FROM STREAM BED ELEVATION PROVIDING SUITABLE MATERIAL IS FOUND, IF NOT REVEAL GRAVEL SHALL BE PROVIDED AND PAID FOR UNDER GRAVEL SURFACE COURSE, ITEM #1
 IF MATERIAL IS OBTAINED FROM STREAM BED IT SHALL BE PAID FOR UNDER CHANNEL EXCAVATION

GRAVEL SURFACE COURSE REQUIRED
 ESTIMATED QUANTITY 300 CUB YDS.

WOOD GUARD RAIL REQUIRED
 RIGHT STA 0+51 TO 1+15 LENGTH 64 FT.
 LEFT STA 0+21 TO 1+15 LENGTH 94 FT.
 TOTAL THIS SHEET 152 FT.

FED. ROAD DIST. NO. 109A 1928 3 15

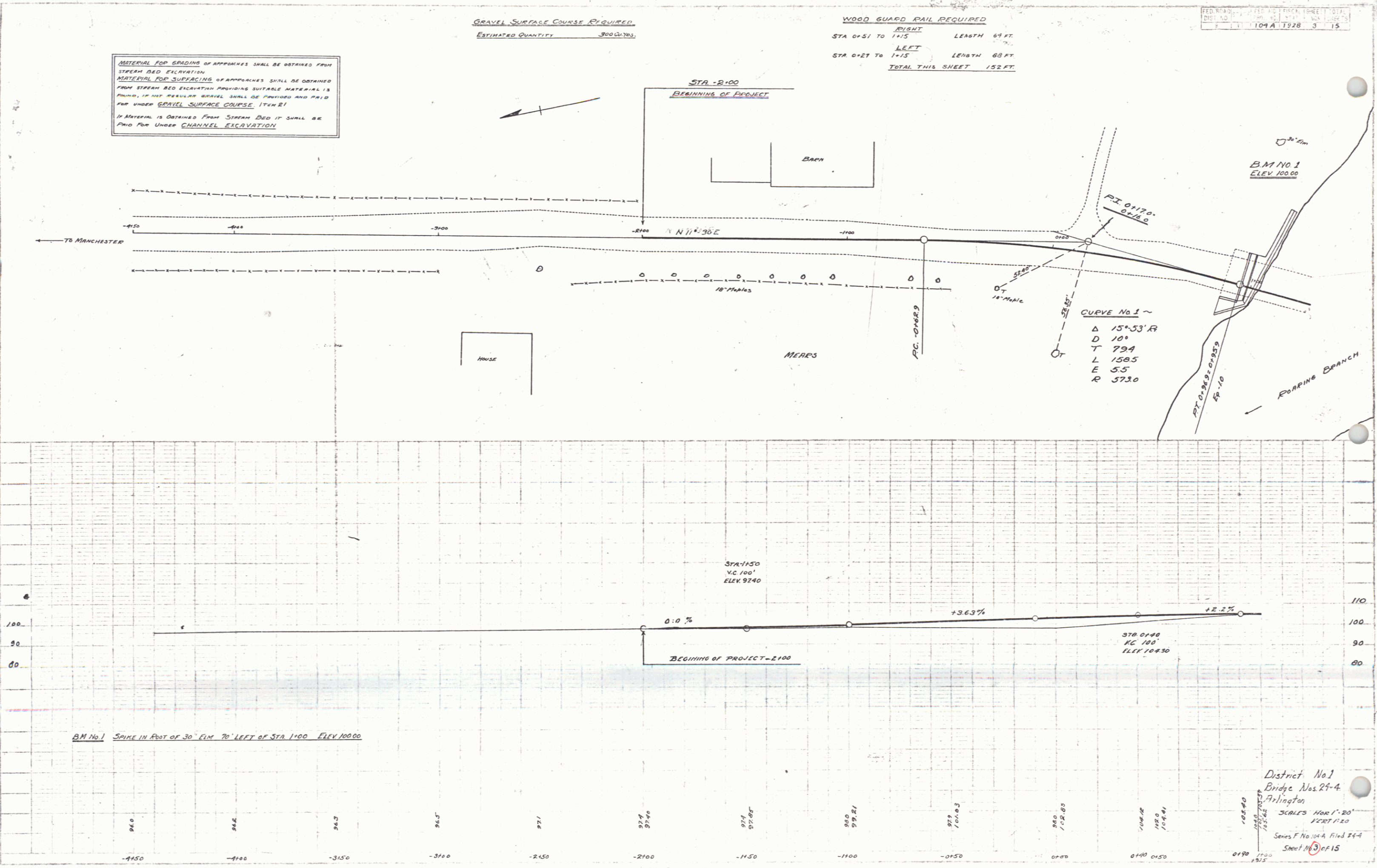

M. W. CHURCHILL

M. W. CHURCHILL
 CIVIL ENGINEER
 216 28

BM No. 1 SPIKE IN POST OF 30' ELM 70' LEFT OF STA 1+00 ELEV. 100.00

District No. 1
 Bridge Nos. 24-4
 Arlington
 SCALES HOR. 1"=20'
 VERT. 1"=20'
 Series F No. 109A Filed 1928
 Sheet No. 3 of 15

