

MATERIAL NOT NEEDED FOR APPROACH OBTAINED FROM CHANNEL EXCAVATION SHALL BE PLACED ALONG NORTH BANK OF STREAM BELOW BRIDGE OR AS DIRECTED BY THE ENGINEER.

MATERIAL IN STREAM CHANNEL ABOVE ELEVATION 95.2 FOR A DISTANCE OF 75 FEET UP AND DOWN STREAM FROM THE E OF BRIDGE SHALL BE REMOVED AND PAID FOR AS CHANNEL EXCAVATION GRABES AND LINES FOR CHANNEL EXCAVATION MAY BE CHANGED BY ENGINEER IN THE FIELD NECESSARY EXCAVATION SHALL BE MADE BELOW THE BRIDGE TO TURN STREAM BACK TO ITS ORIGINAL CHANNEL.

ESTIMATED QUANTITY OF CHANNEL EXCAVATION - 200 CYCLES

WOOD GUARD RAIL REQUIRED  
 BRIDGE LENGTH 40 FT  
 STA 3140 TO 3160  
 LEFT LENGTH 40 FT  
 STA 3120 TO 3160  
 TOTAL THIS SHEET 80 FT

FEB 1928  
 104-A 1928 4 15

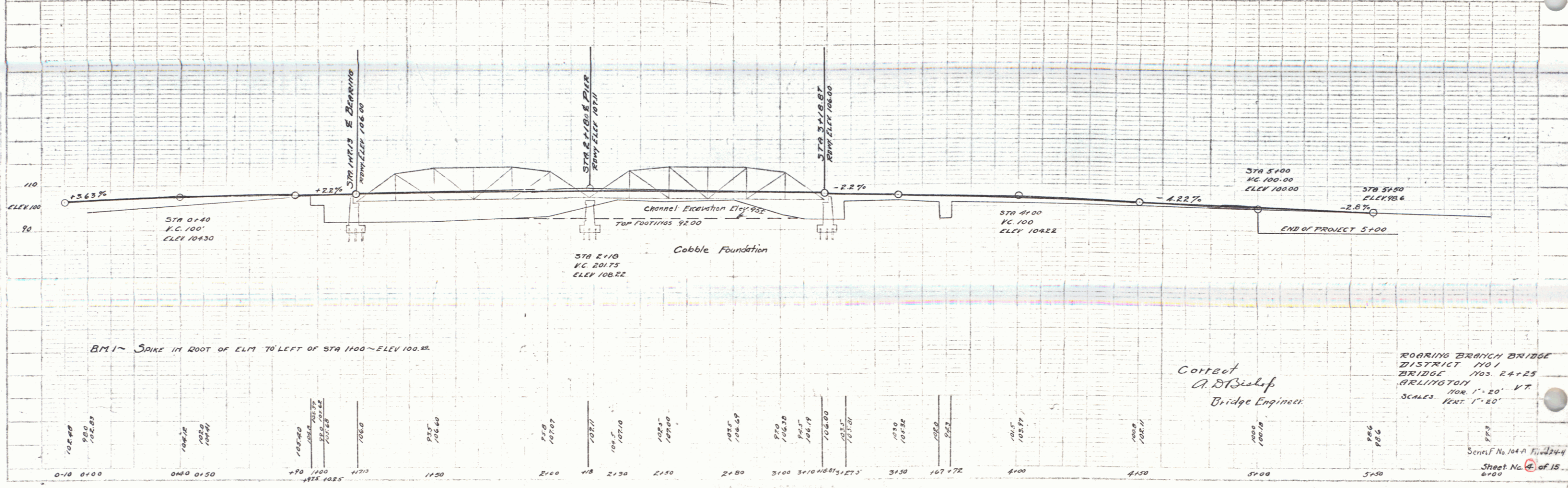
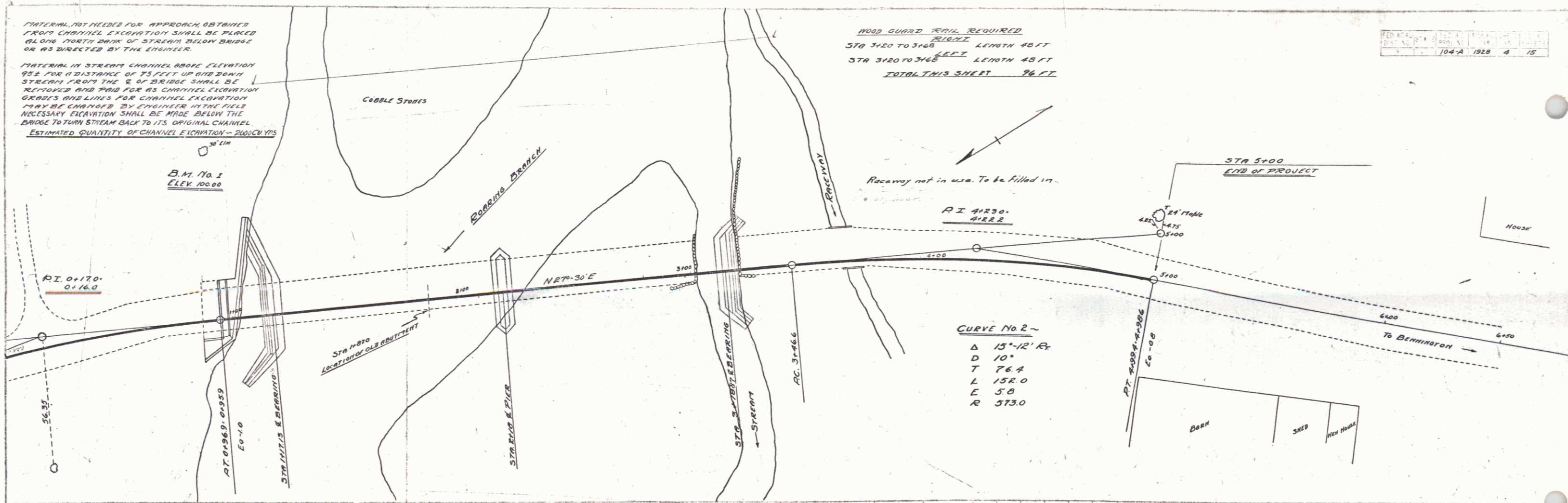

Correct  
 A. D. Bishop  
 Bridge Engineer

ROARING BRANCH BRIDGE  
 DISTRICT 170  
 BRIDGE 1703 24+25  
 BRILLINGTON  
 1703 1" = 20' V.T.  
 SCALES HORIZ 1" = 20'

Series No 104-A 1703-24-25  
 Sheet No. 4 of 15  
 6+00