

INDEX OF SHEETS

SHEET NO. 1	TITLE PAGE
" 2	TYPICAL CROSS-SECTION OF IMPROVEMENT & SUMMARY OF QUANTITIES
" 3-6	LAYOUT SHEETS
" 7-11	STANDARD STRUCTURE SHEET 5-35 (CONCRETE CRIBBING)
" 12-17	CROSS SECTION SHEETS
" 18-20	(OMITTED)

FED. ROAD DIST. NO.	STATE	FED. AID PROJ. NO.	FISCAL YEAR	SHEET NO.	TOTAL SHEETS
9	Vt.	124-A	1937	1	27

(LANDSCAPING)

STATE OF VERMONT
STATE HIGHWAY DEPARTMENT

PLAN AND PROFILE OF PROPOSED
STATE HIGHWAY

FEDERAL AID PROJECT

ROADSIDE IMPROVEMENT
PLANTING PLANS

TOWNS OF

ARLINGTON-SHAFTSBURY

Pin # 99R770

MANCHESTER-BENNINGTON ROAD

ROUTE U.S. 7



BEGINNING AT STA. 465+50 OF PROJECT F.A. 124-A
AND EXTENDING SOUTHERLY TO STA. 641+00

LENGTH OF PROJECT 18,025.9 FEET = 3.413 MILES

RIGHT-OF-WAY DIVISION
TOWN FILE

PERPETUAL

Formerly
Rte. 57
(To Be Returned To R.O.W. Division)

CONVENTIONAL SIGNS

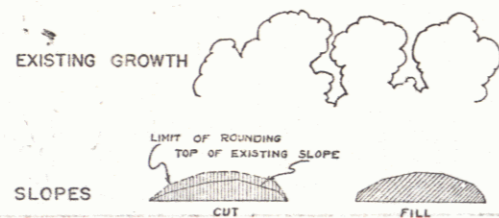

SCALES

TYPICAL SECTIONS AS INDICATED
LAYOUTS 1" = 50'

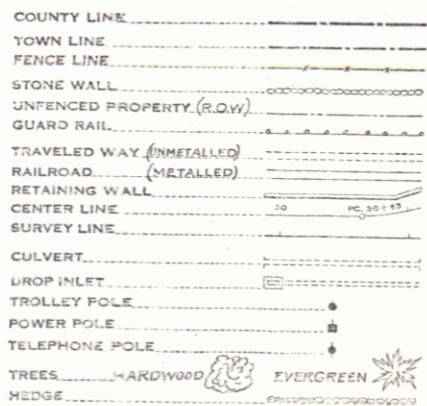
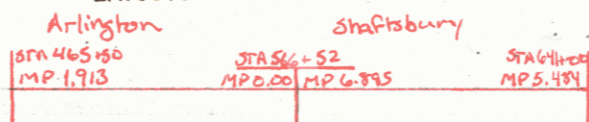

CURVE DATA

- DEFLECTION ANGLE..... Δ
- DEGREE OF CURVE..... D
- RADIUS OF CURVE..... R
- TANGENT DISTANCE..... T
- LENGTH OF CURVE..... L
- EXTERNAL DISTANCE..... E
- POINT OF INTERSECTION..... P. I.
- POINT OF CURVE..... P. C.
- POINT OF TANGENT..... P. T.
- POINT ON TANGENT..... P. O. T.

NOTE
These plans are subject to such revisions as may be required by the Bureau of Public Roads or the Commissioner of Highways. Construction is to be carried on in accordance with the plans and Standard Road and Bridge Specifications of 1936, as approved December 23, 1936 by the Bureau of Public Roads including all subsequent approved revisions and such revised specifications and special provisions as are submitted with the plans.

APPROVED: [Signature]
COMMISSIONER OF HIGHWAYS

SUBMITTED BY ORDER OF THE STATE HIGHWAY BOARD

Project No. FAP 124-A

RECOMMENDED [Signature]
DISTRICT ENGINEER BUREAU OF PUBLIC ROADS
RECOMMENDED FOR APPROVAL [Signature]
CHIEF ENGINEER BUREAU OF PUBLIC ROADS
APPROVED [Signature]
DIRECTOR BUREAU OF PUBLIC ROADS

APPROVED [Signature] SERIES FAP NO. 124-A FILED
BUREAU OF PUBLIC ROADS

SUMMARY OF QUANTITIES

COMMON EXCAVATION (Item 10) As per cross-sections	2578 cy	COMMERCIAL FERTILIZER FOR GRASSES (Item 103) Slopes to be seeded	1305 lbs.
	Total 2578 cy	Slopes to be sodded	270 "
		Total	1575 lbs.
SUB-BASE OF GRAVEL (Item 19-C) Crib backfill	314 cy	GRASS SEED (Item 104-modified) Seed formula A	220 lbs.
	Total 314 cy	Seed formula B	25 "
		Seed formula C	20 "
		Total	265 lbs.
CONCRETE CRIBBING (Item 71-modified) Sta. 580+50-Sta. 583+50 Rt.	629.3 cf	GRASS SOD (Item 105)	2622 sy
Sta. 584+75-Sta. 587+25 Rt.	524.9 "	TOPSOIL (Item 106) Slopes to be seeded	347 cy
Sta. 588+00-Sta. 589+00 Rt.	211.7 "	CUTTING & REMOVING TREES (Item 109) Trees over 15' dia.	3 ea.
Total	1365.9 cf	Trees 15' dia. or less	5 ea.
CLEARING & TRIMMING ROADSIDE (Item 100)	0.5 acres		
FINISH GRADING, FERTILIZING & SEEDING (Item 101)	12,639 sy.		
FINISH GRADING, FERTILIZING & SODDING (Item 102)	2622 sy.		

GRASS SEED MIXTURES (Item 104 modified)

- FORMULA A**—For average good soil conditions.
(To be used unless otherwise noted)
- Kentucky blue grass-----20%
 - White clover-----5%
 - Orchard grass-----15%
 - Red top-----40%
 - Canada blue grass-----10%
 - Red fescue-----10%
- FORMULA B**—For average good soil in shade.
(To be used where noted on layout sheets)
- Red top-----40%
 - Red fescue-----30%
 - White clover-----5%
 - Orchard grass-----15%
 - Canada blue grass-----10%
- FORMULA C**—For poor clay soil.
(To be used where noted on layout sheets)
- Red top-----40%
 - Canada blue grass-----35%
 - Sheep's fescue-----20%
 - White clover-----5%

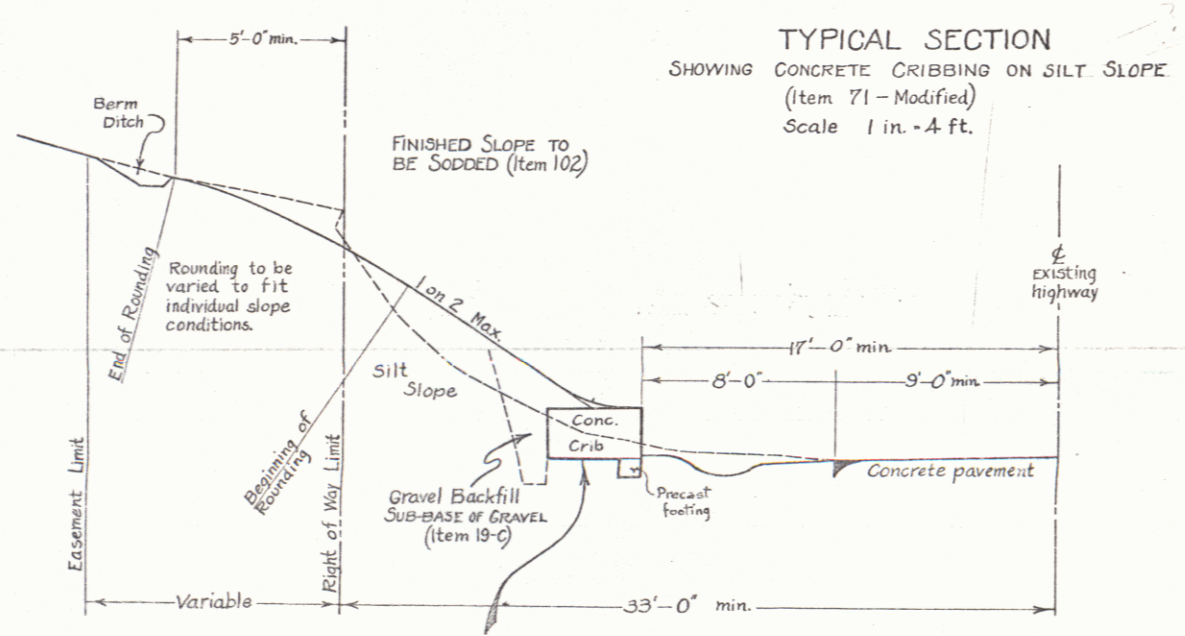

For details of Concrete Cribbing see standard structure sheet S-35
 NOTE: Struts 'A' shall be made 4'-0" total length instead of 7'-0" as shown on S-35
 Revised quantities for modified strut 'A'—4'-0" long.
 Concrete Class A : 1.07 cu.ft.
 Reinforcing Steel: Four 3/8" bars 4'-0 1/2" long—total weight 608 lbs.
 The footing shall be precast in sections not over 10'-0" long.

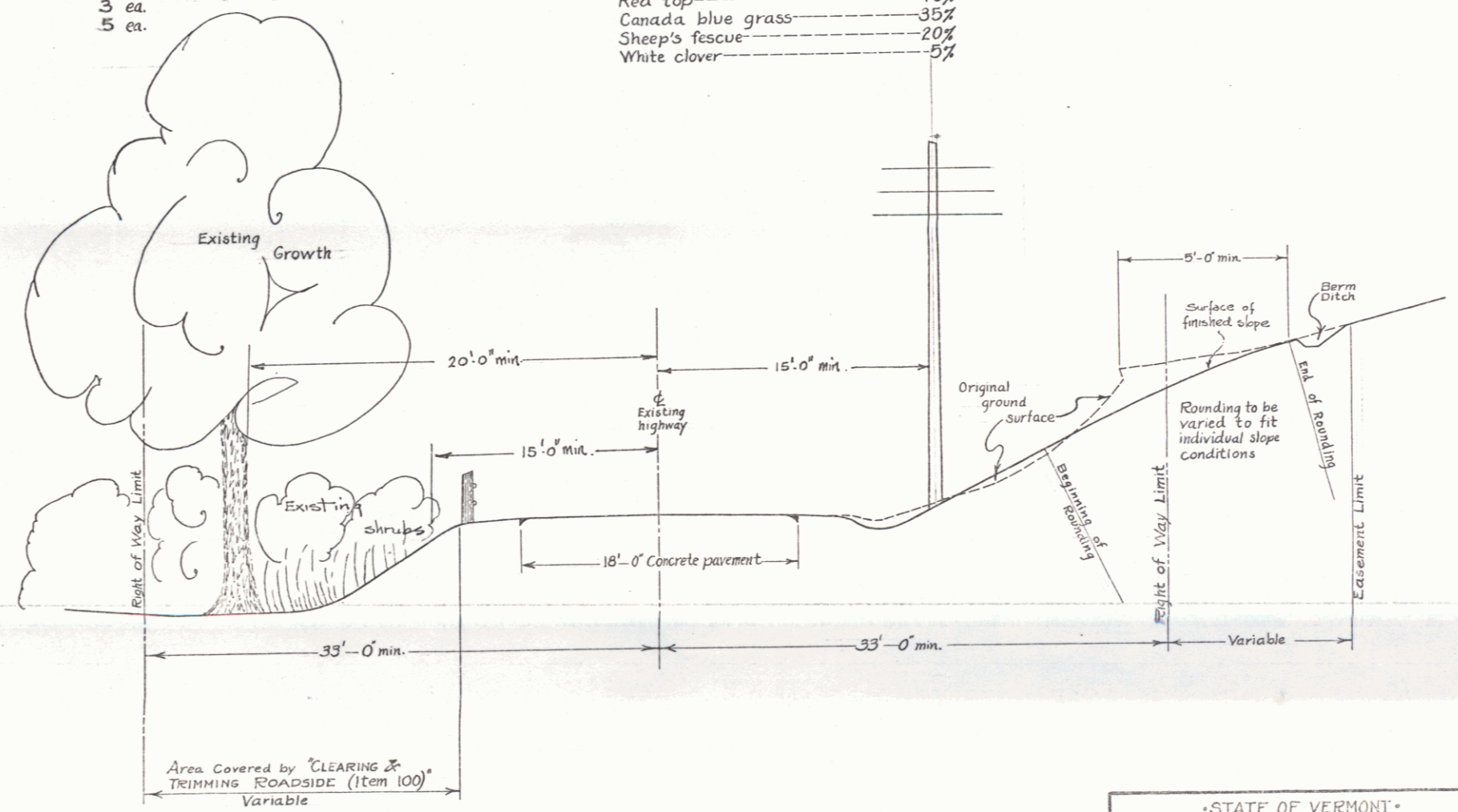

TYPICAL SECTION

Scale: 1 in = 5 ft.

STATE OF VERMONT
 DEPARTMENT OF HIGHWAYS
 DESIGNED BY: A.J. RYNNALS, ROAD ENGINEER
 DRAWN & COMPUTED BY: C.H. BUXTON
 TRACED BY: L.F. CONE
 CHECKED BY: R.O.M., H.S., A.V.C., L.R.C.
 SERIES F.A.P. No. 124-A (LANDSCAPING)
 SHEET 2 OF 27

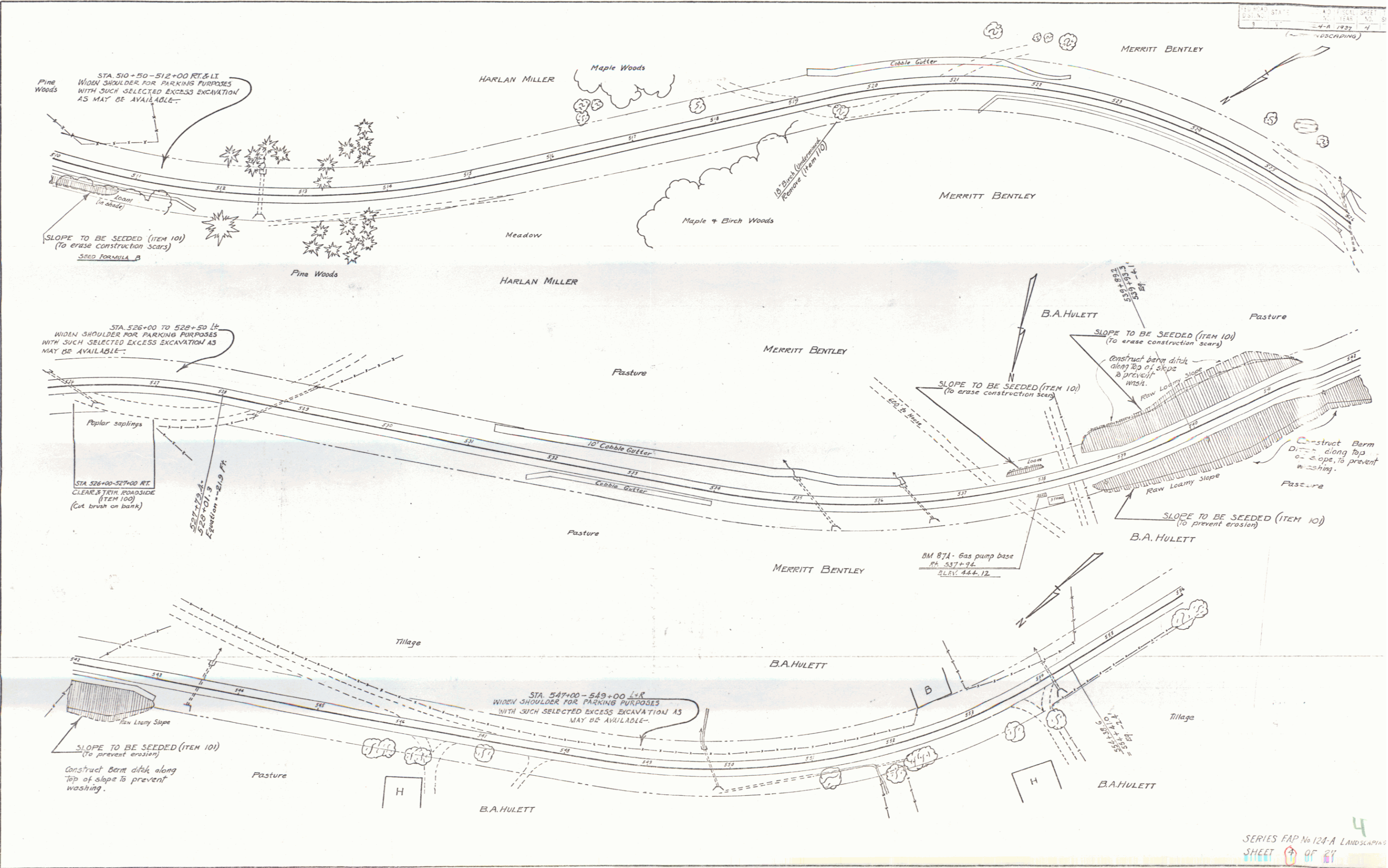

STA. 510+50-512+00 RT. & LT.
 WIDEN SHOULDER FOR PARKING PURPOSES
 WITH SUCH SELECTED EXCESS EXCAVATION
 AS MAY BE AVAILABLE.

SLOPE TO BE SEEDED (ITEM 10)
 (To erase construction scars)
 SEED FORMULA B

STA. 526+00 TO 528+50 LT.
 WIDEN SHOULDER FOR PARKING PURPOSES
 WITH SUCH SELECTED EXCESS EXCAVATION
 AS MAY BE AVAILABLE.

STA. 526+00-527+00 RT.
 CLEAR & TRIM ROADSIDE
 (ITEM 100)
 (Cut brush on bank)

527+00 to 528+50
 Equation = 21.9 PF

STA. 547+00-549+00 L.R.
 WIDEN SHOULDER FOR PARKING PURPOSES
 WITH SUCH SELECTED EXCESS EXCAVATION
 AS MAY BE AVAILABLE.

SLOPE TO BE SEEDED (ITEM 10)
 (To prevent erosion)
 Construct Berm ditch along
 top of slope to prevent
 washing.

SLOPE TO BE SEEDED (ITEM 10)
 (To erase construction scars)
 Construct berm ditch
 along top of slope
 to prevent
 washing.

SLOPE TO BE SEEDED (ITEM 10)
 (To erase construction scars)

SLOPE TO BE SEEDED (ITEM 10)
 (To prevent erosion)

Construct Berm
 Ditch along top
 of slope to prevent
 washing.

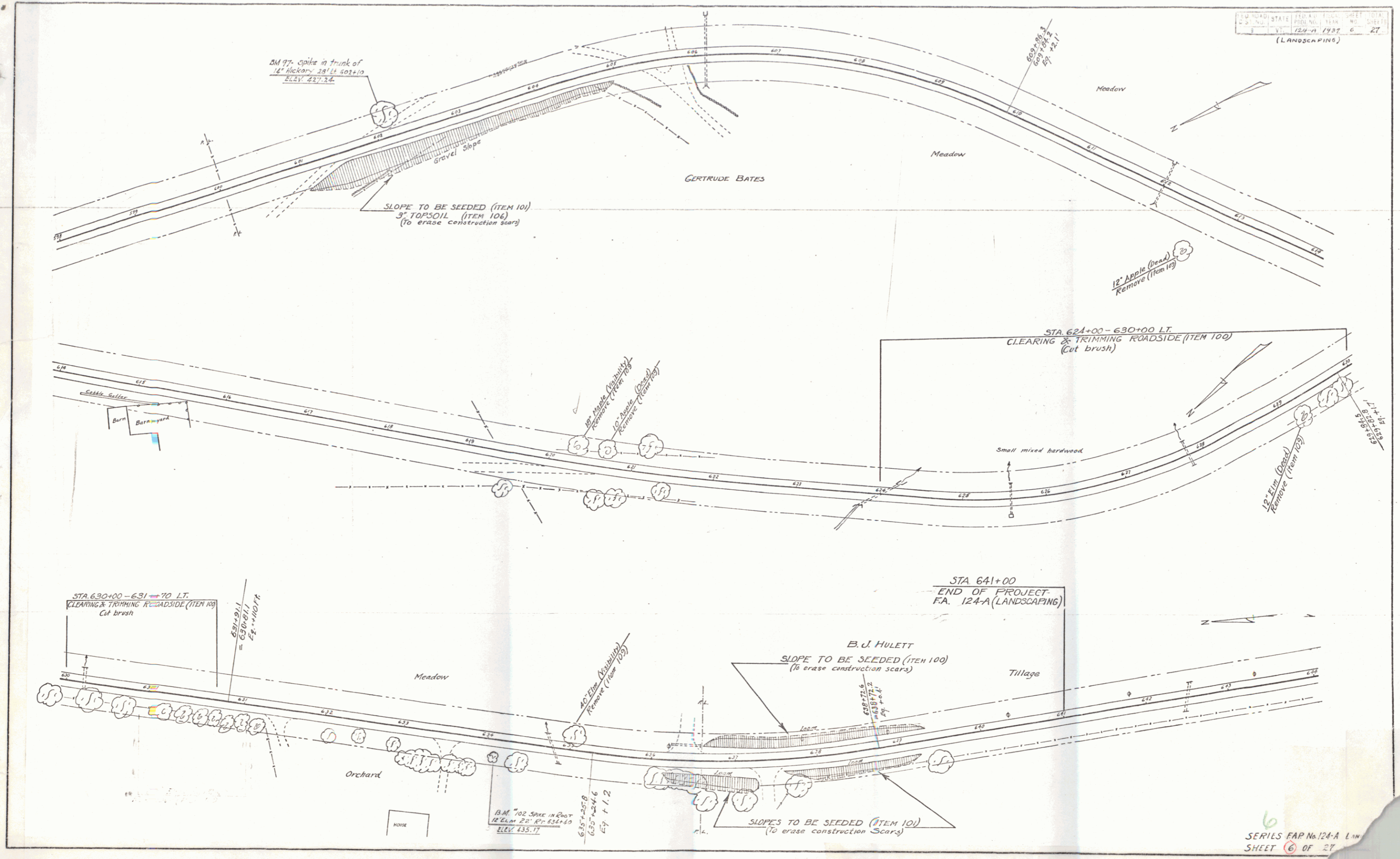

BM 97. spike in trunk of
 14" Hickory 28' Lt 603+10
 ELEV. 227.24

SLOPE TO BE SEEDED (ITEM 101)
 3" TOPSOIL (ITEM 106)
 (To erase construction scars)

STA 624+00 - 630+00 LT.
 CLEARING & TRIMMING ROADSIDE (ITEM 100)
 (Cut brush)

STA 630+00 - 631+70 LT.
 CLEARING & TRIMMING ROADSIDE (ITEM 100)
 (Cut brush)

STA 641+00
 END OF PROJECT
 FA. 124-A (LANDSCAPING)

B. J. HULETT
 SLOPE TO BE SEEDED (ITEM 100)
 (To erase construction scars)

SLOPES TO BE SEEDED (ITEM 101)
 (To erase construction scars)

B.M. 102 spike in post
 12 Elm 20' Rt 634+10
 ELEV. 135.17