

WOOD GUARD RAIL REQUIRED

CULVERT STATION	LEFT	RIGHT
976+19	24'	64'
988+07	24'	24'
991+44	24'	24'

NON DRY CONCRETE PIPE CULVERTS REQUIRED

STATION	DATE	LENG	CURV R	CONC	REIN	STEEL	EXTENS	DI	PROF	AL	GRADE
976+19	15'	36"	30'	30'	30'	30'	30'	30'	30'	30'	30'
988+07	15'	36"	30'	30'	30'	30'	30'	30'	30'	30'	30'

CULVERT REPAIRS REQUIRED

STATION	CONC. R.	REIN. STEEL	EXTENS
991+44	4"	3"	6' And Floor

DRYWAY PIPE CULVERTS REQUIRED

STATION	DATE	LENG	CURV R	CONC	REIN	STEEL	EXTENS
988+28	17'	16"	30'	30'	30'	30'	30'
988+00	17'	16"	30'	30'	30'	30'	30'

124.A 1980 39

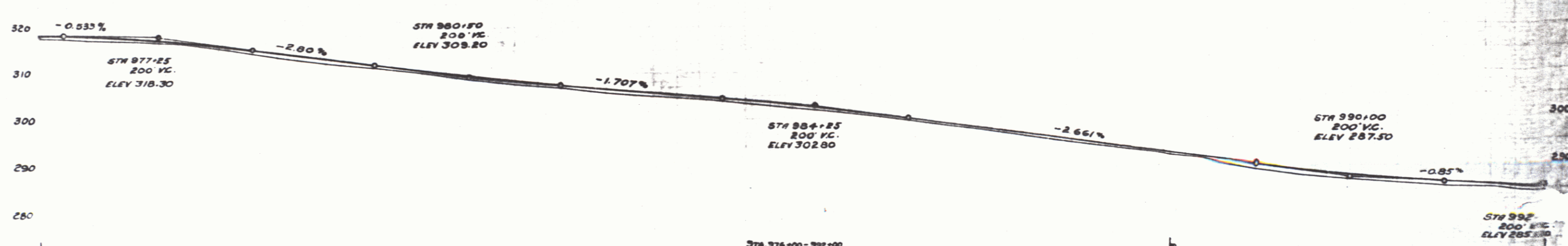
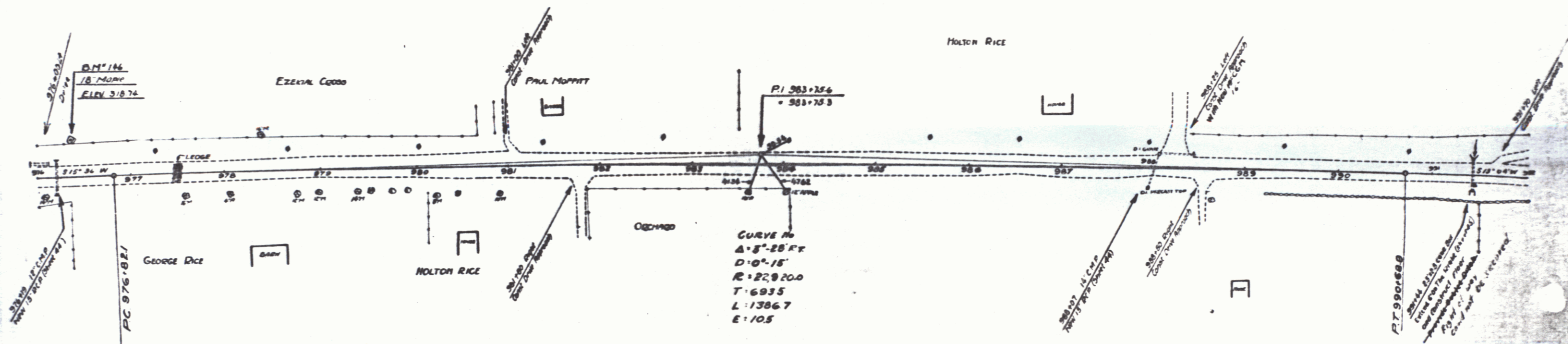

EXISTING SHORE & RISE

Station	Elevation (ft)
976+00	318.30
976+10	318.30
976+20	318.30
976+30	318.30
976+40	318.30
976+50	318.30
976+60	318.30
976+70	318.30
976+80	318.30
976+90	318.30
977+00	318.30
977+10	318.30
977+20	318.30
977+30	318.30
977+40	318.30
977+50	318.30
977+60	318.30
977+70	318.30
977+80	318.30
977+90	318.30
978+00	318.30
978+10	318.30
978+20	318.30
978+30	318.30
978+40	318.30
978+50	318.30
978+60	318.30
978+70	318.30
978+80	318.30
978+90	318.30
979+00	318.30
979+10	318.30
979+20	318.30
979+30	318.30
979+40	318.30
979+50	318.30
979+60	318.30
979+70	318.30
979+80	318.30
979+90	318.30
980+00	318.30
980+10	318.30
980+20	318.30
980+30	318.30
980+40	318.30
980+50	318.30
980+60	318.30
980+70	318.30
980+80	318.30
980+90	318.30
981+00	318.30
981+10	318.30
981+20	318.30
981+30	318.30
981+40	318.30
981+50	318.30
981+60	318.30
981+70	318.30
981+80	318.30
981+90	318.30
982+00	318.30
982+10	318.30
982+20	318.30
982+30	318.30
982+40	318.30
982+50	318.30
982+60	318.30
982+70	318.30
982+80	318.30
982+90	318.30
983+00	318.30
983+10	318.30
983+20	318.30
983+30	318.30
983+40	318.30
983+50	318.30
983+60	318.30
983+70	318.30
983+80	318.30
983+90	318.30
984+00	318.30
984+10	318.30
984+20	318.30
984+30	318.30
984+40	318.30
984+50	318.30
984+60	318.30
984+70	318.30
984+80	318.30
984+90	318.30
985+00	318.30
985+10	318.30
985+20	318.30
985+30	318.30
985+40	318.30
985+50	318.30
985+60	318.30
985+70	318.30
985+80	318.30
985+90	318.30
986+00	318.30
986+10	318.30
986+20	318.30
986+30	318.30
986+40	318.30
986+50	318.30
986+60	318.30
986+70	318.30
986+80	318.30
986+90	318.30
987+00	318.30
987+10	318.30
987+20	318.30
987+30	318.30
987+40	318.30
987+50	318.30
987+60	318.30
987+70	318.30
987+80	318.30
987+90	318.30
988+00	318.30
988+10	318.30
988+20	318.30
988+30	318.30
988+40	318.30
988+50	318.30
988+60	318.30
988+70	318.30
988+80	318.30
988+90	318.30
989+00	318.30
989+10	318.30
989+20	318.30
989+30	318.30
989+40	318.30
989+50	318.30
989+60	318.30
989+70	318.30
989+80	318.30
989+90	318.30
990+00	318.30
990+10	318.30
990+20	318.30
990+30	318.30
990+40	318.30
990+50	318.30
990+60	318.30
990+70	318.30
990+80	318.30
990+90	318.30
991+00	318.30
991+10	318.30
991+20	318.30
991+30	318.30
991+40	318.30
991+50	318.30
991+60	318.30
991+70	318.30
991+80	318.30
991+90	318.30
992+00	318.30