

WOOD GUARD RAIL REQUIRED

CULVERT STATION	LEFT	RIGHT
929+21	24'	24'

CONCRETE GUIDE POSTS REQUIRED

STATION	LEFT	RIGHT
925+50		

NEW DEEP CONCRETE PIPE CULVERTS REQUIRED

STATION	DIM	LEN	CONC	CHCK	EMF	STREEL
929+21	18"	36'	-	300g	3310g	

STANDARD UNDERDRAIN WITH VITRIFIED CLAY PIPE

STATION	L" x	B" x H	LEN	CONC	EMF	STREEL
925+23	6"	6"	50'			

EXISTING PIPE CULVERTS C.G.M.P.

STATION	L" x	DIM	LEN	CONC	EMF	STREEL
926+00	18"	24"				
926+80	18"	24"				
926+50	18"	24"				

GRONTER CABLE WATER PLOD

STATION	POS	WIDTH	LA
925+21	LT	14' x 11'	3.0

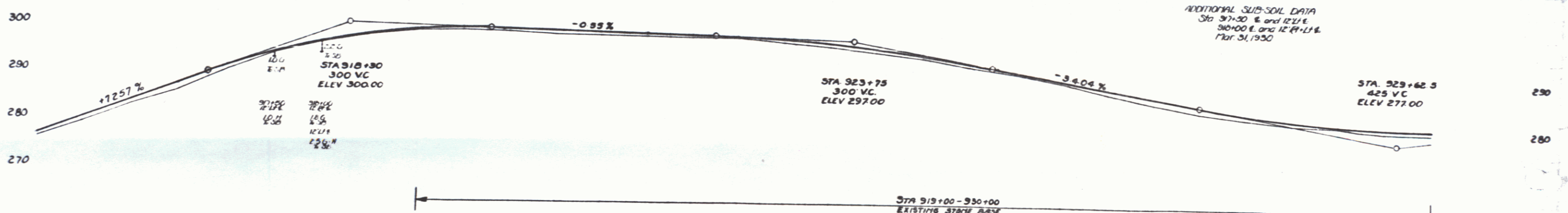
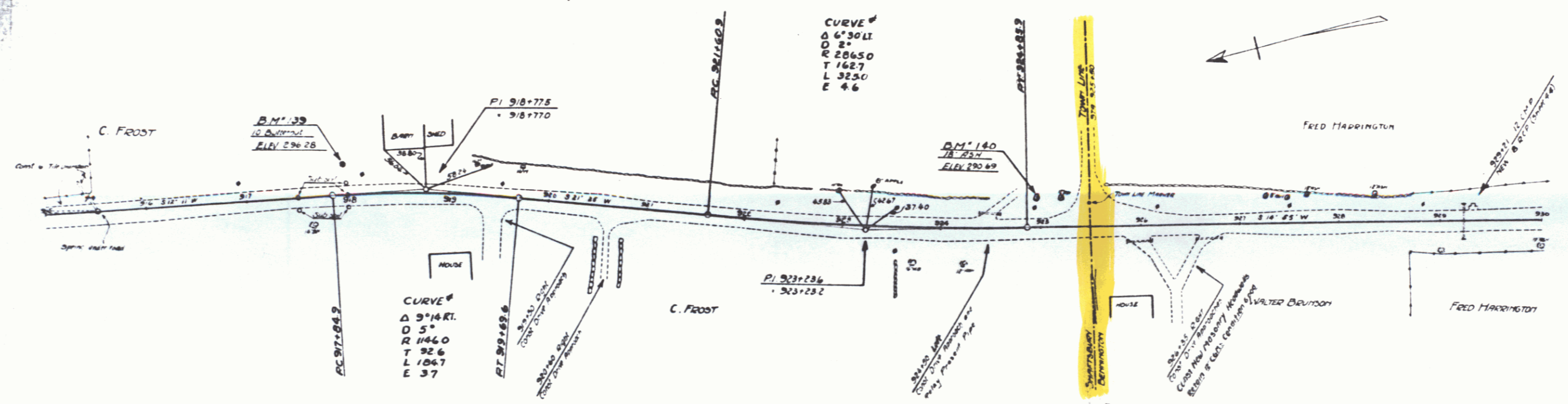

STATION	ELEV
915	276.05
916	278.68
917	281.18
918	283.84
919	286.52
920	289.22
921	291.94
922	294.68
923	297.44
924	300.22
925	303.02
926	305.84
927	308.68
928	311.54
929	314.42
930	317.32
931	320.24
932	323.18
933	326.14
934	329.12
935	332.12
936	335.14
937	338.18
938	341.24
939	344.32
940	347.42
941	350.54
942	353.68
943	356.84
944	360.02
945	363.22
946	366.44
947	369.68
948	372.94
949	376.22
950	379.52
951	382.84
952	386.18
953	389.54
954	392.92
955	396.32
956	399.74
957	403.18
958	406.64
959	410.12
960	413.62
961	417.14
962	420.68
963	424.24
964	427.82
965	431.42
966	435.04
967	438.68
968	442.34
969	446.02
970	449.72
971	453.44
972	457.18
973	460.94
974	464.72
975	468.52
976	472.34
977	476.18
978	480.04
979	483.92
980	487.82
981	491.74
982	495.68
983	499.64
984	503.62
985	507.62
986	511.64
987	515.68
988	519.74
989	523.82
990	527.92
991	532.04
992	536.18
993	540.34
994	544.52
995	548.72
996	552.94
997	557.18
998	561.44
999	565.72
1000	570.02

B.M. 139 SOLE POINT OF 10 BUTTERFLY BARRIERS AT STA 917+96 - ELEV. 296.28
 B.M. 140 SOLE POINT OF 18 18" x 24" ST. OF STA 924+95 - ELEV. 290.69