

PROPOSED DRAINAGE SYSTEM

12" RCP 15' SPACING 15' SPACING 15' SPACING

STATION	LINE
816+28	816+00
816+27	816+00
816+25	816+00
816+10	816+00
816+05	816+00
816+00	816+00

CONSTRUCT SULLIVAN ROAD APPROACH THROUGH THE VILLAGE OF SOUTH SHUTSWORTH

SEE SHEET 124 A 1930 32 FOR DETAILS OF CATCH BASINS - SEE SHEET NO. 40

See other Spots of System

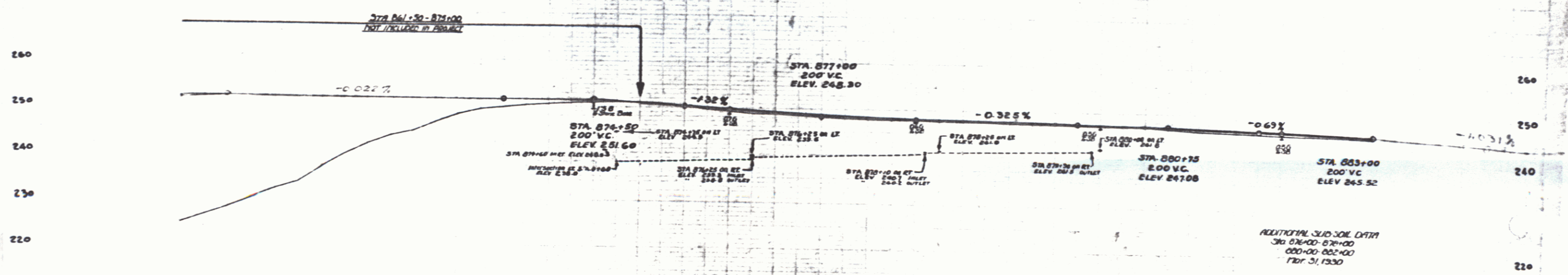
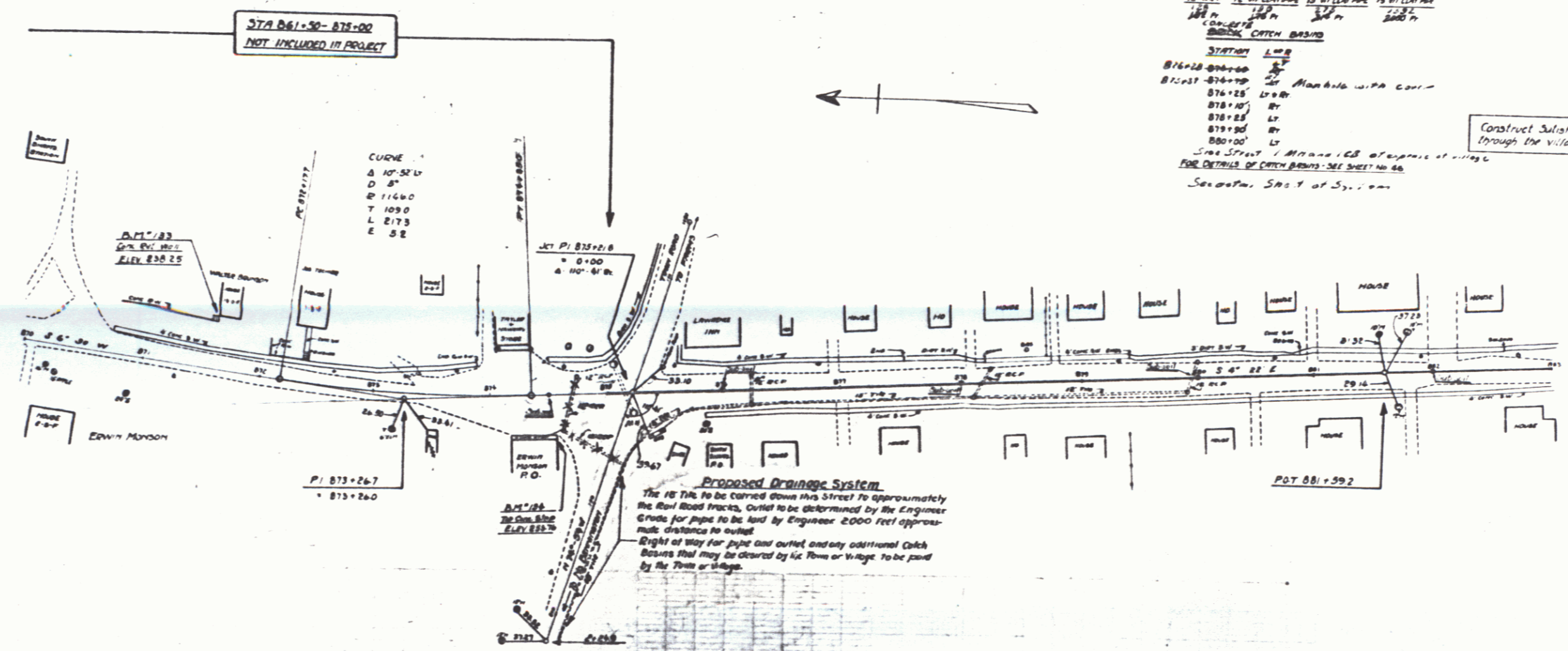

224.7
226.4
228.0
229.9
231.8
234.1
236.3
239.1
241.6
244.2
246.7
249.0
251.6
254.2
257.0
259.9
262.8
265.6
268.4
271.2
274.0
276.8
279.6
282.4
285.2
288.0
290.8
293.6
296.4
299.2
302.0
304.8
307.6
310.4
313.2
316.0
318.8
321.6
324.4
327.2
330.0
332.8
335.6
338.4
341.2
344.0
346.8
349.6
352.4
355.2
358.0
360.8
363.6
366.4
369.2
372.0
374.8
377.6
380.4
383.2
386.0
388.8
391.6
394.4
397.2
400.0
402.8
405.6
408.4
411.2
414.0
416.8
419.6
422.4
425.2
428.0
430.8
433.6
436.4
439.2
442.0
444.8
447.6
450.4
453.2
456.0
458.8
461.6
464.4
467.2
470.0
472.8
475.6
478.4
481.2
484.0
486.8
489.6
492.4
495.2
498.0
500.8
503.6
506.4
509.2
512.0
514.8
517.6
520.4
523.2
526.0
528.8
531.6
534.4
537.2
540.0
542.8
545.6
548.4
551.2
554.0
556.8
559.6
562.4
565.2
568.0
570.8
573.6
576.4
579.2
582.0
584.8
587.6
590.4
593.2
596.0
598.8
601.6
604.4
607.2
610.0
612.8
615.6
618.4
621.2
624.0
626.8
629.6
632.4
635.2
638.0
640.8
643.6
646.4
649.2
652.0
654.8
657.6
660.4
663.2
666.0
668.8
671.6
674.4
677.2
680.0
682.8
685.6
688.4
691.2
694.0
696.8
699.6
702.4
705.2
708.0
710.8
713.6
716.4
719.2
722.0
724.8
727.6
730.4
733.2
736.0
738.8
741.6
744.4
747.2
750.0
752.8
755.6
758.4
761.2
764.0
766.8
769.6
772.4
775.2
778.0
780.8
783.6
786.4
789.2
792.0
794.8
797.6
800.4
803.2
806.0
808.8
811.6
814.4
817.2
820.0
822.8
825.6
828.4
831.2
834.0
836.8
839.6
842.4
845.2
848.0
850.8
853.6
856.4
859.2
862.0
864.8
867.6
870.4
873.2
876.0
878.8
881.6
884.4
887.2
890.0
892.8
895.6
898.4
901.2
904.0
906.8
909.6
912.4
915.2
918.0
920.8
923.6
926.4
929.2
932.0
934.8
937.6
940.4
943.2
946.0
948.8
951.6
954.4
957.2
960.0
962.8
965.6
968.4
971.2
974.0
976.8
979.6
982.4
985.2
988.0
990.8
993.6
996.4
999.2
1002.0
1004.8
1007.6
1010.4
1013.2
1016.0
1018.8
1021.6
1024.4
1027.2
1030.0
1032.8
1035.6
1038.4
1041.2
1044.0
1046.8
1049.6
1052.4
1055.2
1058.0
1060.8
1063.6
1066.4
1069.2
1072.0
1074.8
1077.6
1080.4
1083.2
1086.0
1088.8
1091.6
1094.4
1097.2
1100.0
1102.8
1105.6
1108.4
1111.2
1114.0
1116.8
1119.6
1122.4
1125.2
1128.0
1130.8
1133.6
1136.4
1139.2
1142.0
1144.8
1147.6
1150.4
1153.2
1156.0
1158.8
1161.6
1164.4
1167.2
1170.0
1172.8
1175.6
1178.4
1181.2
1184.0
1186.8
1189.6
1192.4
1195.2
1198.0
1200.8
1203.6
1206.4
1209.2
1212.0
1214.8
1217.6
1220.4
1223.2
1226.0
1228.8
1231.6
1234.4
1237.2
1240.0
1242.8
1245.6
1248.4
1251.2
1254.0
1256.8
1259.6
1262.4
1265.2
1268.0
1270.8
1273.6
1276.4
1279.2
1282.0
1284.8
1287.6
1290.4
1293.2
1296.0
1298.8
1301.6
1304.4
1307.2
1310.0
1312.8
1315.6
1318.4
1321.2
1324.0
1326.8
1329.6
1332.4
1335.2
1338.0
1340.8
1343.6
1346.4
1349.2
1352.0
1354.8
1357.6
1360.4
1363.2
1366.0
1368.8
1371.6
1374.4
1377.2
1380.0
1382.8
1385.6
1388.4
1391.2
1394.0
1396.8
1399.6
1402.4
1405.2
1408.0
1410.8
1413.6
1416.4
1419.2
1422.0
1424.8
1427.6
1430.4
1433.2
1436.0
1438.8
1441.6
1444.4
1447.2
1450.0
1452.8
1455.6
1458.4
1461.2
1464.0
1466.8
1469.6
1472.4
1475.2
1478.0
1480.8
1483.6
1486.4
1489.2
1492.0
1494.8
1497.6
1500.4
1503.2
1506.0
1508.8
1511.6
1514.4
1517.2
1520.0
1522.8
1525.6
1528.4
1531.2
1534.0
1536.8
1539.6
1542.4
1545.2
1548.0
1550.8
1553.6
1556.4
1559.2
1562.0
1564.8
1567.6
1570.4
1573.2
1576.0
1578.8
1581.6
1584.4
1587.2
1590.0
1592.8
1595.6
1598.4
1601.2
1604.0
1606.8
1609.6
1612.4
1615.2
1618.0
1620.8
1623.6
1626.4
1629.2
1632.0
1634.8
1637.6
1640.4
1643.2
1646.0
1648.8
1651.6
1654.4
1657.2
1660.0
1662.8
1665.6
1668.4
1671.2
1674.0
1676.8
1679.6
1682.4
1685.2
1688.0
1690.8
1693.6
1696.4
1699.2
1702.0
1704.8
1707.6
1710.4
1713.2
1716.0
1718.8
1721.6
1724.4
1727.2
1730.0
1732.8
1735.6
1738.4
1741.2
1744.0
1746.8
1749.6
1752.4
1755.2
1758.0
1760.8
1763.6
1766.4
1769.2
1772.0
1774.8
1777.6
1780.4
1783.2
1786.0
1788.8
1791.6
1794.4
1797.2
1800.0
1802.8
1805.6
1808.4
1811.2
1814.0
1816.8
1819.6
1822.4
1825.2
1828.0
1830.8
1833.6
1836.4
1839.2
1842.0
1844.8
1847.6
1850.4
1853.2
1856.0
1858.8
1861.6
1864.4
1867.2
1870.0
1872.8
1875.6
1878.4
1881.2
1884.0
1886.8
1889.6
1892.4
1895.2
1898.0
1900.8
1903.6
1906.4
1909.2
1912.0
1914.8
1917.6
1920.4
1923.2
1926.0
1928.8
1931.6
1934.4
1937.2
1940.0
1942.8
1945.6
1948.4
1951.2
1954.0
1956.8
1959.6
1962.4
1965.2
1968.0
1970.8
1973.6
1976.4
1979.2
1982.0
1984.8
1987.6
1990.4
1993.2
1996.0
1998.8
2001.6
2004.4
2007.2
2010.0
2012.8
2015.6
2018.4
2021.2
2024.0
2026.8
2029.6
2032.4
2035.2
2038.0
2040.8
2043.6
2046.4
2049.2
2052.0
2054.8
2057.6
2060.4
2063.2
2066.0
2068.8
2071.6
2074.4
2077.2
2080.0
2082.8
2085.6
2088.4
2091.2
2094.0
2096.8
2099.6
2102.4
2105.2
2108.0
2110.8
2113.6
2116.4
2119.2
2122.0
2124.8
2127.6
2130.4
2133.2
2136.0
2138.8
2141.6
2144.4
2147.2
2150.0
2152.8
2155.6
2158.4
2161.2
2164.0
2166.8
2169.6
2172.4
2175.2
2178.0
2180.8
2183.6
2186.4
2189.2
2192.0
2194.8
2197.6
2200.4
2203.2
2206.0
2208.8
2211.6
2214.4
2217.2
2220.0
2222.8
2225.6
2228.4
2231.2
2234.0
2236.8
2239.6
2242.4
2245.2
2248.0
2250.8
2253.6
2256.4
2259.2
2262.0
2264.8
2267.6
2270.4
2273.2
2276.0
2278.8
2281.6
2284.4
2287.2
2290.0
2292.8
2295.6
2298.4
2301.2
2304.0
2306.8
2309.6
2312.4
2315.2
2318.0
2320.8
2323.6
2326.4
2329.2
2332.0
2334.8
2337.6
2340.4
2343.2
2346.0
2348.8
2351.6
2354.4
2357.2
2360.0
2362.8
2365.6
2368.4
2371.2
2374.0
2376.8
2379.6
2382.4
2385.2
2388.0
2390.8
2393.6
2396.4
2399.2
2402.0
2404.8
2407.6
2410.4
2413.2
2416.0
2418.8
2421.6
2424.4
2427.2
2430.0
2432.8
2435.6
2438.4
2441.2
2444.0
2446.8
2449.6
2452.4
2455.2
2458.0
2460.8
2463.6
2466.4
2469.2
2472.0
2474.8
2477.6
2480.4
2483.2
2486.0
2488.8
2491.6
2494.4
2497.2
2500.0
2502.8
2505.6
2508.4
2511.2
2514.0
2516.8
2519.6
2522.4
2525.2
2528.0
2530.8
2533.6
2536.4
2539.2
2542.0
2544.8
2547.6
2550.4
2553.2
2556.0
2558.8
2561.6
2564.4
2567.2
2570.0
2572.8
2575.6
2578.4
2581.2
2584.0
2586.8
2589.6
2592.4
2595.2
2598.0
2600.8
2603.6
2606.4
2609.2
2612.0
2614.8
2617.6
2620.4
2623.2
2626.0
2628.8
2631.6
2634.4
2637.2
2640.0
2642.8
2645.6
2648.4
2651.2
2654.0
2656.8
2659.6
2662.4
2665.2
2668.0
2670.8
2673.6
2676.4
2679.2
2682.0
2684.8
2687.6
2690.4
2693.2
2696.0
2698.8
2701.6
2704.4
2707.2
2710.0
2712.8
2715.6
2718.4
2721.2
2724.0
2726.8
2729.6
2732.4
2735.2
2738.0
2740.8
2743.6
2746.4
2749.2
2752.0
2754.8
2757.6
2760.4
2763.2
2766.0
2768.8
2771.6
2774.4
2777.2
2780.0
2782.8
2785.6
2788.4
2791.2
2794.0
2796.8
2799.6
2802.4
2805.2
2808.0
2810.8
2813.6
2816.4
2819.2
2822.0
2824.8
2827.6
2830.4
2833.2
2836.0
2838.8
2841.6
2844.4
2847.2
2850.0
2852.8
2855.6
2858.4
2861.2
2864.0
2866.8
2869.6
2872.4
2875.2
2878.0
2880.8
2883.6
2886.4
2889.2
2892.0
2894.8
2897.6
2900.4
2903.2
2906.0
2908.8
2911.6
2914.4
2917.2
2920.0
2922.8
2925.6
2928.4
2931.2
2934.0
2936.8
2939.6
2942.4
2945.2
2948.0
2950.8
2953.6
2956.4
2959.2
2962.0
2964.8
2967.6
2970.4
2973.2
2976.0
2978.8
2981.6
2984.4
2987.2
2990.0
2992.8
2995.6
2998.4
3001.2
3004.0
3006.8
3009.6
3012.4
3015.2
3018.0
3020.8
3023.6
3026.4
3029.2
3032.0
3034.8
3037.6
3040.4
3043.2
3046.0
3048.8
3051.6
3054.4
3057.2
3060.0
3062.8
3065.6
3068.4
3071.2
3074.0
3076.8
3079.6
3082.4
3085.2
3088.0
3090.8
3093.6
3096.4
3099.2
3102.0
3104.8
3107.6
3110.4
3113.2
3116.0
3118.8
3121.6
3124.4
3127.2
3130.0
3132.8
3135.6
3138.4
3141.2
3144.0
3146.8
3149.6
3152.4
3155.2
3158.0
3160.8
3163.6
3166.4
3169.2
3172.0
3174.8
3177.6
3180.4
3183.2
3186.0
3188.8
3191.6
3194.4
3197.2
3200.0
3202.8
3205.6
3208.4
3211.2
3214.0
3216.8
3219.6
3222.4
3225.2
3228.0
3230.8
3233.6
3236.4
3239.2
3242.0
3244.8
3247.6
3250.4
3253.2
3256.0
3258.8
3261.6
3264.4
3267.2
3270.0
3272.8
3275.6
3278.4
3281.2
3284.0
3286.8
3289.6
3292.4
3295.2
3298.0
3300.8
3303.6
3306.4
3309.2
3312.0
3314.8
3317.6
3320.4
3323.2
3326.0
3328.8
3331.6
3334.4
3337.2
3340.0
3342.8
3345.6
3348.4
3351.2
3354.0
3356.8
3359.6
3362.4
3365.2
3368.0
3370.8
3373.6
3376.4
3379.2
3382.0
3384.8
3387.6
3390.4
3393.2
3396.0
3398.8
3401.6
3404.4
3407.2
3410.0
3412.8
3415.6
3418.4
3421.2
3424.0
3426.8
3429.6
3432.4
3435.2
3438.0
3440.8
3443.6
3446.4
3449.2
3452.0
3454.8
3457.6
3460.4
3463.2
3466.0
3468.8
3471.6
3474.4
3477.2
3480.0
3482.8
3485.6
3488.4
3491.2
3494.0
3496.8
3499.6
3502.4
3505.2
3508.0
3510.8
3513.6
3516.4
3519.2
3522.0
3524.8
3527.6
3530.4
3533.2
3536.0
3538.8
3541.6
3544.4
3547.2
3550.0
3552.8
3555.6
3558.4
3561.2
3564.0
3566.8
3569.6
3572.4
3575.2
3578.0
3580.8
3583.6
3586.4
3589.2
3592.0
3594.8
3597.6
3600.4
3603.2
3606.0
3608.8
3611.6
3614.4
3617.2
3620.0
3622.8
3625.6
3628.4
3631.2
3634.0
3636.8
3639.6
3642.4
3645.2
3648.0
3650.8
3653.6
3656.4
3659.2
3662.0
3664.8
3667.6
3670.4
3673.2
3676.0
3678.8
3681.6
3684.4
3687.2
3690.0
3692.8
3695.6
3698.4
3701.2
3704.0
3706.8
3709.6
3712.4
3715.2
3718.0
3720.8
3723.6
3726.4
3729.2
3732.0
3734.8
3737.6
3740.4
3743.2
3746.0
3748.8
3751.6
3754.4
3757.2
3760.0
3762.8
3765.6
3768.4
3771.2
3774.0
3776.8
3779.6
3782.4
3785.2
3788.0
3790.8
3793.6
3796.4
3799.2
3802.0
3804.8
3807.6
3810.4
3813.2
3816.0
3818.8
3821.6
3824.4
3827.2
3830.0
3832.8
3835.6
3838.4
3841.2
3844.0
3846.8
3849.6
3852.4
3855.2
3858.0
3860.8
3863.6
3866.4
3869.2
3872.0
3874.8
3877.6
3880.4
3883.2
3886.0
3888.8
3891.6
3894.4
3897.2
3900.0
3902.8
3905.6
3908.4
3911.2
3914.0
3916.8
3919.6
3922.4
3925.2
3928.0
3930.8
3933.6
3936.4
3939.2
3942.0
3944.8
3947.6
3950.4
3953.2
3956.0
3958.8
3961.6
3964.4
3967.2
3970.0
3972.8
3975.6
3978.4
3981.2
3984.0
3986.8
3989.6
3992.4
3995.2
3998.0
4000.8
4003.6
4006.4
4009.2
4012.0
4014.8
4017.6
4020.4
4023.2
4026.0
4028.8
4031.6
4034.4
4037.2
4040.0
4042.8
4045.6
4048.4
4051.2
4054.0
4056.8
4059.6
4062.4
4065.2
4068.0
4070.8
4073.6
4076.4
4079.2
4082.0
4084.8
4087.6
4090.4
4093.2
4096.0
4098.8
4101.6
4104.4
4107.2
4110.0
4112.8
4115.6
4118.4
4121.2
4124.0
4126.8
4129.6
4132.4
4135.2
4138.0
4140.8
4143.6
4146.4
4149.2
4152.0
4154.8
4157.6
4160.4
4163.2
4166.0
4168.8
4171.6
4174.4
4177.2
4180.0
4182.8
4185.6
4188.4
4191.2
4194.0
4196.8
4199.6
4202.4
4205.2
4208.0
4210.8
4213.6
4216.4
4219.2
4222.0
4224.8
4227.6
4230.4
4233.2
4236.0
4238.8
4241.6
4244.4
4247.2
4250.0
4252.8
4255.6
4258.4
4261.2
4264.0
4266.8
4269.6
4272.4
4275.2
4278.0
4280.8
4283.6
4286.4
4289.2
4292.0
4294.8
4297.6
4300.4
4303.2
4306.0
4308.8
4311.6
4314.4
4317.2
4320.0
4322.8
4325.6
4328.4
4331.2
4334.0
4336.8
4339.6
4342.4
4345.2
4348.0
4350.8
4353.6
4356.4
4359.2
4362.0
4364.8
4367.6
4370.