

**WOOD GUANO DIMS REQUIRED**

STATION	LEFT	RIGHT
848+25	26'	26'

**CABLE GUANO DIMS REQUIRED**

STATION	LEFT	RIGHT
848+25 - 848+75	32'	32'
848+75 - 848+94	28'	28'
848+94 - 848+108	28'	28'
848+108 - 848+126	28'	28'

**NEW CONCRETE PAVEMENT REQUIRED**

STATION	LEFT	RIGHT
848+25 - 848+45	26'	26'
848+45 - 848+75	32'	32'

**GRAVEL CEMENT BITUM REQUIRED**

STATION	LEFT	RIGHT
848+25 - 848+75	18.21	18.21
848+75 - 848+126	15.42	15.42

**INTERM. CURB USED**

Station	HT	Length
848+25 - 848+52	3'	4.55'

**METAL DECK INLETS USED**

Station	DI	Ends	HT	Length
848+50B	1	12	4'	26"
848+62B	1	1	6'	4' 26"

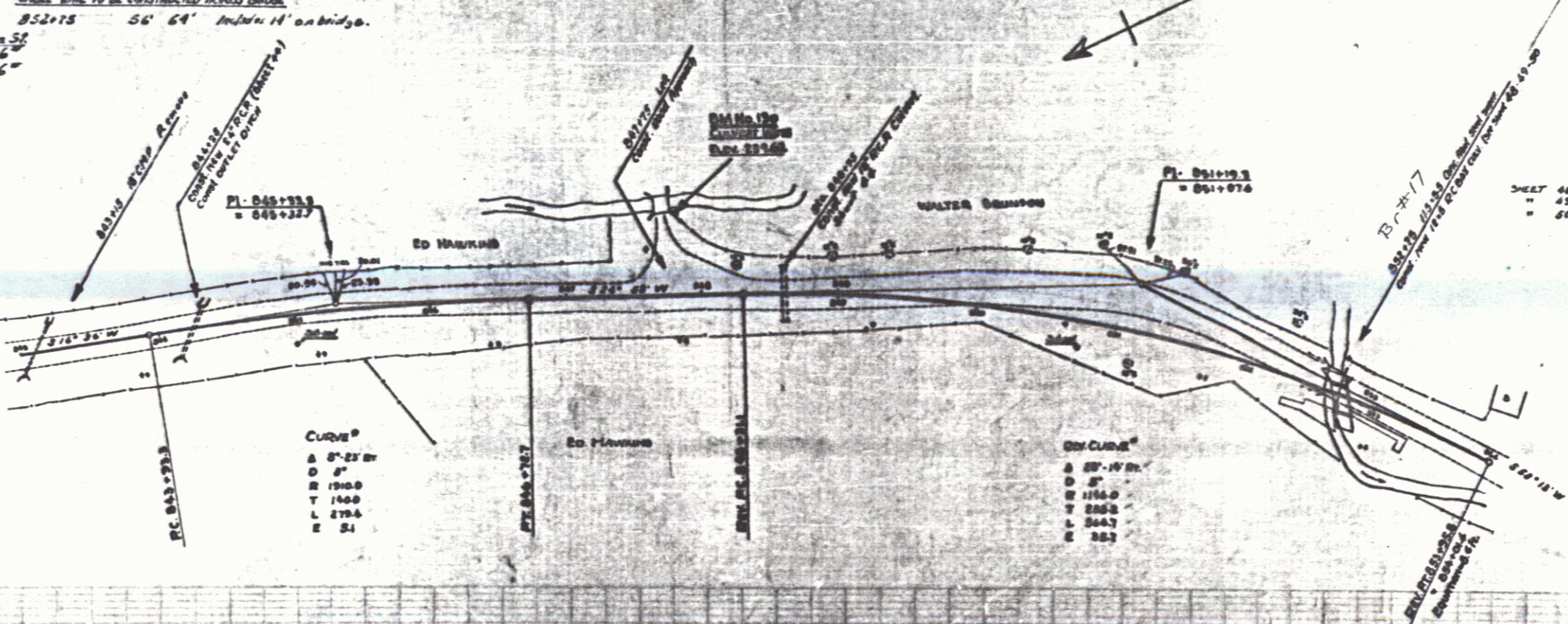

**BRIDGE No. 852+75**

**SHEETS TO BE USED**

- SHEET 48 - DETAILS OF 12" X 12" BOX CURB
- SHEET 49 - DETAILS OF 12" X 12" TYPICAL CURB
- SHEET 50 - DETAILS OF 12" X 12" TYPICAL CURB
- SHEET 51 - DETAILS OF 12" X 12" TYPICAL CURB

**SUPPLY OF QUANTITIES**

ITEM	QUANTITY	UNIT
ITEM No 15 STRUCTURE EXCAVATION	100	CU YD
ITEM No 314 CLASS A CONCRETE	100	CU YD
ITEM No 34 REINFORCING STEEL	100	TONS
ITEM No 67 CABLE GUANO DIMS	100	TONS

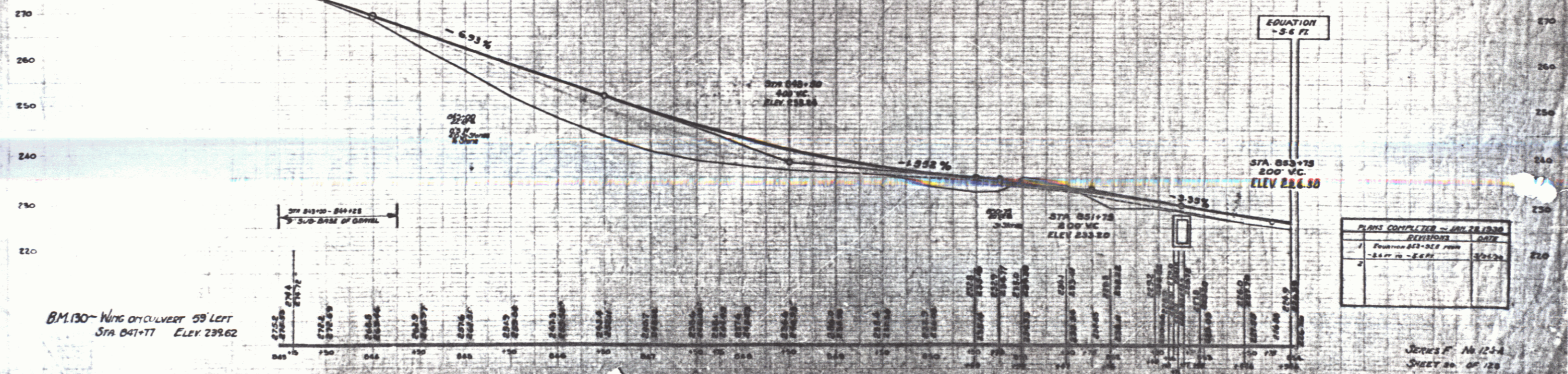

BM. 130 - Wing on culvert 59' Left  
Sta 847+77 Elev 239.62

**PLANS COMPLETED - JAN. 28, 1956**

REVISION	DATE
1	1/28/56
2	2/2/56

JERRY W. Mc 124-A  
SHEET 20 OF 128