

WOOD GUANO ENL. REQUIRED

STATION	LEFT	RIGHT
783+37	24'	24'
783+60	24'	24'
783+87	-	24'
783+90	-	24'

CRUDE GUANO ENL. REQUIRED

STATION	LEFT	RIGHT
784+46-784+50	300'	-
784+50-784+50	241'	-
784+51-784+74	329'	-
784+85-784+90	107'	-

NEW 8" DIA. CONCRETE PIPE CULVERTS REQUIRED

STATION	DIPS	LEN	CONC.	CONC.	CONC.	CONC.	CONC.	CONC.	CONC.
783+27	18"	24'	12"	12"	12"	12"	12"	12"	12"
783+60	24"	24'	12"	12"	12"	12"	12"	12"	12"
783+87	18"	60'	30"	-	34"	34"	34"	34"	34"

GRADED COBBLE GUTTER ROAD

STATION	PI	W/TH	AREA
783+25-783+13	RY	4'	0.13
783+64-783+50	RY	4'	3.32

CONCRETE PIPE CULVERTS REQUIRED

STATION	PI	W/TH	AREA
783+25-783+13	RY	4'	0.13
783+64-783+50	RY	4'	3.32

STANDARD UNDERDRAIN WITH FIT LAY PIPE

STATION	PI	AREA
783+25-783+25	RY	1.35
783+15-783+14	RY	2.25
783+24-783+50	RY	2.26

RIPRAP FOR BANK PROTECTION

Sta. 783+60
 P.I. 8100
 3 cy

CEMENT RIBBLE MASONRY RET. WALL

Station 784+10-785+74
 P.I. GRB
 43 cy

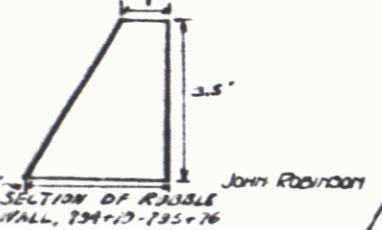

METAL DISK INLETS USED

Sta.	DI	Grnd.	12" CONC. P.	18" CONC. P.	24" CONC. P.
784+20	1	1	12" (new)	4'	26"
784+30	1	1	12" (new)	4'	26"

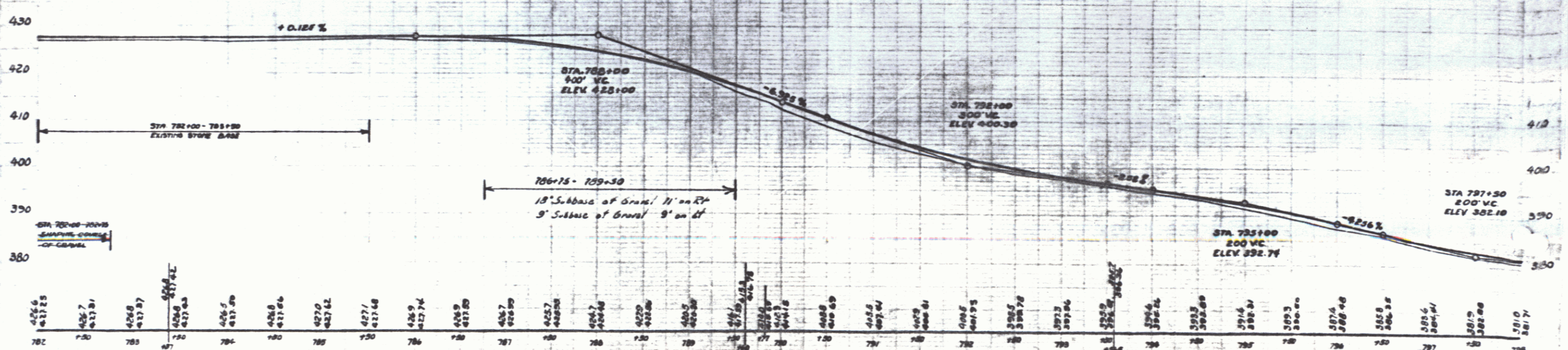
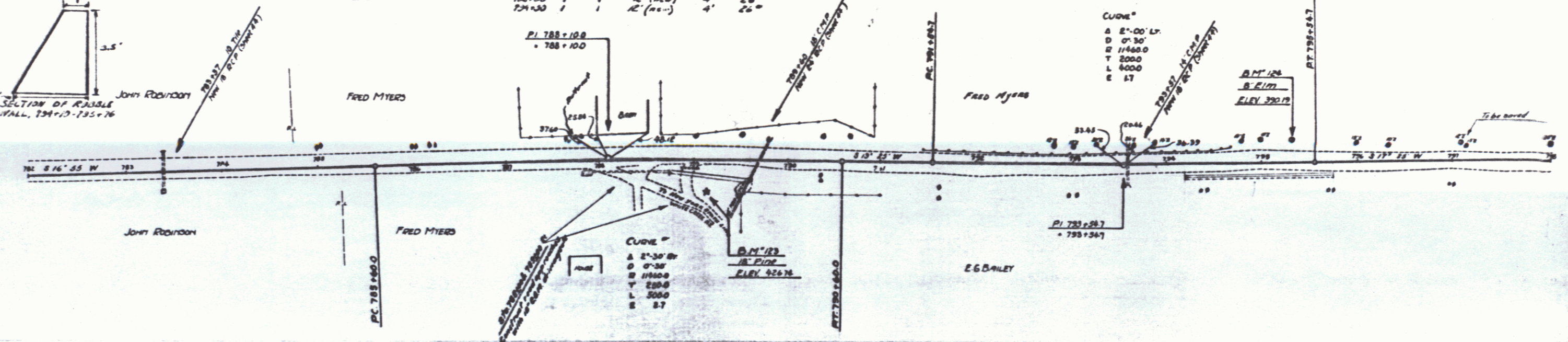

B.M. 123 Spike in root of 18" Pine, 33 ft. rt. of Sta 783+13 - Elev. 426.74
 B.M. 124 Spike in trunk on bankside of E. Elm, 20' L. of Sta. 795+09 - Elev. 390.19