

WOOD BRIDGE OVER CULVERT

CHASSIS SPAN	LEFT	RIGHT
703+83	24'	24'
709+85	24'	24'

WOOD BRIDGE POSTS REQUIRED

SPACING	LEFT	RIGHT
10'-0"	1	1
12'-0"	1	1

NEW CURB DETAILS FOR CULVERTS

STATION	TYPE	SPACING	HEIGHT	WIDTH	THICKNESS
703+83	18" CHERRY	10'	12"	12"	4"
709+85	18" CHERRY	10'	12"	12"	4"

DRIVEWAY PIPE CULVERTS

STA	Dir.	Dia.	Length	CBM	COMP	Notes
703+75	R	18"	15'	2.7 cu	12"	COMP 12"
707+70	R	18"	15'	2.7 cu	12"	"
714+15	R	18"	15'	2.0 cu	12"	"
717+10	L	12"	40'	1.9	12"	"

MISSOURI STATE HIGHWAY DEPARTMENT
 DIST. NO. 125-A 1922 E 1

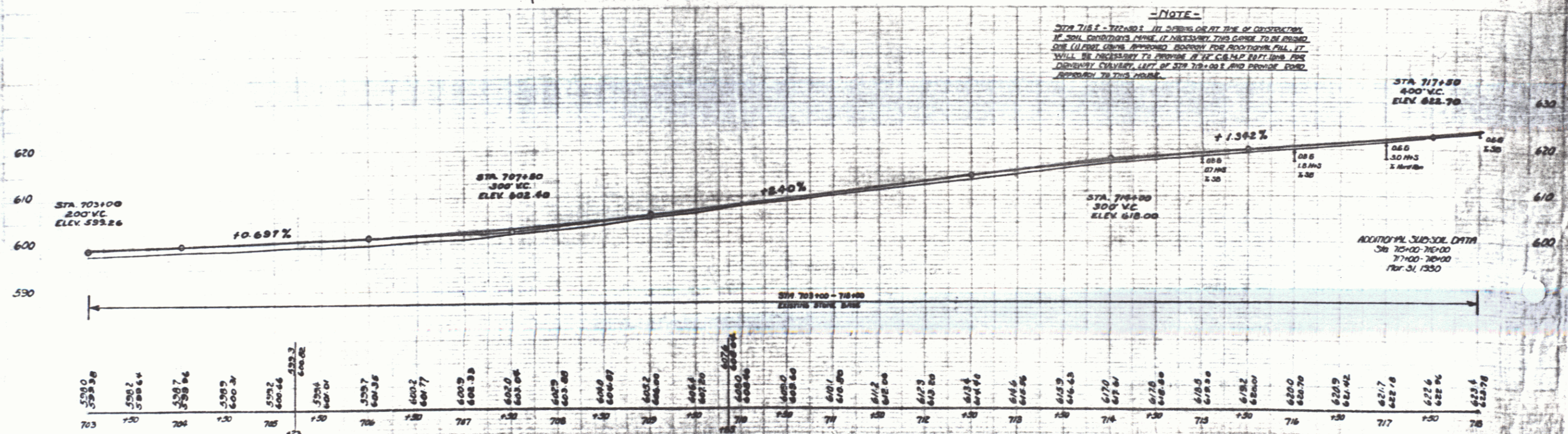
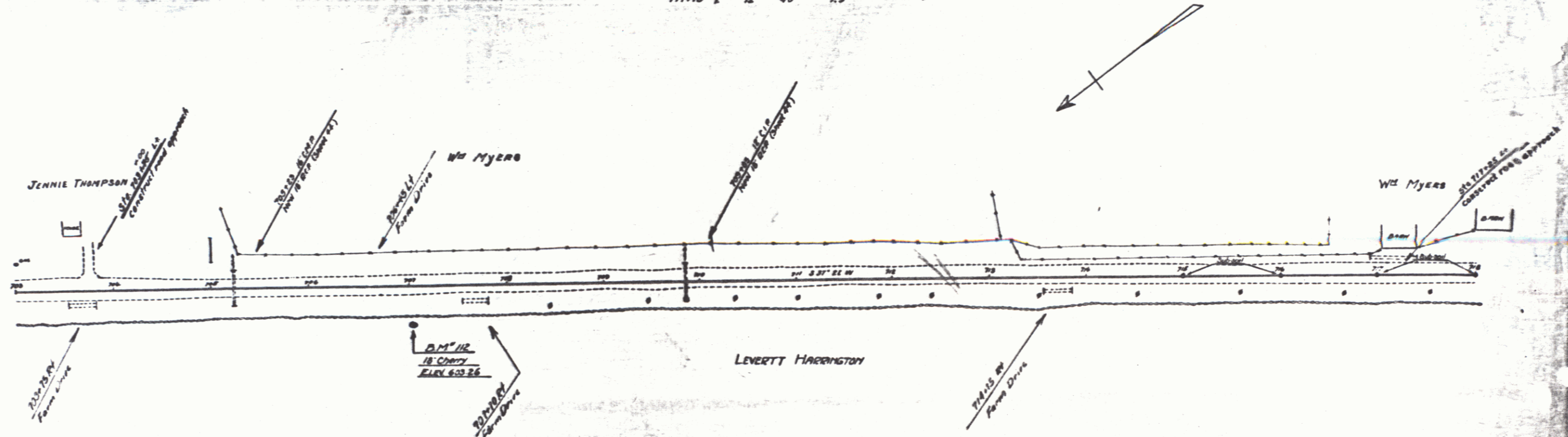

NOTE
 STA 718 - 717+80: IN ORDER AT TIME OF CONSTRUCTION, IF SOIL CONDITIONS WERE IT NECESSARY THIS CURVE TO BE ADJUSTED ONE (1) FOOT LOWER. APPROVED FOR ROADWAY, P.M. 11-17-22. WILL BE NECESSARY TO PROVIDE A 12" C.M.P. ELEVATION FOR DRIVEWAY CULVERT, LEFT OF STA 703+00 AND PROVIDE ROAD DEPENDENT TO THIS POINT.

B.M. 112 Spike in Root of 'B' Cherry, 30' BY STA 707+10 - ELEV 603.26
 B.M. 113 PRINT SPOT ON LEDE BY STA 707+10 - ELEV 603.26

SERIES F 10 100-A
 SHEET (E) OF 120