

VIDEO BURIED CABLE REQUIRED

CABLE STATION	LEFT	RIGHT
526+00	24'	24'
529+25	24'	24'

CABLE BURIED CABLE REQUIRED

STATION	LEFT	RIGHT
529+00-529+75	24'	20'
529+75-529+85	-	20'
529+85-529+90	25'	25'
529+90-529+95	25'	-

CONCRETE PIPE CEMENTS REQUIRED

STATION	NO.	DO.	NO. FEET	QTY.
529+00	2	14"	18	2.5

INTERNAL CURB USED

STATION	HT.	LENGTH
529+00-529+25	2"	250'
529+25-529+40	2"	150'
529+40-529+50	2"	100'

NEW GRADE CONCRETE PIPE CEMENTS REQUIRED

STATION	NO.	DO.	NO. FEET	QTY.
529+00	24"	14"	18	2.5
529+00	24"	18"	18	4.0

GRADED COBBLE BUTTER REQUIRED

STATION	LONG.	WIDTH	DEPTH	AREA
529+00-529+05	5'-0"	12'-0"	1'-0"	60.0
529+05-529+10	5'-0"	12'-0"	1'-0"	60.0
529+10-529+15	5'-0"	12'-0"	1'-0"	60.0
529+15-529+20	5'-0"	12'-0"	1'-0"	60.0
529+20-529+25	5'-0"	12'-0"	1'-0"	60.0
529+25-529+30	5'-0"	12'-0"	1'-0"	60.0
529+30-529+35	5'-0"	12'-0"	1'-0"	60.0
529+35-529+40	5'-0"	12'-0"	1'-0"	60.0
529+40-529+45	5'-0"	12'-0"	1'-0"	60.0
529+45-529+50	5'-0"	12'-0"	1'-0"	60.0
529+50-529+55	5'-0"	12'-0"	1'-0"	60.0
529+55-529+60	5'-0"	12'-0"	1'-0"	60.0
529+60-529+65	5'-0"	12'-0"	1'-0"	60.0
529+65-529+70	5'-0"	12'-0"	1'-0"	60.0
529+70-529+75	5'-0"	12'-0"	1'-0"	60.0
529+75-529+80	5'-0"	12'-0"	1'-0"	60.0
529+80-529+85	5'-0"	12'-0"	1'-0"	60.0
529+85-529+90	5'-0"	12'-0"	1'-0"	60.0
529+90-529+95	5'-0"	12'-0"	1'-0"	60.0
529+95-529+00	5'-0"	12'-0"	1'-0"	60.0

RIMPAP FOR BANK PROTECTION

STATION	POS.	LENGTH	W.D.
5262	R	11	14.0

PL. MAP STATE PROJ. NO. YEAR NO. SHEETS
 8 VT 124-N 1930 8 122

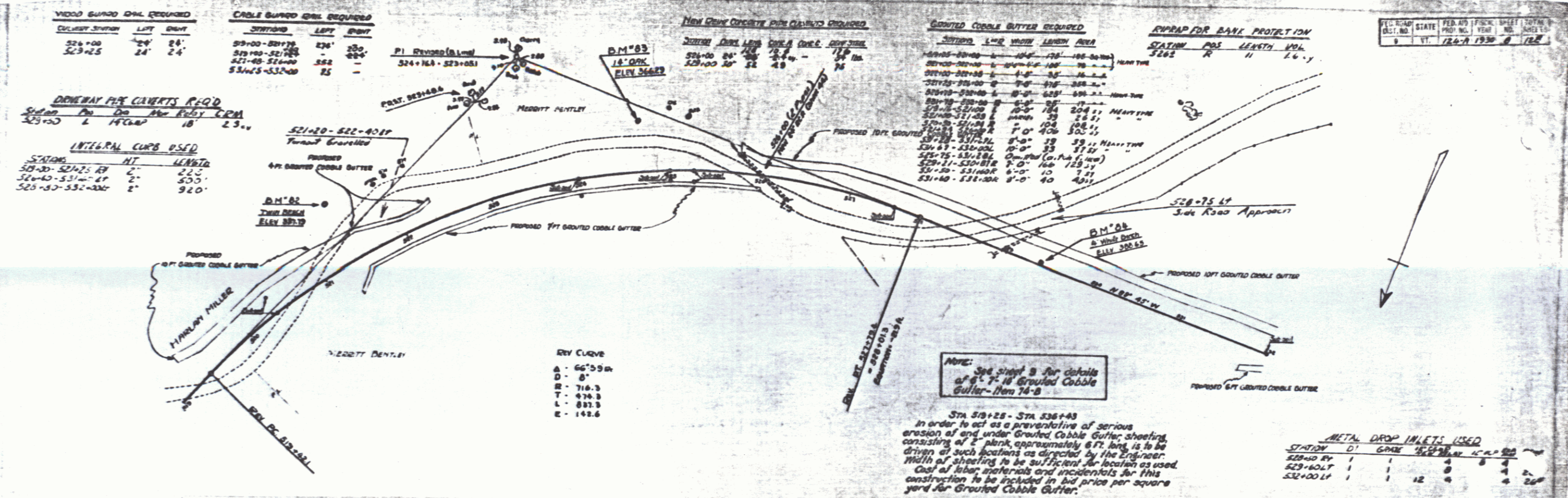

NOTE: See sheet 8 for details of 6" x 7" x 18" Grouted Cobble Gutter - Item 14-B

Sta 529+25 - Sta 529+45
 In order to act as a preventative of serious erosion of and under Grouted Cobble Gutters, sheeting consisting of 2" plank, approximately 6 ft. long, is to be driven at such locations as directed by the Engineer. Width of sheeting to be sufficient for location as used. Cost of labor, materials and incidentals for this construction to be included in bid price per square yard for Grouted Cobble Gutter.

METAL DROP INLETS USED

STATION	D'	GRADE	SIZE	NO.	QTY.
529+40	1	1	12	4	4
529+60	1	1	12	4	4
529+00	1	1	12	4	4

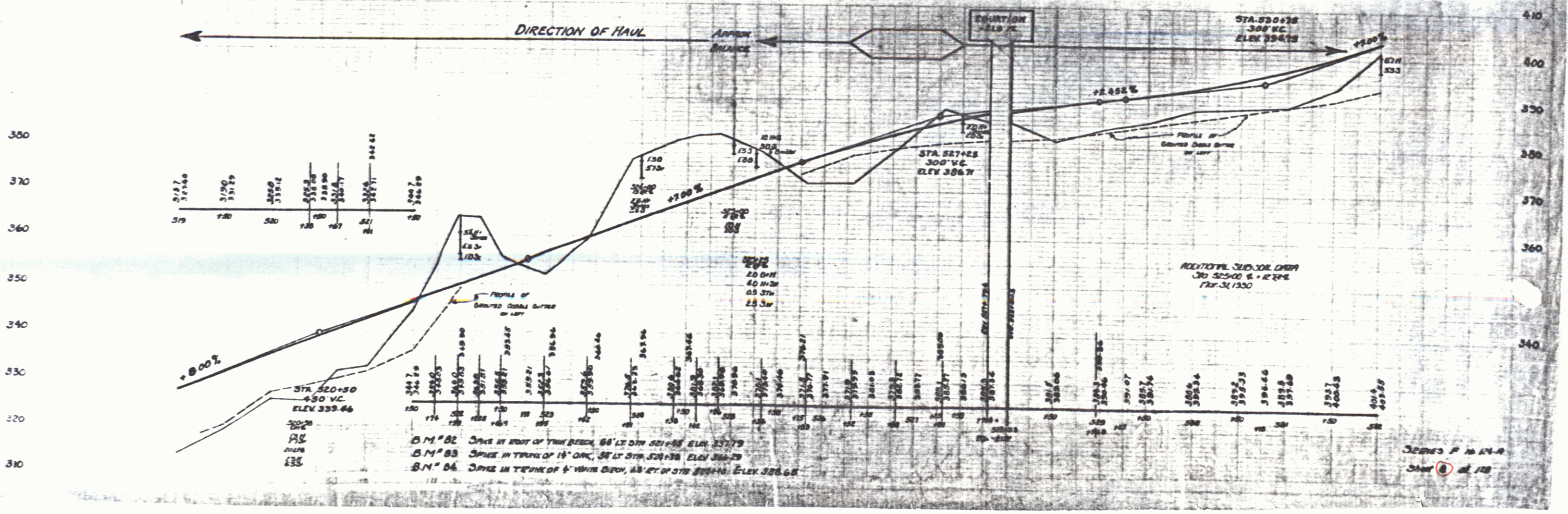

B.M. 82 Spike in root of tree trunk, 64' LT STA 529+85 ELEV. 357.79
 B.M. 83 Spike in trunk of 16" Oak, 58' LT STA 529+38 ELEV. 356.29
 B.M. 84 Spike in trunk of 4" White Birch, 43' ET OF STA 529+46 ELEV. 358.68

James P. McLaughlin
 Chief Engineer

6