

INTERVAL CURS USED

STATIONS	HT	LENGTH
514+00-515+00	2"	230'
515+00-516+00	2"	320'
516+00-517+00	2"	175'

METAL DRIP INLETS USED

STATION	DI	GRATE	12" DIA	12" DIA	4" DIA	REIN. ST
50+30.1	1	1	12"	4"	4"	26 lb
50+50.1	1	1	12"	4"	4"	26 "
50+70.1	1	1	12"	4"	4"	26 "
50+90.1	1	1	12"	4"	4"	26 "
51+20.1	1	1	12"	4"	4"	26 "

CABLE GUARD CHAIN REQUIRED

STATIONS	LEFT	RIGHT
511+00-512+00	304'	
512+00-513+00	342'	
513+00-514+00	342'	
514+00-515+00	388'	
515+00-516+00	348'	293'

NEW DEEP CONCRETE BOX CULVERTS REQUIRED

STATION	SIZE	DEPT	DEPT	DEPT	DEPT
514+00	4x4	200 cy	1900 lbs		
		30.9	2219		

GRAVEL COBBLE CUTTER REQUIRED

STATIONS	LEAD	WIDTH	LENGTH	AREA
50+00-50+00	4'-0"	8'-0"	107'-0"	
50+00-50+00	4'-0"	8'-0"	800'-0"	
50+00-50+00	4'-0"	8'-0"	120'-0"	
50+00-50+00	4'-0"	8'-0"	283'-12"	
50+00-50+00	4'-0"	8'-0"	204'-0"	

STATE ROAD DISTRICT NO. 1
 DISTRICT ENGINEER
 124-A 1930 7 428

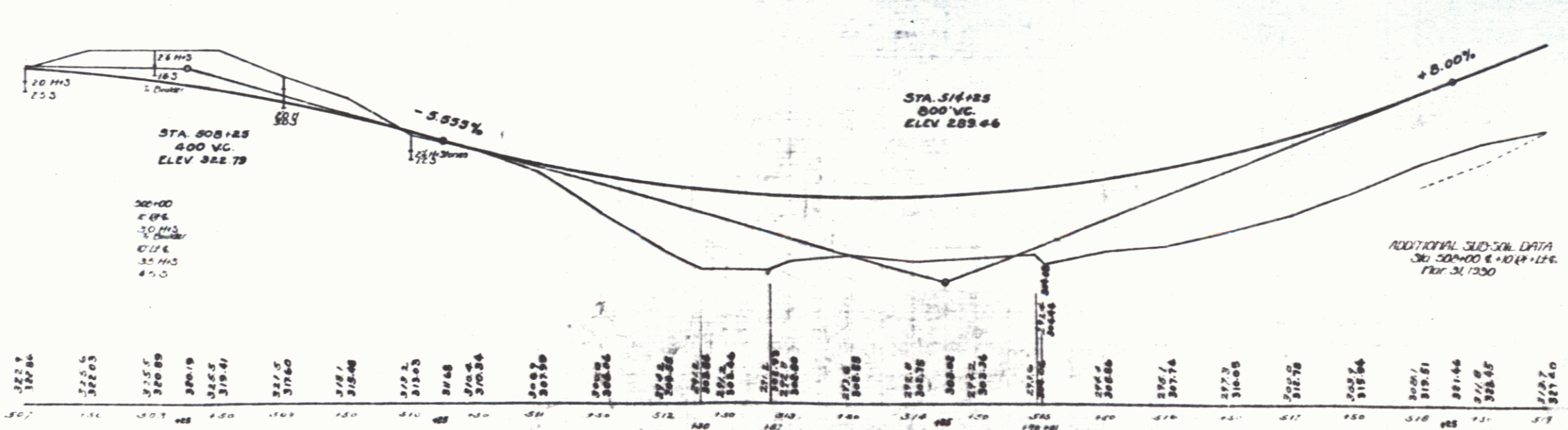
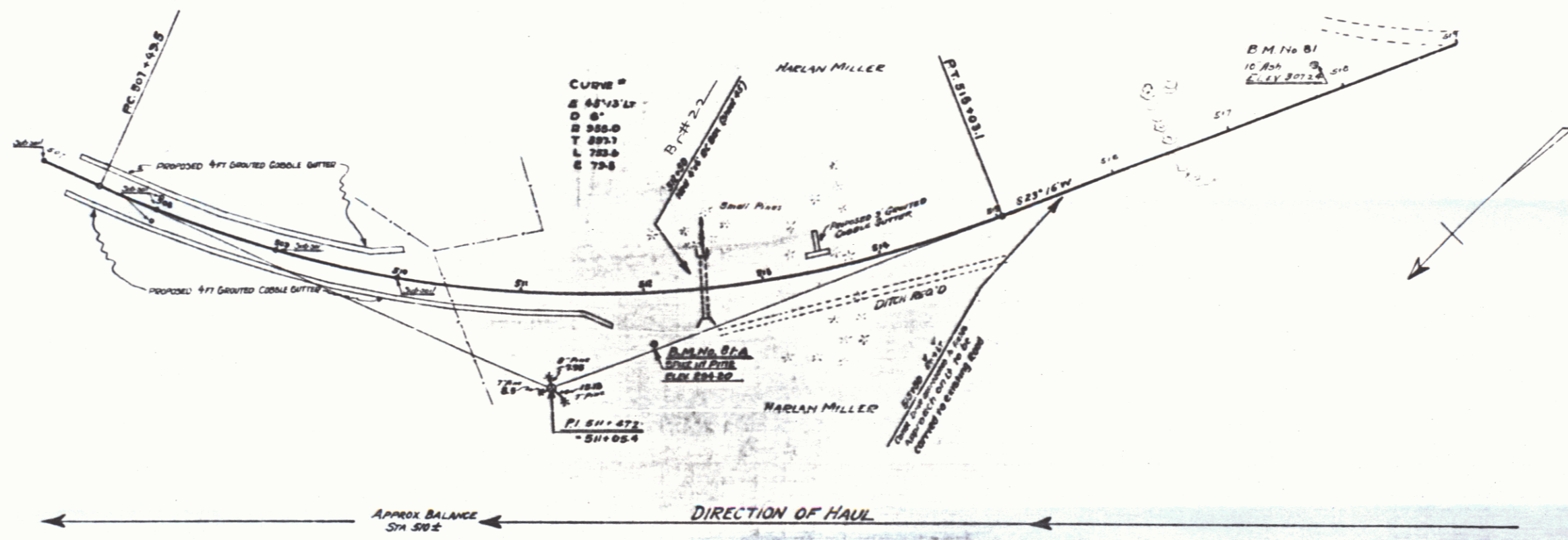

B.M. #1 CURVE IN LINE OF 10' ASPH 15' FT. OF STA. 517+00 - ELEV. 307.06
 B.M. #2 B/A SPIKE IN TRUNK OF PINE RIGHT OF STA. 512+00 ELEV. 294.80

DESIGNED BY
 CHECKED BY
 SHEET NO. 128