

WOOD GUARD RAIL REQUIRED

| CUVERT STATION | LEFT | RIGHT |
|----------------|------|-------|
| 482+50 | 24 | 24 |
| 489+99 | 24 | 24 |
| 491+50 | 24 | 24 |

CRIBLE GUARD RAIL REQUIRED

| STATIONING | LEFT | RIGHT |
|---------------|------|-------|
| 489+99-491+50 | 24 | 24 |

NEW CONCRETE PIPE CULVERTS REQUIRED

| STATIONING | DIAM. | LENG. | CONC. P. | CONC. R. | REIN. STEEL |
|------------|-------|-------|----------|----------|--------------|
| 487+50 | 15" | 280' | 40 | | 2.5 cy 33 lb |

NEW CONCRETE BOX CULVERTS REQUIRED

| STATIONING | SIZE | CONC. P. | CONC. R. | REIN. STEEL |
|------------|-------|----------|----------|-------------|
| 491+50 | 4'x4' | 22.2 | 22.2 | 2.232 lb |
| +50 | | 22.4 | 22.9 | |

GRAVELLED CABLE GUTTER REQUIRED
STATION FROM FROM FROM
489+99 3-6 11-9-10

INTEGRAL CURB USED
STA-STA P.D. HEIGHT LENGTH
492+50-494+00 RT 2" 150'

METAL D.W.P. INLETS USED
Sta DI GRATE 12" x 12" 12" VCP EXPOSED REIN. STEEL
492+50 RT 1 6' 8" 4' 2"

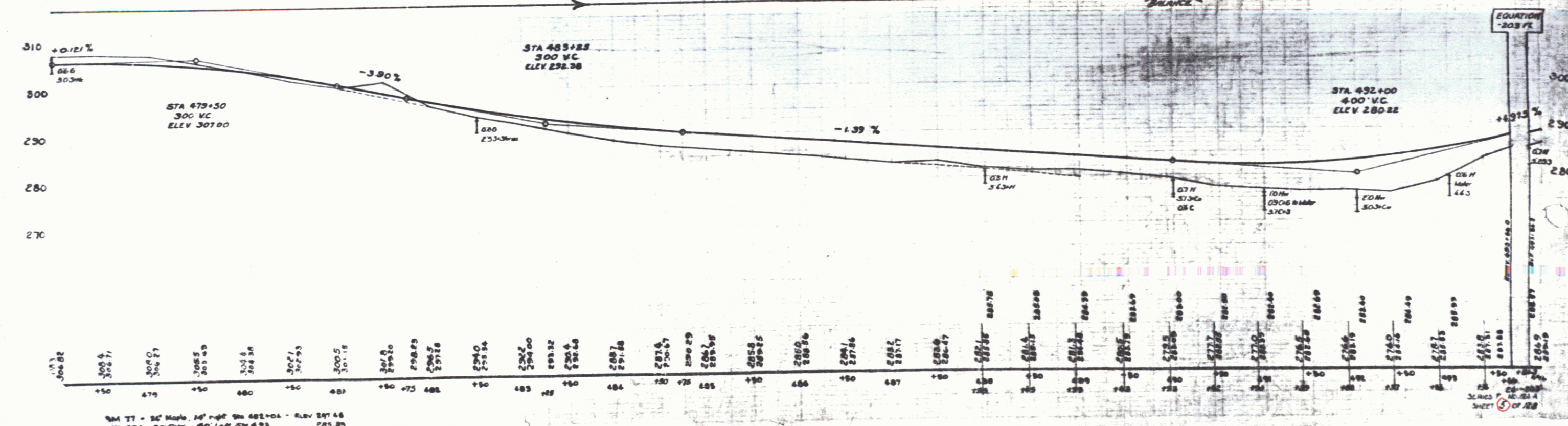
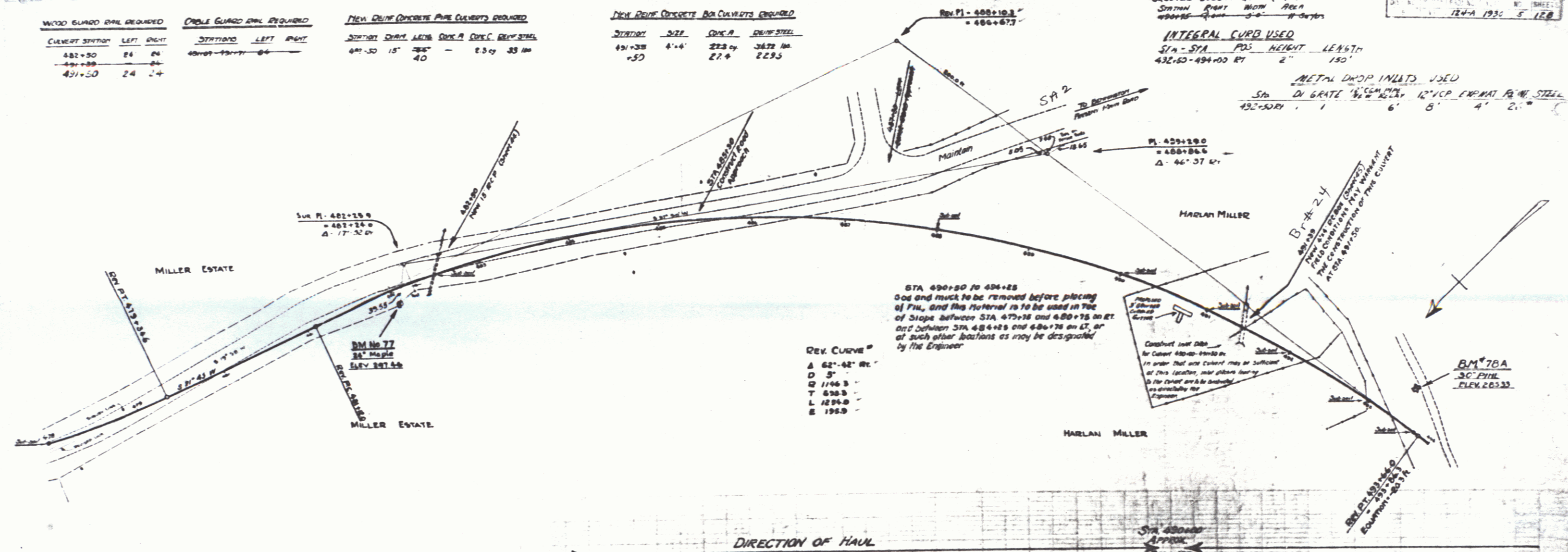

BM 77 - 30' Maple 12' x 12" 5m 482+04 - Elev. 297.46
BM 78A - 30' Pine 40' 10" 5m 493 - Elev. 283.32