

WOOD GUARD RAIL REQUIRED

CONCRETE SPACING	LEFT	RIGHT
445 + 75	26'	24'
475 + 00	26'	24'

NEW RENT CONCRETE PIPE CULVERTS REQUIRED

STATION	LENGTH	DIAMETER	REMARKS
468+00	15' 36"	18"	2.4

DRIVEWAY PIPE CULVERTS REQUIRED

STA	POS	DIA	REMARKS
467+0	R	18" 16"	1.4-1.7

STATE OF VERMONT
12-A 1930 4 128

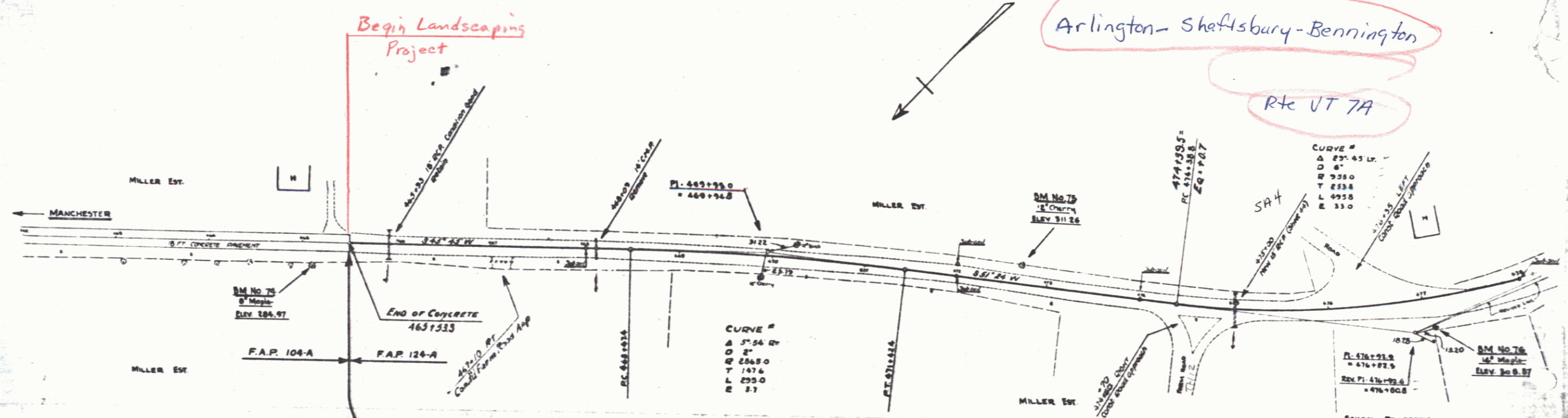

SUB-SOIL CLASSIFICATION

- Mudstone M
- Ordred G
- Sand S
- Silt Ss
- Clay C
- Quicksand Q
- Ledge L

LEGEND

- Dry D Fine F
- Moist M Coarse C
- Wet W Hard Packed HP

Date of Investigation
Oct. 9 - Oct. 17
Dec. 3-4, 1923

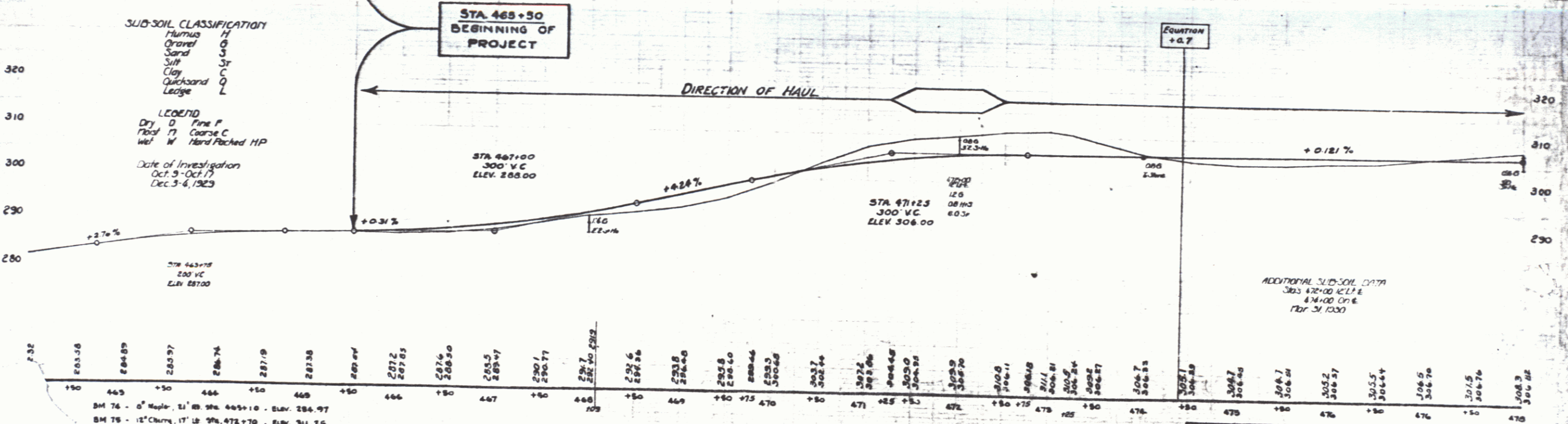

PLANS COMPLETED	DATE
END OF CONCRETE R.A.P.	4/1/30
474+38.2 - 474+88.8	4/1/30
474+88.8 - 474+100.0	4/3/30

Series F No. 174-A
Sheet 1 of 128

Project No. F 134A

1/1/30