

STATE OF VERMONT DEPARTMENT OF HIGHWAYS PROPOSED IMPROVEMENT

TOWN OF BENNINGTON

COUNTY OF BENNINGTON
US ROUTE 7 CONN.

ROW PLANS

Pin# 9910764

LENGTH OF PROJECT - 3,765 FEET = 0.713 MILES

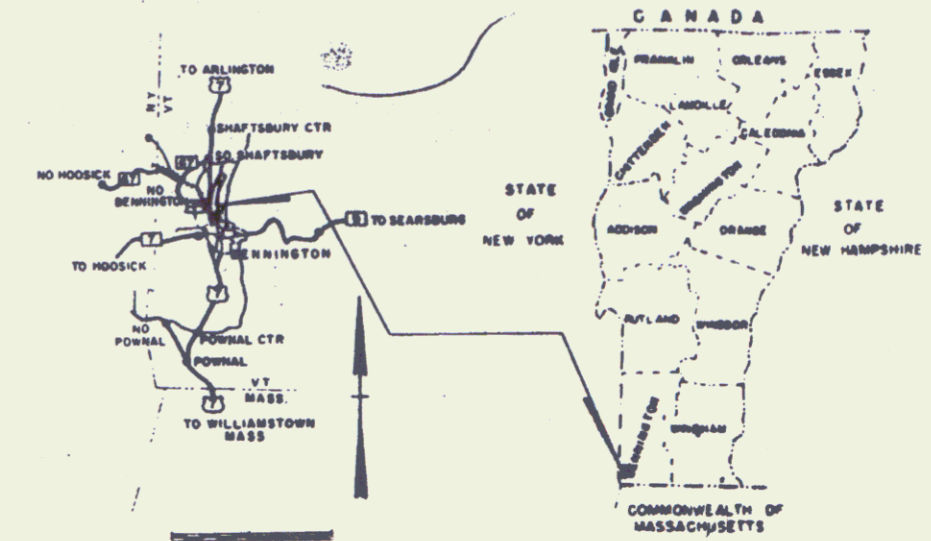

End Project on VT 7A
STA 34+80 MP 0.280

BEGIN ROW PROJ. F 219-1(7)
STA. 9+00

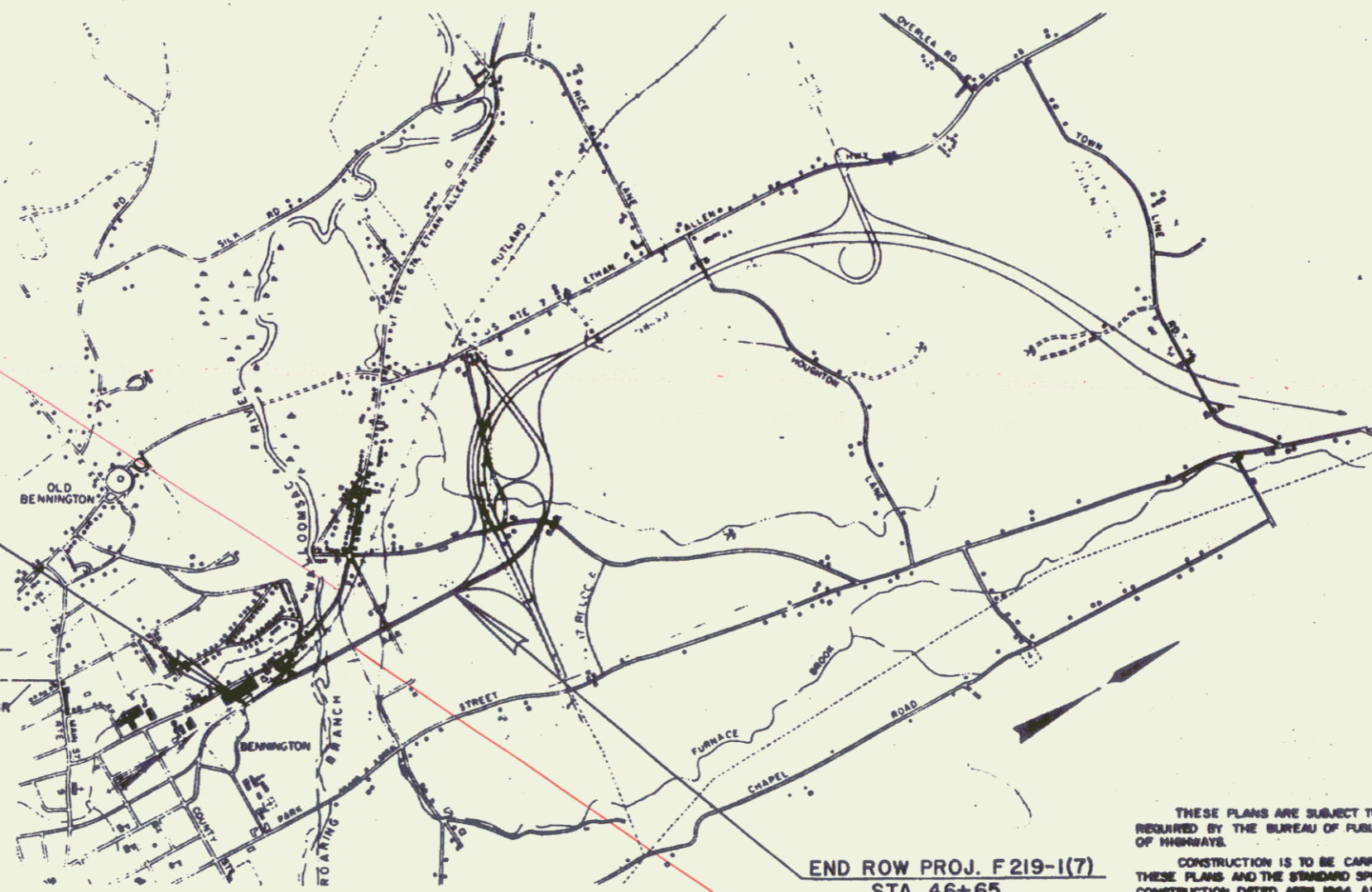
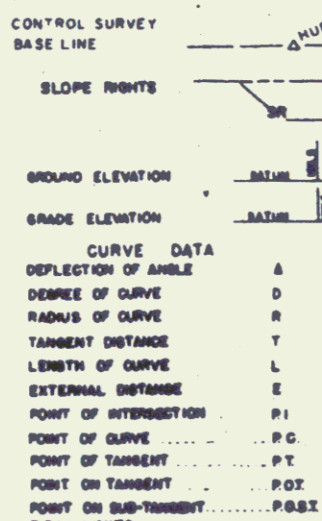
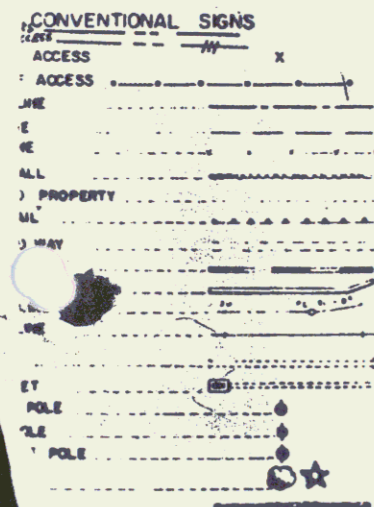

END ROW PROJ. F 219-1(7)
STA. 46+65

Begin VT 7A
STA 20+00 MP 0.00



RIGHT-OF-WAY DIVISION
TOWN FILE

PERPETUAL

Per of VT 7A L.A.

(To Be Returned To R.O.W. Division)

F-219-1(7)

THESE PLANS ARE SUBJECT TO SUCH REVISIONS AS MAY BE REQUIRED BY THE BUREAU OF PUBLIC ROADS OR THE COMMISSIONER OF HIGHWAYS.
CONSTRUCTION IS TO BE CARRIED ON IN ACCORDANCE WITH THESE PLANS AND THE STANDARD SPECIFICATIONS FOR HIGHWAY AND BRIDGE CONSTRUCTION DATED APRIL, 1964, AS APPROVED BY THE BUREAU OF PUBLIC ROADS ON OCTOBER 15, 1964, INCLUDING ALL SUBSEQUENT APPROVED REVISIONS AND SUCH REVISED SPECIFICATIONS AND SPECIAL PROVISIONS AS ARE INCORPORATED IN THESE PLANS.

DEPARTMENT OF COMMERCE
BUREAU OF PUBLIC ROADS
APPROVED
DIVISION ENGINEER
PROJECT F 219-1(7)
SHEET 1 OF 17 SHEETS

APPROVED ROW DIRECTOR DATE 5-16-70	APPROVED DISTRICT ENGINEER DATE 5/26/70	APPROVED CONSTRUCTION ENGINEER DATE 26 May 70	APPROVED GRADE ENGINEER DATE 5/26/70	APPROVED DESIGN ENGINEER DATE 5/26/70	APPROVED ASST. DIV. ENGINEER DATE 5/26/70	APPROVED ENGINEER DATE 5/26/70
--	---	---	--	---	---	--------------------------------------

STATE OF VERMONT
DEPARTMENT OF HIGHWAYS
RIGHT-OF-WAY PLANS
ALPHABETICAL INDEX

GRANTOR	SHEET NO.	PARCEL NO.
A		
B		
BENNINGTON SCHOOL DISTRICT INC.	9,12	12
BIJUR LUBRICATING CORP.	10	5
BOARD OF CHURCH EXTENSION & HOME MISSIONS OF THE CHURCH OF GOD	11	10 & 13
C		
CHARLESTOWN MILLS STORE OF BENNINGTON INC. (LESSEE)	11	10
D		
E		

GRANTOR	SHEET NO.	PARCEL NO.
F		
G		
GREENBERG, NORMAN H.	8	2
H		
I		
J		

GRANTOR	SHEET NO.	PARCEL NO.
K		
L		
M		
MOORE, HOWARD W. & AUXILLIA W.	11	9
N		
NORTHERN TERMINALS INC.	11	8
O		

GRANTOR	SHEET NO.	PARCEL NO.
P		
PETTENGILL, NED H.	11	7
Q		
R		
	8,11	4
S		
STATE OF VERMONT (VERMONT PUBLIC SERVICE BOARD)	8,11	4
T		
TATRO, RAYMOND E. & MARGARET	10	6
TOWN OF BENNINGTON	9	11
TRUSTEES OF THE SOLDIERS HOME IN VERMONT	8	1

GRANTOR	SHEET NO.	PARCEL NO.
U		
V		
VERMONT RAILWAY, INC. (LESSEE) VILLAGE OF BENNINGTON	8,11 8	4 14
W		
WILKINSON, CHARLES M.	8-11	3
X		
Y		
Z		

MADE BY: FRP DATE 3-27-70
CHECKED BY: LWB DATE 3-30-70

PROJECT: BENNINGTON
NO. F 219-1(7)
SHEET 4 OF 17

2

STATE OF VERMONT
DEPARTMENT OF HIGHWAYS
RIGHT-OF-WAY PLANS
DETAIL SHEET
1 OF 3

TABLE OF PROJECT PROPERTY ACQUISITION

PARCEL NO.	GRANTOR	SHEET NO.	BEGINNING STATION	ENDING STATION	TAKING	REM.	RIGHTS	TITLE TAKEN	DATE	TOWN OR CITY RECORDED	BK.	PG.	REMARKS	
1	THE TRUSTEES OF THE SOLDIERS HOME IN VERMONT	8	9+00 CL	24+12 LT.	5.6 A±	89.4A±							0.12 A± VILLAGE OF BENN. EASE	
		8	15+65 LT.										SIGN	
2	GREENBERG, NORMAN H.	8	18+60 RT	21+60 RT.			CHANNEL (P) 0.35 A±							
		8	9+00 CL	5+97 LT.	1.0A±	0.9A±							0.16A± VILLAGE OF BENN. EASE.	
		8	11+00 LT.										SIGN	
		8	12+77 LT.										SIGN	
		8	12+77 LT.										SIGN	
		8	14+35 LT.										SIGN	
3A	WILKINSON, CHARLES M.	8-11	RT 7 CONN. 21+42 RT.	RT 7 CONN. 34+98 CL	11.3 A±				WD 3/11/70	BENNINGTON	0-189	54	ADVANCE ACQ. UNDER PROJ. OF 219-1(2)	
		8-11	RT 7 CONN. 33+86 LT.	RT 7 CONN. 34+17 LT.			CHANNEL (P) 4.50 S.F.							
3B		10	T.R. 28 REL. 6+77 CL	T.R. 28 REL. 16+00 CL	2.2 A±									
		10	T.R. 28 REL. 9+50 LT.	T.R. 28 REL. 13+65 LT.			CHANNEL (P) 7600 S.F.							
		10	TR 28 REL. 13+63 RT	TR 28 REL. 14+06 RT.			CHANNEL (P) 1200 S.F.							
		10	T.R. 28 REL. 14+75 LT.				DRIVE (T)							
		10	TR 28 REL. 14+75 RT.				DRIVE (T)							
		10	RT. 7 CONN. 21+42 RT.	T.R. 28 REL. 6+77 LT.			34.2 A±							
		10	T.R. 28 REL. 25+85 RT.	RT. 7 CONN. 34+98 LT.			5.8 A±							
		10	KOCHER DR. 12+00 CL	RT. 7 CONN. 34+98 RT.			12.2 A±							
		10												
		10												
4A	STATE OF VERMONT (VERMONT PUBLIC SERVICE BOARD) LESSOR	8	15+02 LT.	21+03 LT.	0.4 A±	N/A	REMOVE PAVEMENT (T)						1100 S.F. VILLAGE OF BENN. EASE.	
4B	VERMONT RAILWAY INC. (LESSEE)	11	15+97 LT.	21+03 LT.			CROSSING EASEMENT (P)							
		11	24+00 LT.	28+21 RT.										
			24+48 LT.	26+08 RT.			CULVERT (P)							
			27+25 RT.				DRAINAGE (P)							
			17+50 LT.										BILLBOARD	

TABLE OF REVISIONS

REVISION NO.	SHEET NO.	DESCRIPTION OF REVISION	DATE	MADE BY	APPROVED BY
1	8	Parcel #1 Added channel rights to this parcel between stations 18+60 Rt. & 21+60 Rt., Per change order #1597	6-23-70	RWS	
2	8	Parcel #1 Change Of Sign Locations And Location Of Additional Signs Per Change Order #1606	7-23-70	ALL	T.P.M.
3	6, 11, 14, 1	Parcel #7 Reduce take by 0.4 A±. Revised R.O.W. plans. Per Change Order #1654	8-27-70	K.M.D.	T.P.M.
4	11	Parcel #7 Reduced remainder from 0.4 A to 0.16 A due to change in property line, Per Change Order #1679	9-17-70	RWS	T.P.M.

LEGEND

NBB	DATE 3-26-70	PRESENT R.O.W.	SR	SR	SLOPE RIGHTS
LWB	DATE 3-26-70	TAKING WITHOUT ACCESS	---	---	PROPERTY LINE
		TAKING WITHOUT ACCESS ALONG PROPERTY LINE	---	---	TOP OF CUT
		TAKING WITH ACCESS	---	---	THEIR SLOPE
		PERMANENT TAKE	---	---	

APPROVED: *Thomas J. Mayo* DATE 5-26-70
CHIEF OF ACQUISITION

APPROVED: *G. M. Lane* DATE 5-26-70
HIGHWAY ENGINEER

APPROVED: *Blaine J. Jenkins* DATE 5-26-70
STATE JURIST

PROJECT BENNINGTON
NO. F 219-1(7)
SHEET 5 OF 17

STATE OF VERMONT
DEPARTMENT OF HIGHWAYS
RIGHT-OF-WAY PLANS
DETAIL SHEET
2 OF 3

TABLE OF PROJECT PROPERTY ACQUISITION

NO.	GRANTOR	FEET NO.	BEGINNING STATION	ENDING STATION	AREA AC.	REMARKS	DATE TAKEN	DATE	TOWN OR CITY RECORDED	BK.	PG.	REMARKS
5	BIJUR LUBRICATING CORP.	10	5+50 C.	12+00 C.	0.4A±	28.6A±						0.14A± TOWN OF BENN. EASE.
6	TATRO, RAYMOND E. & MARGARET M. (H & W)	10	5+50 C.	6+77 C.	3800 SQFT	1.5 A±						1800 S.F.± TOWN OF BENN. EASE.
7	PETTENGILL, NED H. (PETCO OIL CO.) (A & W - WARREN C. JENSEN) (BENNINGTON DAIRY QUEEN)	II	25+00 LT. 32+07 RT. 28+06 C. 28+38 C. 28+46 RT. 29+00 RT. 28+02 RT. 28+73 RT.	32+19 RT. 2 2 2 2 2	1.3A±	0.16A±						ALL R.T. & I. TO SHED GAS PUMPS & ISLAND GAS PUMPS & ISLAND GAS STATION GAS PUMPS & ISLAND UNDERGROUND GAS TANKS SIGN CARPORT BUILDING CARPORT SIGN BUILDING
8	NORTHERN TERMINALS INC.	II	34+02 RT. 32+56 RT. 32+07 RT. 32+07 RT. 32+25 RT.	34+79 LT. 650 SQ.FT. 32+56 RT. 32+07 RT. 32+07 RT. 32+25 RT.	0.3A±							90S.F.± VERMONT STATE EASE. 600 S.F.± TOWN OF BENN. EASE. GAS PUMP APRON REMOVE SHED (T) ALL R.T. & I. TO SHED
9	MOORE, HOWARD W. & AUXILLIA W. (H & W)	II	34+15 RT.	34+91 RT.	3400 SQFT	0.6A±						1750 S.F.± TOWN OF BENN. EASE 650 S.F.± VERMONT ST. EASE.
10	THE BOARD OF CHURCH EXTENSION & HOME MISSIONS OF THE CHURCH OF GOD (LESSOR) CHARLESTOWN MILLS STORE OF BENNINGTON INC. (LESSEE)	II	34+00 LT. 33+02 LT. 33+79 LT. 34+55 LT.	34+77 LT. 34+04 LT.	2900 SQ.FT.	0.4A±						900 S.F.± TOWN OF BENN. EASE. SLOPE 1400 S.F.± (T) SIGN SIGN

TABLE OF REVISIONS

REVISION NO.	SHEET NO.	DESCRIPTION OF REVISION	DATE	MADE BY	APPROVED BY

LEGEND

DATE 3-26-70
DATE 3-26-70

PRESENT R.O.W.
TAKING WITHOUT ACQUISITION
TAKING WITHOUT ACQUISITION
TAKING WITH ACQUISITION
PENDING EASEMENT
TAKING WITH ACQUISITION

SR SLOPE RIGHTS
P PROPERTY LINE
TOP OF CUT
TOE OF SLOPE

APPROVED *[Signature]* DATE 5-26-70
CHIEF OF ACQUISITION
APPROVED *[Signature]* DATE 5/26/70
HIGHWAY ENGINEER
APPROVED *[Signature]* DATE 5-26-70
R.O.W. DIRECTOR

PROJECT BENNINGTON
NO. F 219-1(7)
SHEET 6 OF 17

4

STATE OF VERMONT
DEPARTMENT OF HIGHWAYS
RIGHT-OF-WAY PLANS
DETAIL SHEET
3 OF 3

TABLE OF PROJECT PROPERTY ACQUISITION

LINE NO.	GRANTOR	SHEET NO.	DESCRIPTION STATION	ENDING STATION	ACRES	REMARKS	DATE	TOWN OR CITY RECORDED	PK	PG	REMARKS
11A	TOWN OF BENNINGTON	9	34+98 LT.	34+98 RT	N/A	N/A					R.T. & I. TO T.R. 28
11B		9	34+98 LT.	38+49 RT.	1.9A±	DRAINAGE (P) DRAINAGE (P)					REFER TO FO19-1(6) DETAIL SHEET FOR EASTERLY REMAINDER
			35+50 LT.								
			38+00 LT. 34+98 LT.	38+11 LT.	8.0 A±						
12	BENNINGTON SCHOOL DISTRICT INC.	9,12	37+51 RT.	46+65 LT.	6.9 A±	DRAINAGE (P) DRAINAGE (P) DRAINAGE (P)					LOSS OF ACCESS(1.8A±)
			38+00 LT. 42+00 LT.								
			45+00 LT.	38+49 RT.	46+05 RT.						
13	THE BOARD OF CHURCH EXTENSION & HOME MISSIONS OF THE CHURCH OF GOD	11	31+28 LT.	33+02 LT.	N/A	1.4 A±	SLOPE RIGHTS (T)				1750 SQ. FT.
14	VILLAGE OF BENNINGTON RELINQUISHMENT: RT. 7 TO TOWN OF BENNINGTON	8	9+00 E	15+97 LT.	N/A	N/A					R.T. & I. TO US 7
			T.R.28(W)CONN 11+50 E	T.R.28(W)CONN 17+03 E							

TABLE OF REVISIONS

REVISION NO.	SHEET NO.	DESCRIPTION OF REVISION	DATE	MADE BY	APPROVED BY

DATE BY NBB DATE 3-27-70
LWB DATE 3-27-70

----- PROPERTY B.O.W.
----- SLOPE RIGHTS
----- PROPERTY LINE
----- TOP OF CUT
----- TOP OF SLOPE

LEGEND

SR-----SR----- SLOPE RIGHTS
-----P-----P----- PROPERTY LINE
-----TOP OF CUT
-----TOP OF SLOPE

APPROVED *Thomas P. Moore* DATE 5-26-70
CHIEF OF ACQUISITION
APPROVED *G. M. Lane* DATE 5/26/70
HIGHWAY ENGINEER
APPROVED *Thomas P. Moore* DATE 5-26-70
DIRECTOR

PROJECT BENNINGTON
NO. F 219-1(7)
SHEET 7 OF 17

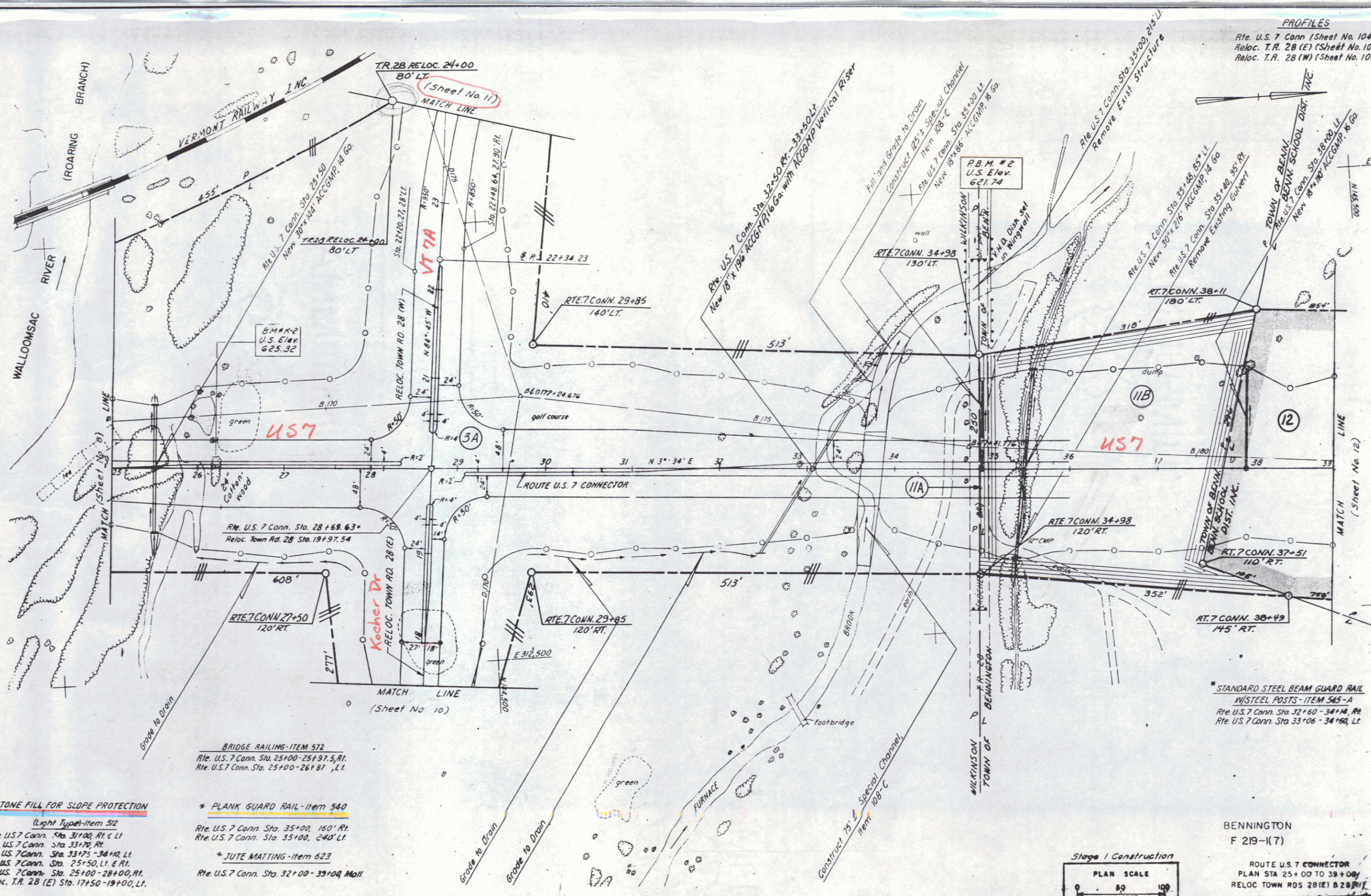

PROFILES
 Rte. U.S. 7 Conn (Sheet No. 104)
 Reloc. T.R. 28 (E) (Sheet No. 105)
 Reloc. T.R. 28 (W) (Sheet No. 106)

STONE FILL FOR SLOPE PROTECTION
 Light Type - Item 512
 Rte. U.S. 7 Conn. Sta. 31+00, Rt. C, Lt.
 Rte. U.S. 7 Conn. Sta. 33+70, Rt.
 Rte. U.S. 7 Conn. Sta. 33+75 - 34+10, Lt.
 Rte. U.S. 7 Conn. Sta. 25+50, Lt. & Rt.
 Rte. U.S. 7 Conn. Sta. 25+00 - 28+00, Rt.
 Reloc. T.R. 28 (E) Sta. 17+50 - 19+00, Lt.

BRIDGE RAILING - ITEM 512
 Rte. U.S. 7 Conn. Sta. 25+00 - 25+97.5, Rt.
 Rte. U.S. 7 Conn. Sta. 25+00 - 26+87, Lt.

*** PLANK GUARD RAIL - Item 540**
 Rte. U.S. 7 Conn. Sta. 35+00, 150' Rt.
 Rte. U.S. 7 Conn. Sta. 35+00, 240' Lt.

*** JUTE MATTING - Item 623**
 Rte. U.S. 7 Conn. Sta. 32+00 - 39+00, Mall

STANDARD STEEL BEAM GUARD RAIL
 W/STEEL POSTS - ITEM 545-A
 Rte. U.S. 7 Conn. Sta. 32+60 - 34+14, Rt.
 Rte. U.S. 7 Conn. Sta. 33+06 - 34+84, Lt.

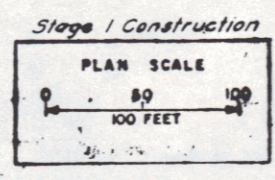

BENNINGTON
 F 219-(17)

ROUTE U.S. 7 CONNECTOR
 PLAN STA 25+00 TO 39+00
 RELOC TOWN RDS 28(E) & 28(W)

Sheet 9 of 17 DATE _____
 CONSULTANT _____

* Indicates Stage 2 Construction

6

NOTE: EXISTING ROW PLOTTED FROM HWY PROJECT BENNINGTON 'AP 23 CONT. 2 (1938)

END RELINQUISHMENT T.R. 28 (W) CONN 17+03.4

BEGIN RELINQUISHMENT T.R. 28 (W) CONN 11+50.4

NOTE: For Construction Notes See Sheet 126A

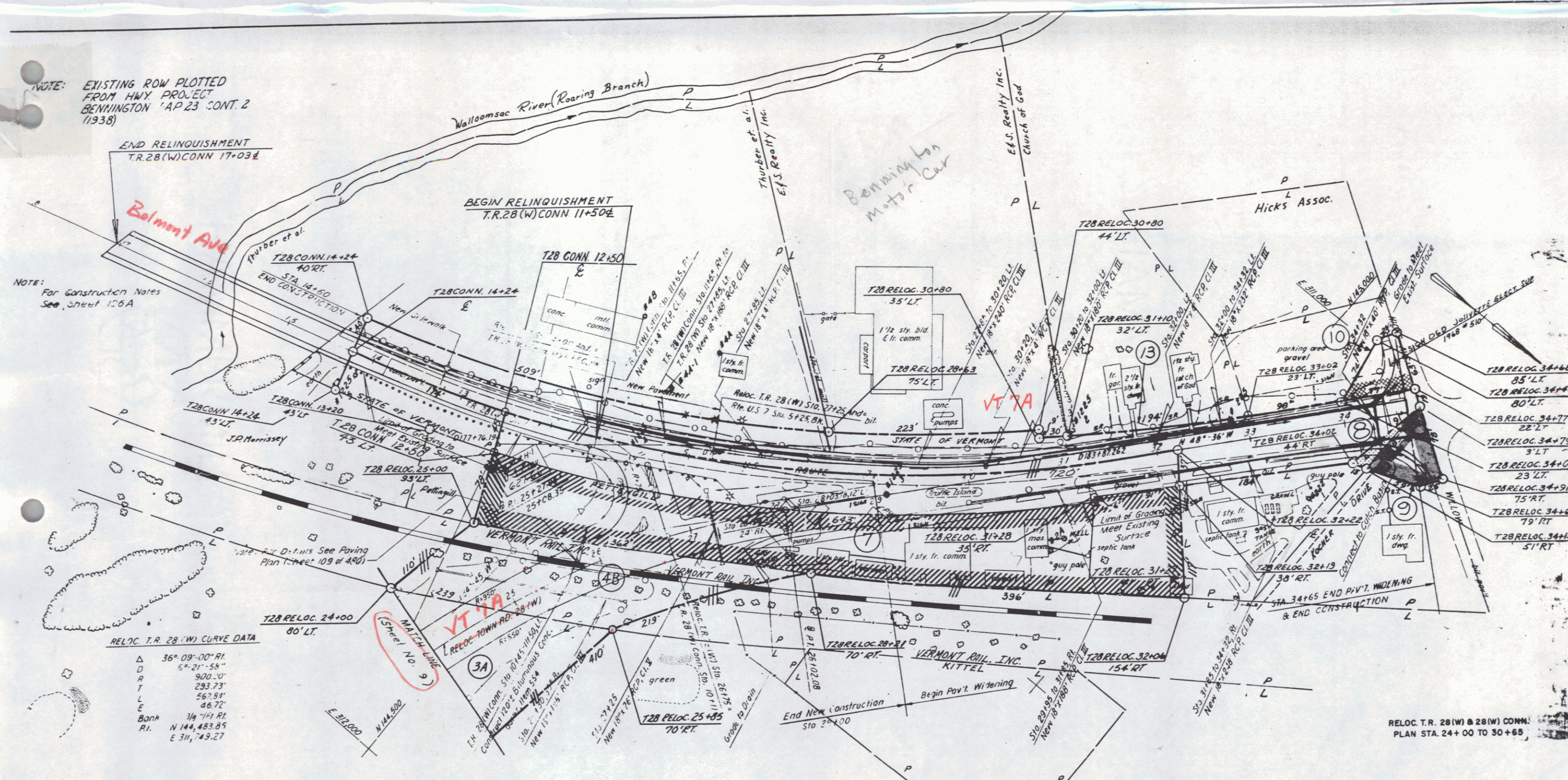

RELOC. T.R. 28 (W) CURVE DATA

Δ	36° 09' 00" RI
D	6° 21' 56"
R	900.0'
T	293.73'
L	567.91'
E	46.72'
Born	34° 74' RI
RI	N 144.483.85
	E 311.743.27

RELOC. T.R. 28 (W) & 28 (W) CONN. PLAN STA. 24+00 TO 30+65

- 3A CHARLES M. WILKINSON
- 4B STATE OF VERMONT (LESSOR)
- RUTLAND RAILROAD CORP. (LESSEE)
- NED H. PETTENGILL
- NORTHERN TERMINALS INC.
- HOWARD W. & AUXILLIA W. MOORE
- CHURCH OF GOD (LESSOR)
- CHARLESTOWN MILL STORE (LESSEE)

BENNINGTON
F 219-(17)