

NOTE: EXISTING ROW PLOTTED FROM HWY PROJECT BENNINGTON 'AP 23 CONT. 2 (1938)

END RELINQUISHMENT T.R. 28 (W) CONN 17+03.4

BEGIN RELINQUISHMENT T.R. 28 (W) CONN 11+50.4

NOTE: For Construction Notes See Sheet 126A

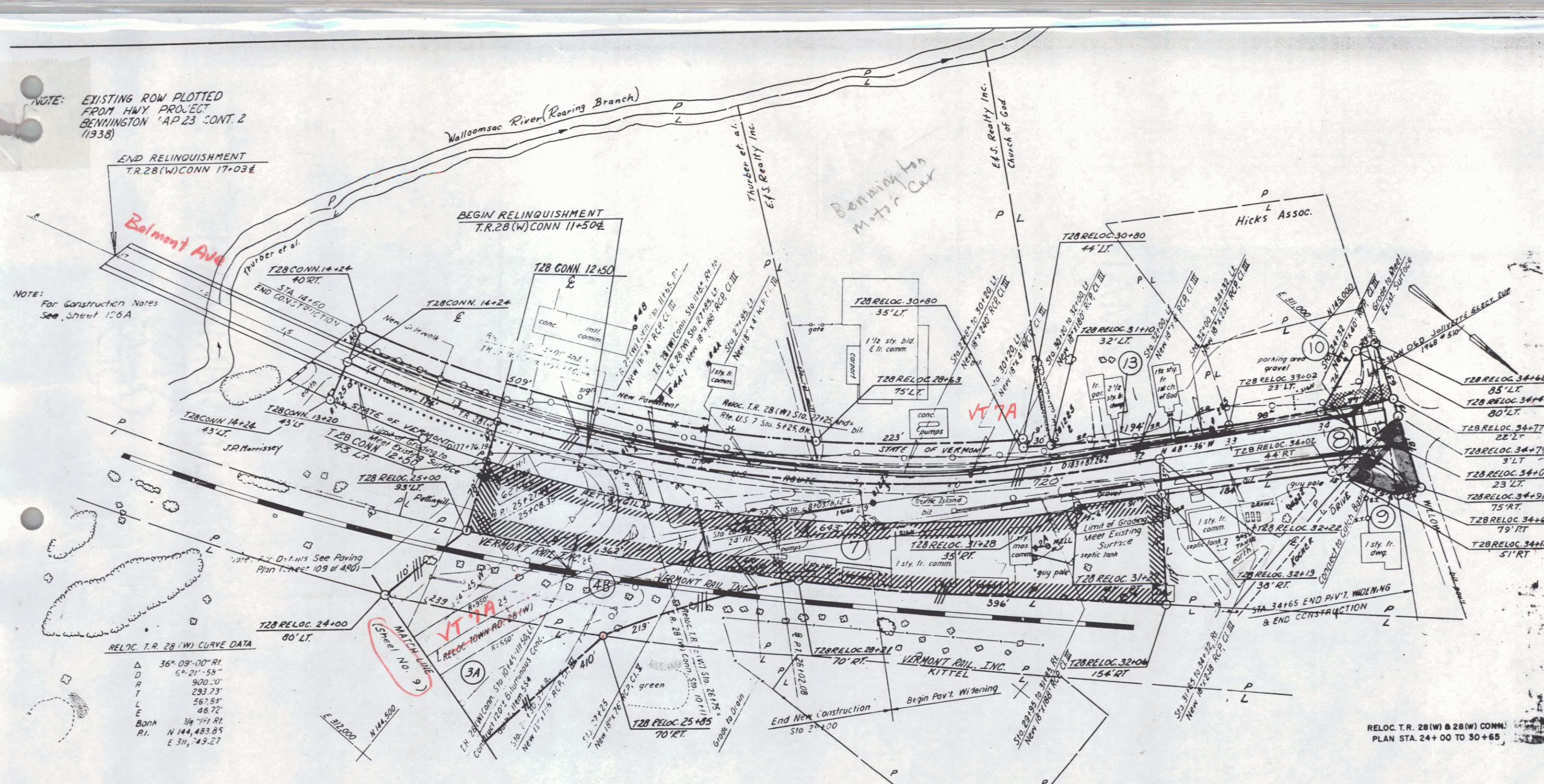

RELOC. T.R. 28 (W) CURVE DATA

Δ	36° 09' 00" RI
D	6° 21' 56"
R	900.0'
T	293.73'
L	567.91'
E	46.72'
Born	34° 74' RI
RI	N 144.483.85
	E 311.743.27

- 3A CHARLES M. WILKINSON
- 4B STATE OF VERMONT (LESSOR)
- RUTLAND RAILROAD CORP. (LESSEE)
- NED H. PETTENGILL
- NORTHERN TERMINALS INC.
- HOWARD W. & AUXILLIA W. MOORE
- CHURCH OF GOD (LESSOR)
- CHARLESTOWN MILL STORE (LESSEE)

RELOC. T.R. 28 (W) & 28 (W) CONN. PLAN STA. 24+00 TO 30+65

BENNINGTON
F 219-(17)