

INDEX OF SHEETS

SHEET NO.	1	TITLE PAGE
	2	TYPICAL CROSS-SECTION OF IMPROVEMENT DOUBLE TACK COAT OF REFINED TAR WITH PEA STONE SEAL
	3	BANKING AND WIDENING TABLES
	4	QUANTITY SHEET (ITEMS)
	5	QUANTITY SHEET (DRAINAGE)
	6-8	EARTHWORK SHEETS
	9-17	PLAN AND PROFILE SHEETS
	18	CONSTRUCTION DETAILS CD (DRAINAGE AND MARKERS)
	19	CONSTRUCTION DETAILS CD-1 (DITCHES)
	20	STANDARD STRUCTURE SHEET S-40 (BARRICADES, SIGNS AND LIGHTS)
	21-73	CROSS-SECTIONS

STANDARD STRUCTURE SHEET APPROVED BY THE CHIEF ENGINEER,  
VERMONT STATE DEPARTMENT OF HIGHWAYS.  
S-40 JUNE 10, 1950

STATE OF VERMONT  
DEPARTMENT OF HIGHWAYS

PROPOSED IMPROVEMENT  
SECONDARY PROJECT  
**TOWN OF WESTMORE**  
COUNTY OF ORLEANS  
**VERMONT ROUTE 5-A**  
WEST BURKE-WESTMORE ROAD

FED. ROAD DISTRICT NO.	STATE	PROJECT NO.	SHEET NO.	TOTAL SHEETS
	VT	S 35(2)	1	73

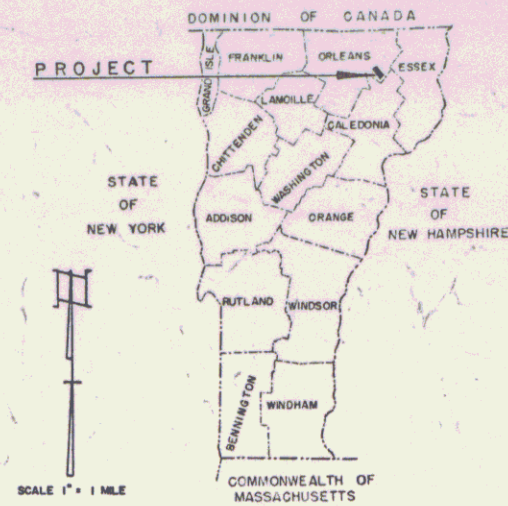

PROJECT NAME & NO.	TYPE	PAVEMENT AREA
Westmore S-35(2)	Double-Tack Coat of Refined Tar with Pea Stone Seal	Rdway - 23,810 S.Y. Misc. - 2,387 S.Y.
RECORD PLANS		
MATERIALS		
SUB-BASE OF GRAVEL Larrabee Pit - Newark, Vt. Huntton Pit - Westmore, Vt.	A.C.C.G.M.P. Metal Underdrain	Barger Metal Culvert Co. Westminster Sta., Vt.
3-1/2" BASE OF CRUSHED GRAVEL (Boosecrusher) Brighton, Vt.	3-CABLE GUARD RAIL Cable - Amer. Steel & Wire Co. Posts - Main Line Fence Co. Anchors - Westbrock, Me. Paint for C.R. - Sherwin-Williams Co.	New Haven, Conn. Amer. Steel & Wire Co. Westbrook, Me. Williams Co.
PEASTONE (Boosecrusher) Warren Coe Pit - Brighton, Vt.	Seeding - E.T. & H.K. Ide Inc., Passumpsic, Vt.	
REFINED TAR Type T-8 R. T-9 (50-50) Blend Koppers Products Co., Everett, Mass.		
CONTRACTOR - Lewis & Scott, Inc.	CONTRACT DATED - Dec. 14, 1954	
RESIDENT ENGINEER - A. Graham	CONTRACT STARTED - Dec. 16, 1954	
INSPECTORS - E. Isham - J. Smyrski E. Lombard & G. Hopkins	CONTRACT COMPLETED - July 26, 1956	
RECORD PLANS - A. Graham & G. Burnham	CONTRACT ACCEPTED - July 26, 1956	

BEGINNING AT A POINT APPROXIMATELY 19 MILES NORTH-WEST OF THE NEWARK-WESTMORE TOWN LINE AND EXTENDING NORTHWESTERLY 11,649.5 FEET...  
LENGTH OF PROJECT 11,649.5 = 2.206 MILES  
11,649.5

Plan # 99R759

NOTE: ANY FURTHER INFORMATION CONCERNING FINAL CONTRACTS AND DETAILS OF THE PROJECTS PERTAINING TO THIS PROJECT SHOULD BE OBTAINED EITHER FROM THE FIELD ENGINEER OR THE DISTRICT ENGINEER.

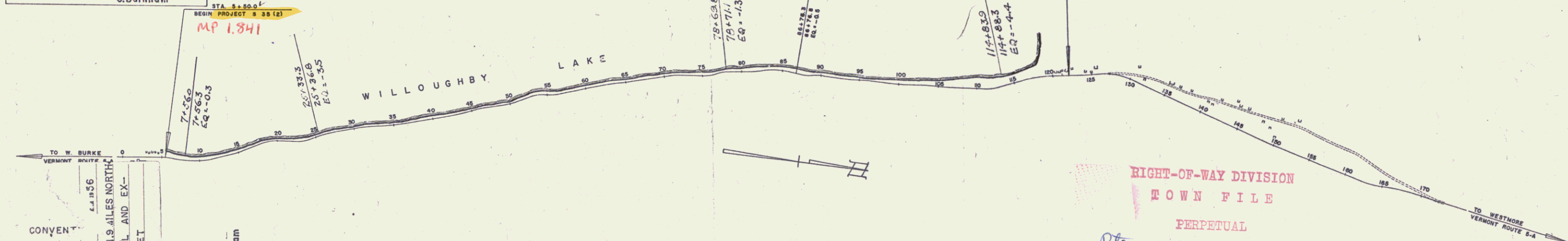

RIGHT-OF-WAY DIVISION  
TOWN FILE  
PERPETUAL  
Town of UT 5A  
(To Be Returned To R.O.W. Division)

CONVENTION

PROJECT: WESTMORE  
SHEET: S 35(2)  
TYPE: DOUBLE TACK COAT OF REFINED TAR WITH PEA STONE SEAL  
CONTRACTOR: LEWIS & SCOTT, INC.

LOCATION: BEGINNING AT A POINT APPROX. 19 MILES NORTHWEST OF THE NEWARK-WESTMORE TOWN LINE AND EXTENDING NORTHWESTERLY 11,649.5 FEET

CONTRACTOR: Lewis & Scott, Inc.  
RECORD PLANS - A. Graham & G. Burnham  
COMPLETION DATE - July 26, 1956

GROUND ELEVATION	DATUM	LINE
GRADE ELEVATION	DATUM	REF. LINE

CURVE DATA

DEFLECTION OF ANGLE	Δ
DEGREE OF CURVE	D
RADIUS OF CURVE	R
TANGENT DISTANCE	T
LENGTH OF CURVE	L
EXTERNAL DISTANCE	E
POINT OF INTERSECTION	P.I.
POINT OF CURVE	P.C.
POINT OF TANGENT	P.T.
POINT ON TANGENT	P.O.T.
POINT ON SUB-TANGENT	P.O.S.T.

SCALES

TITLE	1" = 600'
TYPICAL	1" = 2'
PLAN	1" = 50'
PROFILE	1" = 10'
CROSS-SECTIONS	1" = 5'

THESE PLANS ARE SUBJECT TO SUCH REVISIONS AS MAY BE REQUIRED BY THE BUREAU OF PUBLIC ROADS OR THE COMMISSIONER OF HIGHWAYS.

CONSTRUCTION IS TO BE CARRIED ON IN ACCORDANCE WITH THE PLANS AND THE STANDARD ROAD AND BRIDGE SPECIFICATIONS OF 1948, AS APPROVED JULY 25, 1949 BY THE BUREAU OF PUBLIC ROADS, INCLUDING ALL SUBSEQUENT APPROVED REVISIONS AND SUCH REVISED SPECIFICATIONS AND SPECIAL PROVISIONS AS ARE SUBMITTED WITH THE PLANS.

DEPARTMENT OF COMMERCE  
BUREAU OF PUBLIC ROADS

APPROVED \_\_\_\_\_  
DISTRICT ENGINEER

DATE \_\_\_\_\_

PROJECT S NO 35 (2)

SHEET 1 OF 73 SHEETS

APPROVED CONSTRUCTION ENGINEER DATE 11-8-54	APPROVED SECONDARY ENGINEER DATE 11/2/54	APPROVED DISTRICT ENGINEER DATE 6/21/54	APPROVED DISTRICT ENGINEER DATE 11/9/54	APPROVED DISTRICT ENGINEER DATE 11/10/54
---	--	---	---	--

STEARNS R. JENKINS  
UT 5A