

PARCEL INSTRUMENT DATE	GRANTOR	GRANTEE	RECORDED WESTMORE
A.B.C.D. W.D.E.	9-16-43	U.S. BOBBIN & SHUTTLE CO.	ST. OF VY. 18 336-337 10-21-43
E. Q.C.D.E.	7-18-46	" " " " " " " "	18 427-428 7-18-46

Note: Sta 239+00 - 251+00 Lt.  
 All marketable timber cut from this area, when clearing for construction, shall be cut into 12'-8" lengths and neatly piled off the ROW, at a point selected by the Engineer in charge of construction, for removal by the U.S. Bobbin & Shuttle Co.

FED. ROAD DIST. NO.	STATE	PROJ. NO.	FISCAL YEAR	SHEET NO.	TOTAL SHEETS
1	35	U	1946	7	29

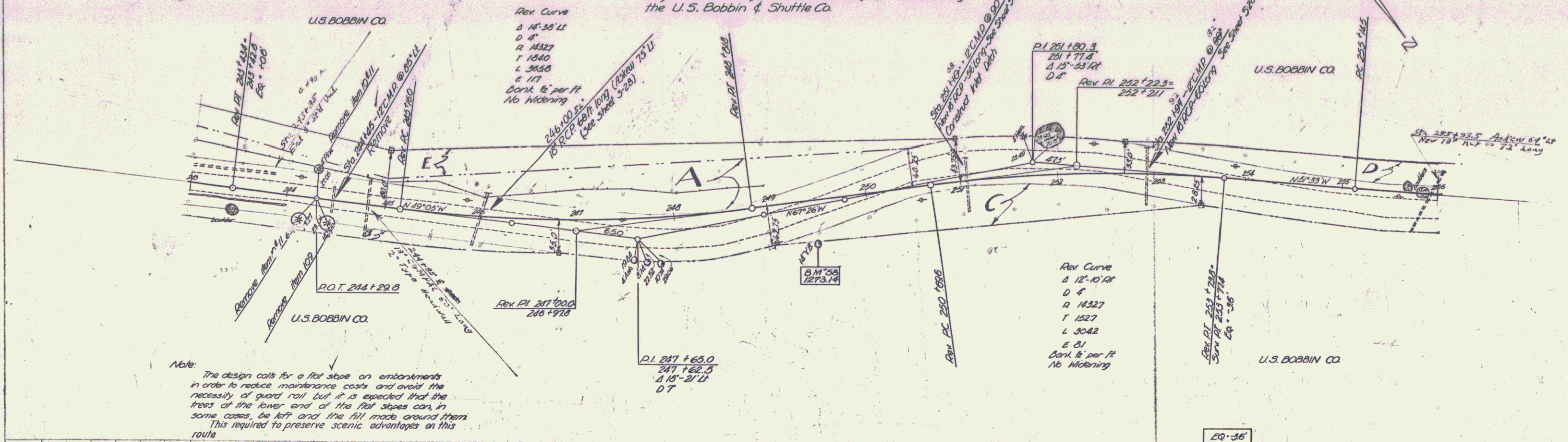

Note: The design calls for a flat slope on embankments in order to reduce maintenance costs and avoid the necessity of guard rail but it is expected that the trees of the lower end of the flat slopes can, in some cases, be left and the fill made around them. This required to preserve scenic advantages on this route.

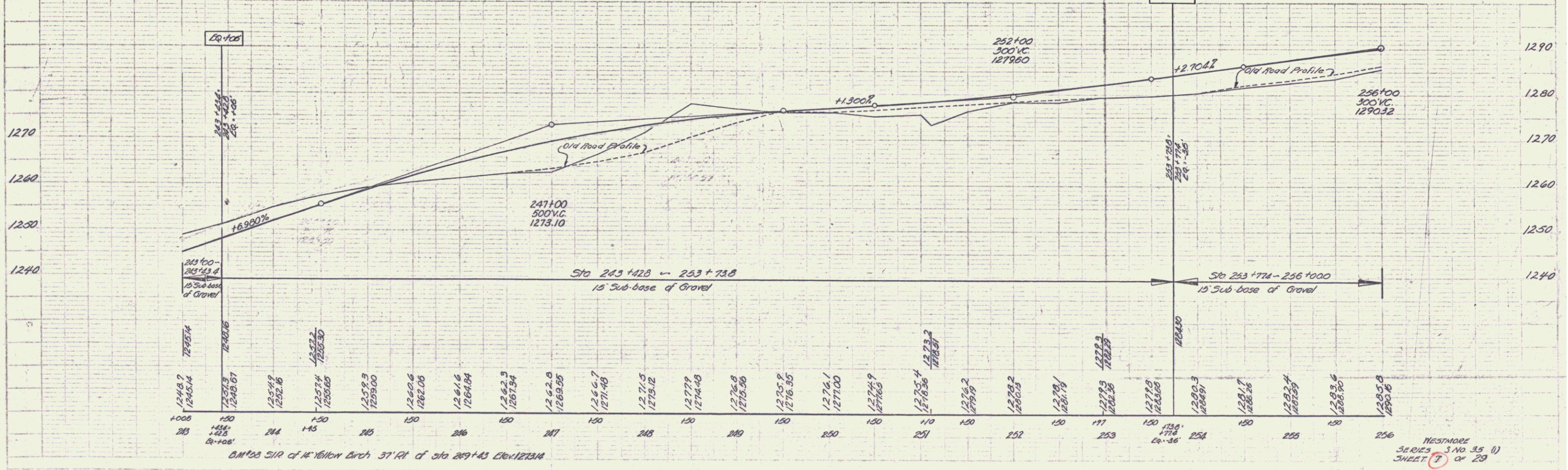

WESTMORE SERIES S. NO. 35 (1) SHEET 7 OF 29