

INDEX OF SHEETS

- 1. TITLE SHEET
- 2,3,3. TYPICAL CROSS SECTIONS
- 4. ITEM QUANTITY AND DRAINAGE SHEET
- 5. EARTH WORK SHEET
- 6. RIGHT OF WAY DETAIL SHEET
- 7,8,8. PLAN AND PROFILE SHEETS
- 9. DETAILS OF INTERSECTION
- 10. SIGN LOCATION SHEET
- 11. TRAFFIC SIGN AND DELINEATOR SUMMARY SHEET
- 12. TRAFFIC SIGNS - DESIGN AND CONSTRUCTION DETAILS
- 13. STANDARD SHEET A-60 DEC. 21, 1967 R.
- 14. STANDARD SHEET B-1 JULY 17, 1967 R.
- 15. STANDARD SHEET B-5 MAR. 10, 1965
- 16. STANDARD SHEET B-10 MAR. 10, 1965
- 17. STANDARD SHEET B-16 JULY 21, 1967 R.
- 18. STANDARD SHEET C-1 MAY 10, 1968 R.
- 19. STANDARD SHEET D-2 JULY 25, 1967 R.
- 20. STANDARD SHEET D-3 JULY 19, 1967 R.
- 21. STANDARD SHEET D-4 AUG. 1, 1966 R.
- 22. STANDARD SHEET D-6 DEC. 23, 1966
- 23. STANDARD SHEET D-11 MAR. 21, 1967 R.
- 24. STANDARD SHEET E-12 AUG. 28, 1964 R.
- 25. STANDARD SHEET E-15 AUG. 12, 1963 R.
- 26. STANDARD SHEET E-16 DEC. 18, 1964 R.
- 27. STANDARD SHEET E-22 FEB. 18, 1968
- 28. STANDARD SHEET E-23 FEB. 23, 1968
- 29. STANDARD SHEET E-25 FEB. 6, 1968
- 30. STANDARD SHEET E-26 FEB. 6, 1968
- 31. STANDARD SHEET E-31 AUG. 21, 1967 R.
- 32. STANDARD SHEET E-32 JAN. 6, 1967
- 33. STANDARD SHEET G-4 DEC. 30, 1965
- 34. STANDARD SHEET G-5 OCT. 4, 1967 R.
- 35. STANDARD SHEET J-1 MAR. 10, 1965
- 37-44. CROSS SECTION SHEETS
- * 26-A STANDARD SHEET E-18 DEC. 18, 1964 R.

STATE OF VERMONT
DEPARTMENT OF HIGHWAYS

PROPOSED IMPROVEMENT

TOWN OF CASTLETON

COUNTY OF RUTLAND

VT ROUTE 4A

CASTLETON-RUTLAND ROAD

BEGINNING AT A POINT 2.993 MILES WESTERLY OF THE CASTLETON-IRA TOWN LINE AND EXTENDING EASTERLY 0.208 MILE

LENGTH OF PROJECT 11000 FEET-0.208 MILE

1968 ADT = 1600
1968 ADT = 2700
1968 DHV = 380
D = 58%
T = 8%
V = 80

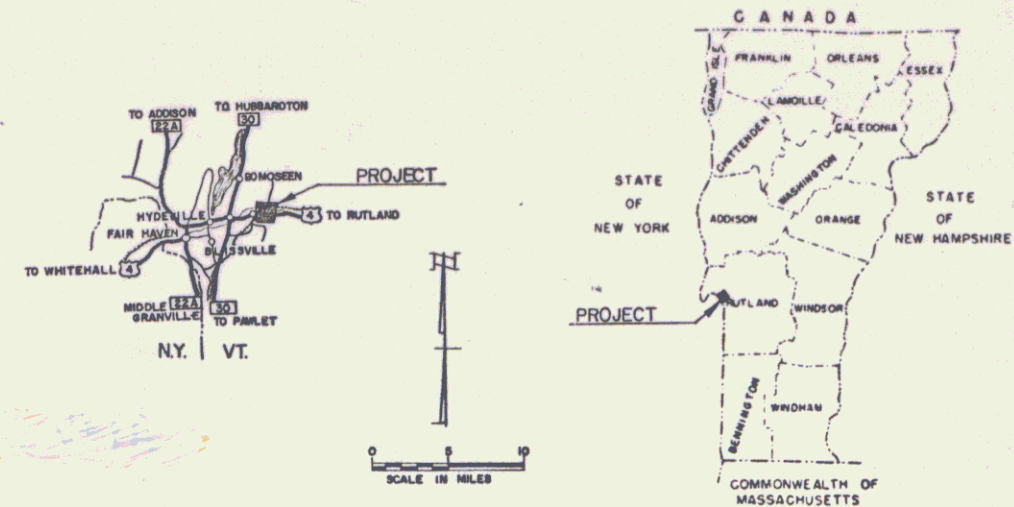

RIGHT-OF-WAY DIVISION
TOWN FILE

PERPETUAL

Rte. of VT 4A

(To Be Returned To R.O.W. Division)

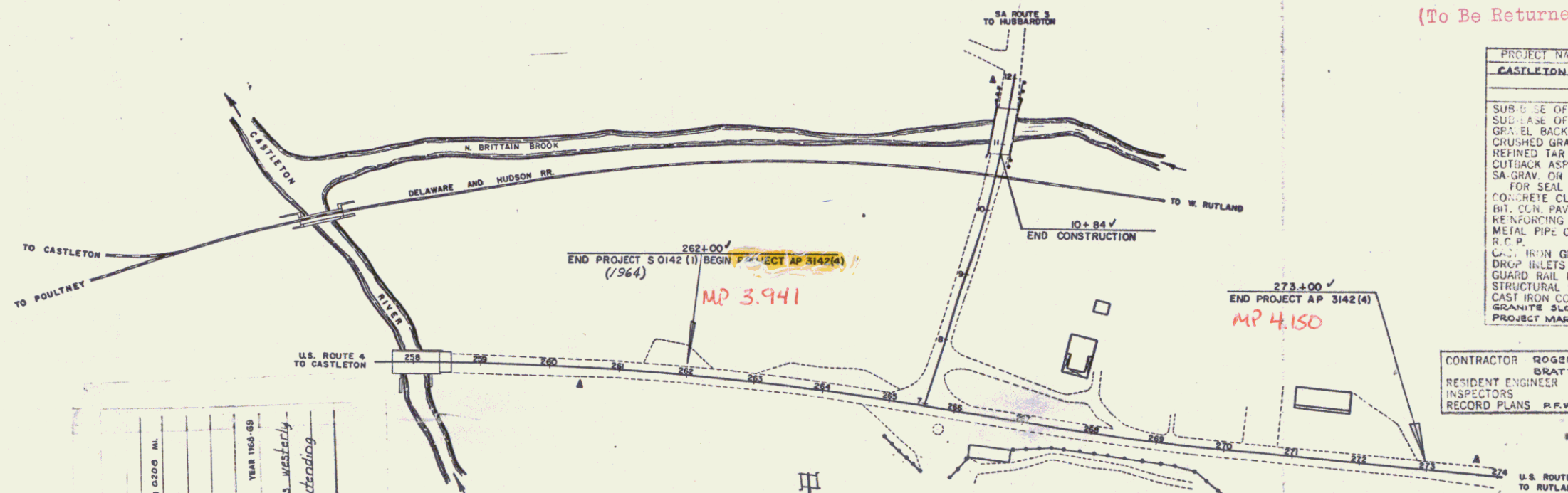

| PROJECT NAME & NUMBER | TYPE PAVEMENT | AREA SQ. |
|--|---------------------|----------|
| CASTLETON AP 3142(4) | BITUMINOUS CONCRETE | 52,800 |
| RECORD PLANS | | |
| MATERIALS | | |
| SUB-BASE OF GRAVEL - CAROLINA PIT, CASTLETON, VT. | | |
| SUB-BASE OF SAND - NONE USED | | |
| GRAVEL BACKFILL - CRUSHED GRAVEL | | |
| REFINED TAR | | |
| OUTBACK ASPHALT - ALLSTATES ASPHALT, INC., SANDERLAND, MASS. | | |
| S.A. GRAV. OR PEASTONE | | |
| FOR SEAL | | |
| CONCRETE CLASS | | |
| BIT. CON. PAVEMENT - VERMONT PAVING CORP., WALLINGFORD, VT. | | |
| REINFORCING STEEL - J.P. CARROLL PLANT, CLARENDON, VT. | | |
| METAL PIPE CULVERT - NORTHEASTERN CULV. CORP., R.F.P. | | |
| C.I. IRON GRATE | | |
| DRAIN BILETS | | |
| GUARD RAIL, ETC. IS S.T. GRISWOLD & CO., INC., WILLISTON, VT. | | |
| STRUCTURAL STEEL | | |
| CAST IRON COVER FOR F.B. - NONE USED | | |
| GRANITE SLOPE BOLTING - BARKETTS GRANITE CORP., MILFORD, N.H. (GRISWOLD) | | |
| PROJECT MARKERS - HUME PIPE OF N.E., INC., WINDSOR, VT. | | |

| | | | |
|-------------------|--|----------------|---------------|
| CONTRACTOR | ROGERS CONSTR. CO. BRATTLEBORO, VT. | CONTRACT DATED | OCT. 19, 1968 |
| RESIDENT ENGINEER | E.M. GIBSON | STARTED | OCT. 18, 1968 |
| INSPECTORS | | COMPLETED | JUNE 6, 1969 |
| RECORD PLANS | R.F.W. 10/18/68 | ACCEPTED | JUNE 6, 1969 |

Pin # 99R749

NOTE: ANY FURTHER INFORMATION CONCERNING FINAL QUANTITIES, AMOUNTS OR OTHER DETAILS RELATIVE TO THIS PROJECT MAY BE FOUND IN EITHER THE FIELD BOOKS OR THE ESTIMATE FILE.

CONVENTIONAL SIGNS

| | |
|--|-----|
| POINT OF ACCESS | X |
| LIMITS OF ACCESS | --- |
| COUNTY LINE | --- |
| TOWN LINE | --- |
| FENCE LINE | --- |
| STONE WALL | --- |
| UNFENCED PROPERTY | --- |
| GUARD RAIL | --- |
| TRAVELED WAY | --- |
| RAILROAD | --- |
| RETAINING WALL | --- |
| CENTER LINE | --- |
| SURVEY LINE | --- |
| CULVERT | --- |
| DROP INLET | --- |
| TROLLEY POLE | --- |
| POWER POLE | --- |
| TELEPHONE POLE | --- |
| TREES | --- |
| HEDGE | --- |
| F.A. CONSTRUCTION IDENTIFICATION SIGNS | A |

| | |
|-----------------------|-----|
| SLOPE RIGHTS | --- |
| GROUND ELEVATION | --- |
| GRADE ELEVATION | --- |
| CURVE DAT. | --- |
| DEFLECTION OF ANGLE | --- |
| DEGREE OF CURVE | --- |
| RADIUS OF CURVE | --- |
| TANGENT DISTANCE | --- |
| LENGTH OF CURVE | --- |
| EXTERNAL DISTANCE | --- |
| POINT OF INTERSECTION | --- |
| POINT OF CURVE | --- |
| POINT OF TANGENT | --- |
| POINT ON TANGENT | --- |
| POINT ON SUB-TANGENT | --- |
| ROW LIMITS | --- |

PROJECT: CASTLETON
NUMBER: AP 3142(4)
TYPE: BITUMINOUS CONCRETE PAVEMENT
YEAR: 1968-69
CONTRACTOR: ROGERS CONSTRUCTION CO.
LOCATION: BRATTLEBORO, VT.
LOCATION: Beginning at a point 2.993 miles westerly of the Castleton-Ira Town Line and extending easterly 0.208 mile.

HT OF WAY DETAILS
HT OF WAY PLANS FOR THIS PROJECT.

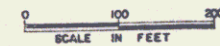

THESE PLANS ARE SUBJECT TO SUCH REVISIONS AS MAY BE REQUIRED BY THE BUREAU OF PUBLIC ROADS OR THE COMMISSIONER OF HIGHWAYS.
CONSTRUCTION IS TO BE CARRIED ON IN ACCORDANCE WITH THESE PLANS AND THE STANDARD SPECIFICATIONS FOR HIGHWAY AND BRIDGE CONSTRUCTION DATED APRIL 1964, AS APPROVED BY THE BUREAU OF PUBLIC ROADS ON OCTOBER 12, 1964, INCLUDING ALL SUBSEQUENT APPROVED REVISIONS AND SUCH REVISED SPECIFICATIONS AND SPECIAL PROVISIONS AS ARE INCORPORATED IN THESE PLANS.

| | | | | | | | | | | | |
|----------|----------------------------------|----------|-------------------------------------|----------|-----------------|----------|--------------------------------|----------|-------------------------------------|----------|--|
| APPROVED | J. A. Nuske DISTRICT ENGINEER | APPROVED | R. J. Hunt CONSTRUCTION ENGINEER | APPROVED | BRIDGE ENGINEER | APPROVED | L. M. Lane HIGHWAY ENGINEER | APPROVED | E. W. Stebbins DISTRICT ENGINEER | APPROVED | R. J. C. [Signature] CHIEF ENGINEER |
| DATE | 7/7/67 | DATE | 7/6/67 | DATE | | DATE | 7/6/67 | DATE | 7/7/67 | DATE | 7/7/67 |

| | |
|--|----------------|
| DEPARTMENT OF TRANSPORTATION BUREAU OF PUBLIC ROADS | |
| APPROVED | |
| DIVISION | ENGINEER |
| PROJECT | AP NO. 3142(4) |
| SHEET 1 OF 44 SHEETS | |

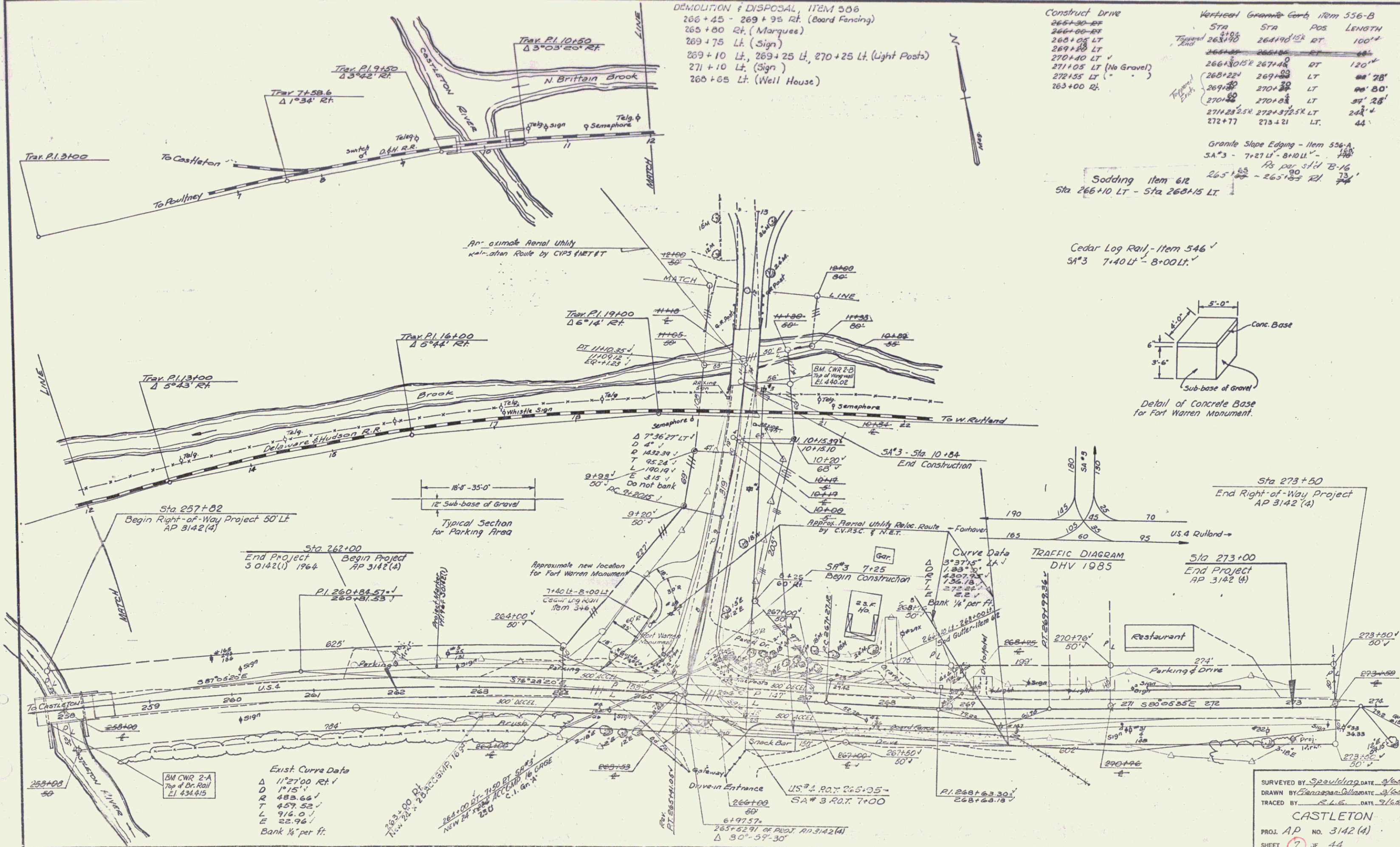

SURVEYED BY Spaulding DATE 3/65
 DRAWN BY Ganss DATE 3/65
 TRACED BY S.L.G. DATE 9/62

CASTLETON
 PROJ. AP NO. 3142 (4)
 SHEET 7 OF 44

VERMONT DEPARTMENT OF HIGHWAYS
 RIGHT-OF-WAY PLANS
 PROJECT CASTLETON
 NO. AP 3142 (A)
 SHEET 5 OF 13

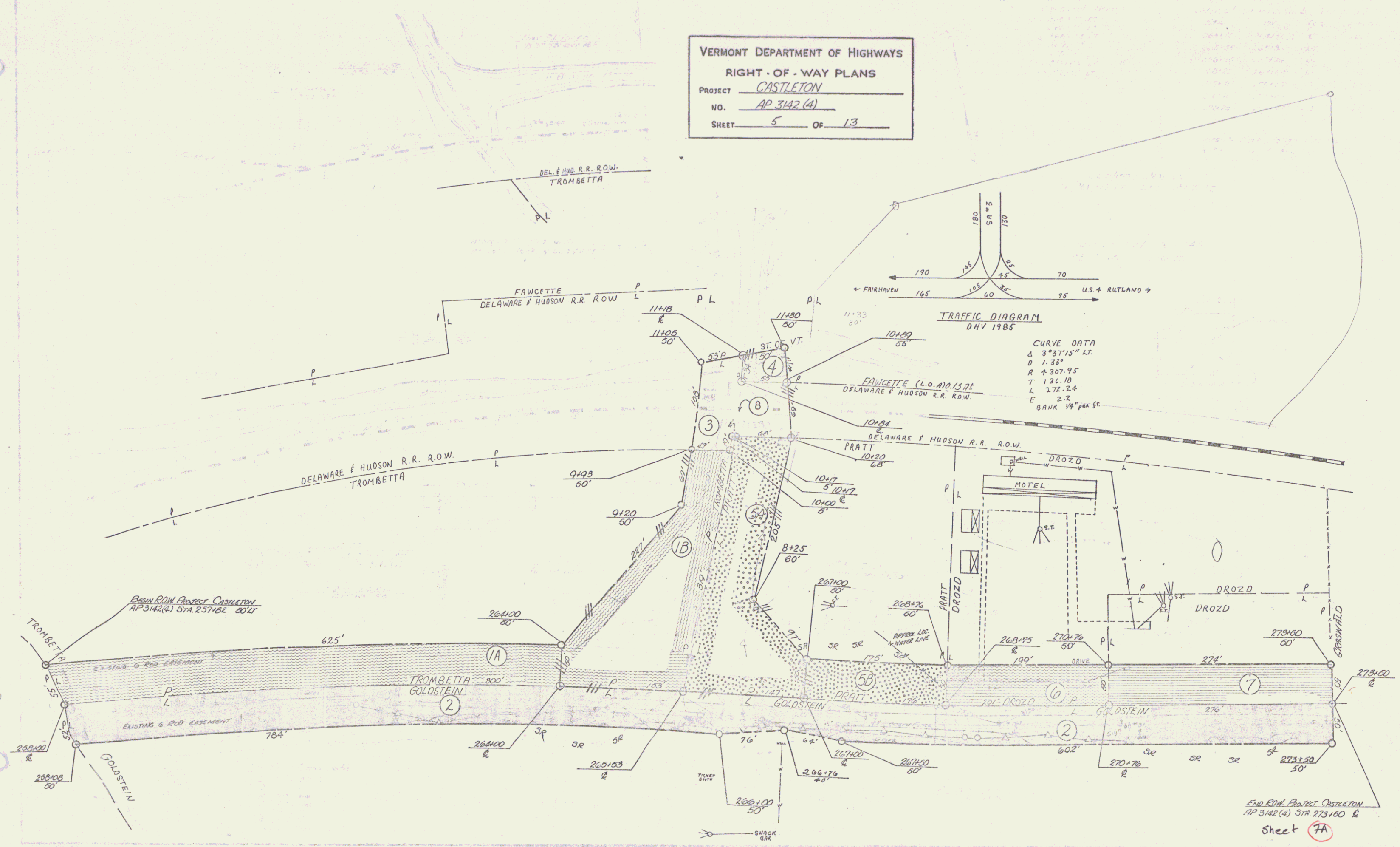

END ROW PROJECT CONNECTION
 AP 3142 (A) STA 273+60 E
 Sheet **7A**

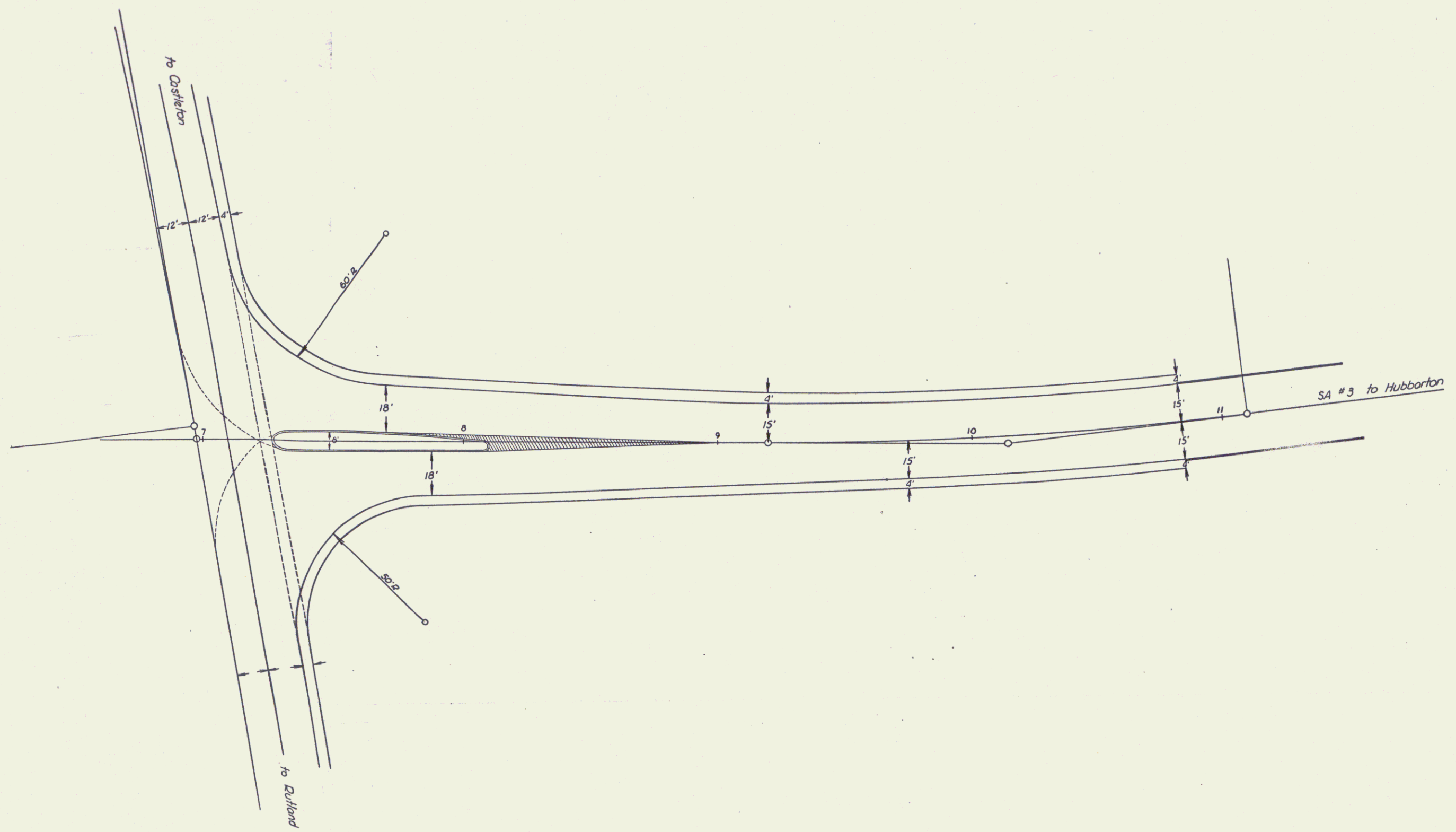

DETAILS OF INTERSECTION - SCALE 1" = 20'
 DRAWN BY ELANAGAN DATE 7/67
 TRACED BY JANAWICZ DATE 7/67
 CASTLETON
 PROJ. NO. 3142(4)
 SHEET 9 OF 44
 D-7