

NEW CURBWAYS REQUIRED
 STA 140+35 - 12" REIN. CONCRETE PAV. - 3" THICK 72'
 CONCRETE CLASS B (25-5) @ 0.8
 STA 143+30 - 12" REIN. CONC. PAV. - 3" THICK
 CONCRETE CLASS A (1-4) @ 0.8
 CONCRETE CLASS B (25-5) @ 0.8
 REINFORCING STEEL 25' L.G.S.
 DRAIN INLET GRATES 1"

NEW BRICK CATCH BASINS REQUIRED
 STA. 140+35 - ONE ON RIGHT

WOOD GUARD RAIL REQUIRED
 ON RIGHT
 STA. 143+18 TO 143+42
 143+23 - 145+47
 140+23 - 143+42
 24' Lx10"
 24'
 24'
 72' TOTAL

VITRIFIED CLAY PIPE REQUIRED
 STA. 143+35 - RIGHT, 12" CLAY PIPE - 24' LONG 78'
 (to replace present 6" tile)

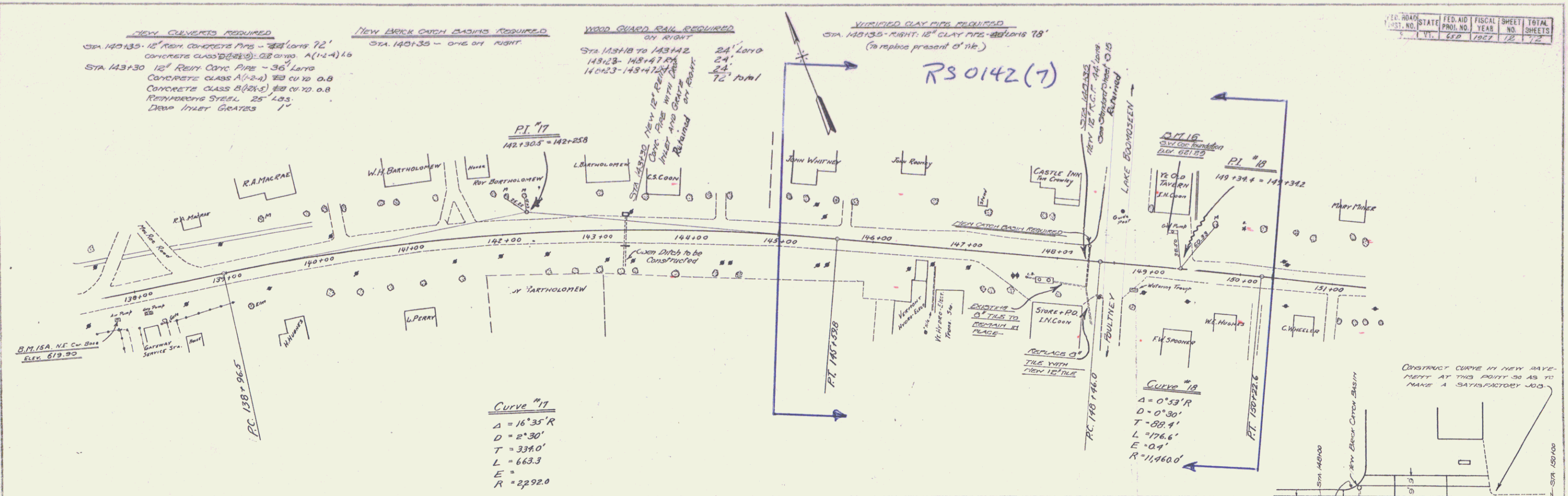

Curve #17
 $\Delta = 16^{\circ}35'R$
 $D = 2^{\circ}30'$
 $T = 339.0'$
 $L = 663.3$
 $E =$
 $R = 2292.0$

Curve #18
 $\Delta = 0^{\circ}53'R$
 $D = 0^{\circ}30'$
 $T = 88.4'$
 $L = 176.6'$
 $E = 0.4'$
 $R = 11,960.0'$

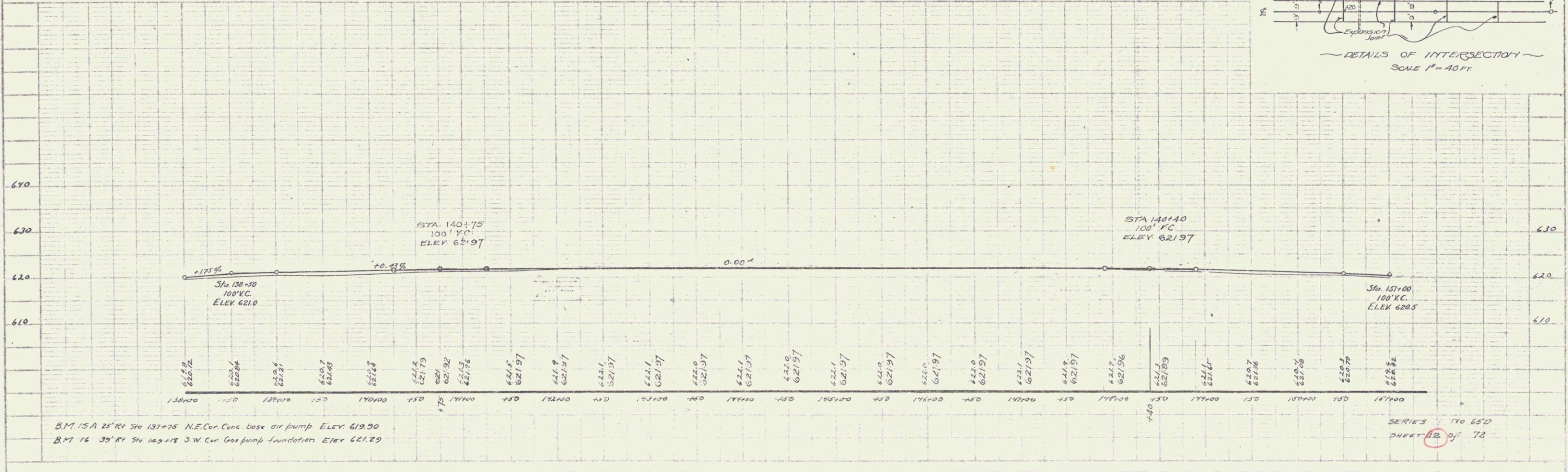
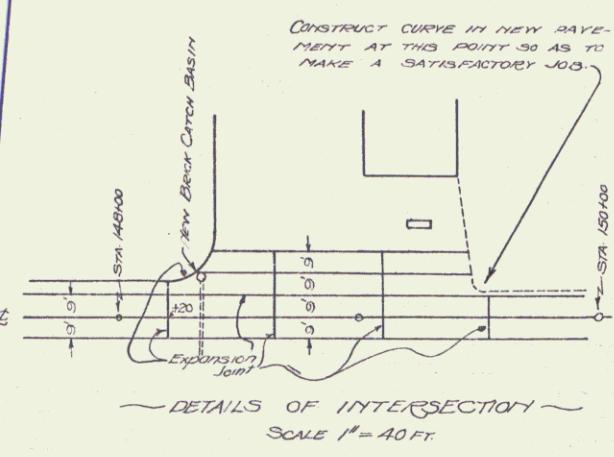

B.M. 15A 25'x41' Sta 137+25 N.E. Cor. Conc. base air pump ELEV. 619.90
 B.M. 16 35'x41' Sta 143+18 S.W. Cor. Gas pump foundation ELEV. 621.29

SERIES 170 65'D
 SHEET 12 of 72