

CABLE GUARD RAIL REQUIRED
 ON RIGHT
 STA 61+25 TO STA 63+25
 LENGTH 200'
 TOTAL FOR SHEET 128'

NEW CULVERTS REQUIRED
 STA 63+11-15 REINFORCED CONCRETE PIPE 36" DIA
 CONCRETE CLASS B (1-2-1) 28' LONG 1.0
 REINFORCING STEEL 28 LBS. 41
 CONCRETE CLASS A (1-2-1) 0.7 cy

NEW CULVERTS REQUIRED
 STA 71+25 TO 71+37 CURB AND GUTTER
 CONCRETE CLASS B (1-2-1) 28' LONG 1.0
 REINFORCING STEEL 28 LBS. 41
 CONCRETE CLASS A (1-2-1) 0.7 cy

NEW DRIVEWAY CULVERTS REQUIRED
 STA 65+25 LEFT SIDE CURB METAL
 PIPE LENGTH 25 FT
 CONCRETE CLASS B (1-2-1) 10' DIA
 REINFORCING STEEL 33 LBS.

WOOD GUARD RAIL REQUIRED
 ON LEFT
 STA 63+25 TO STA 63+25 LENGTH 0'
 STA 71+13 TO 71+37 LENGTH 24'
 ON RIGHT
 STA 63+25 TO 71+37 LENGTH 84'
 TOTAL FOR SHEET 128'

FIELD NO.	STATE	FISCAL YEAR	SHEET NO.	TOTAL SHEETS
1	VT	1955	6	10

LANDSCAPING

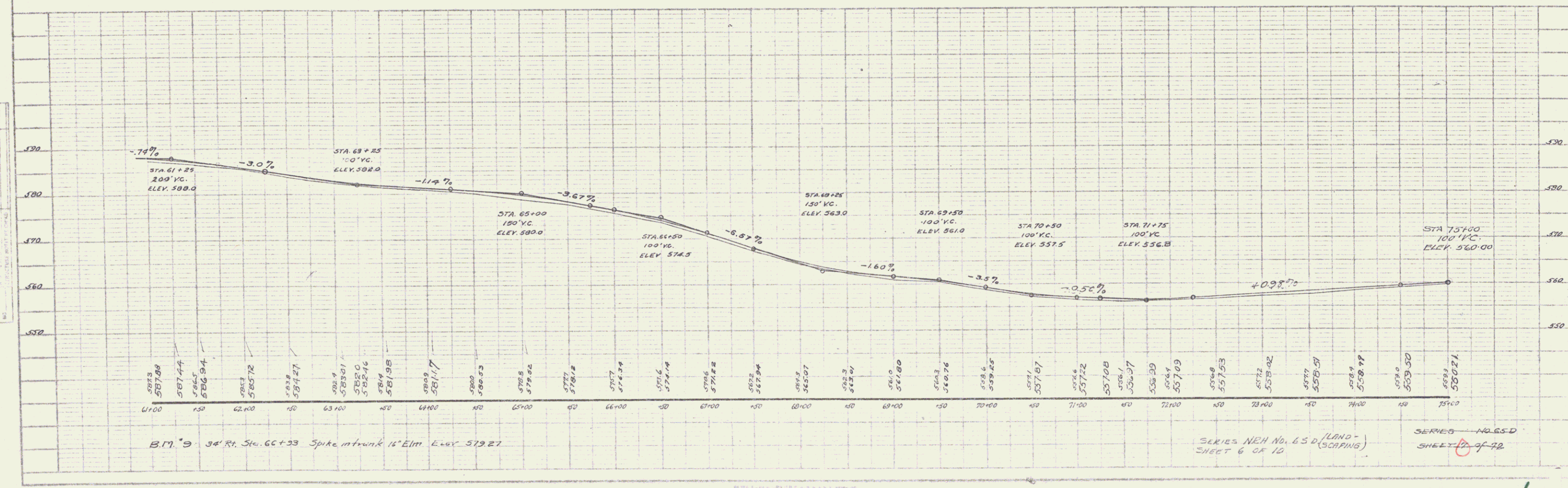
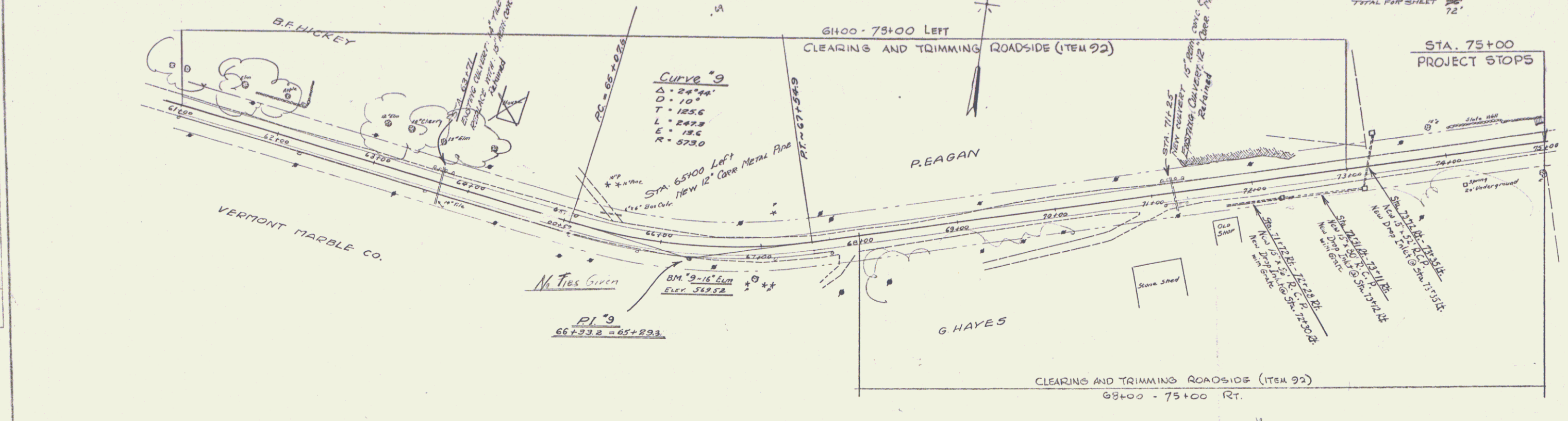

PLAN
 SCALE 1" = 40'
 DATE 10/1/55
 DRAWN BY J. W. HARRIS

PROFILE
 SCALE 1" = 10'
 DATE 10/1/55
 DRAWN BY J. W. HARRIS

SERIES NEH No. 65 D (LANDSCAPING)
 SHEET 6 OF 10
 SERIES NO. 65 D
 SHEET 6 OF 10