

GUARD RAIL REQUIRED

ON LEFT

Sta. 0+00 to 0+16	Length 16 FT
" 10+07 to 10+31	" 24 "
" 14+88 to 15+00	" 12 "

ON RIGHT

Sta. 0+00 to 1+44	Length 144 FT
" 10+07 to 10+31	" 24 "
" 14+88 to 15+00	" 12 "

TOTAL THIS SHEET 232 FT

NEW CULVERTS REQUIRED

Sta. 10+19	2'x2' Concrete Culvert
" 1-2'-4"	Concrete 5.5' Curb
" 1-2'-5"	" 7.3 "
Sta. 15+00	15" Concrete Pipe 32 FT
" 1-2'-5"	Concrete 20 Curb
" Curb	6.2 "

SUB BASE REQUIRED

Sta. 3+00 to 15+00 Length 1205.5 FT

PROJECT NO.	STATE	FED. AID	FISCAL YEAR	SHEET NO.	TOTAL SHEETS
9	VT	50	1922	9	11

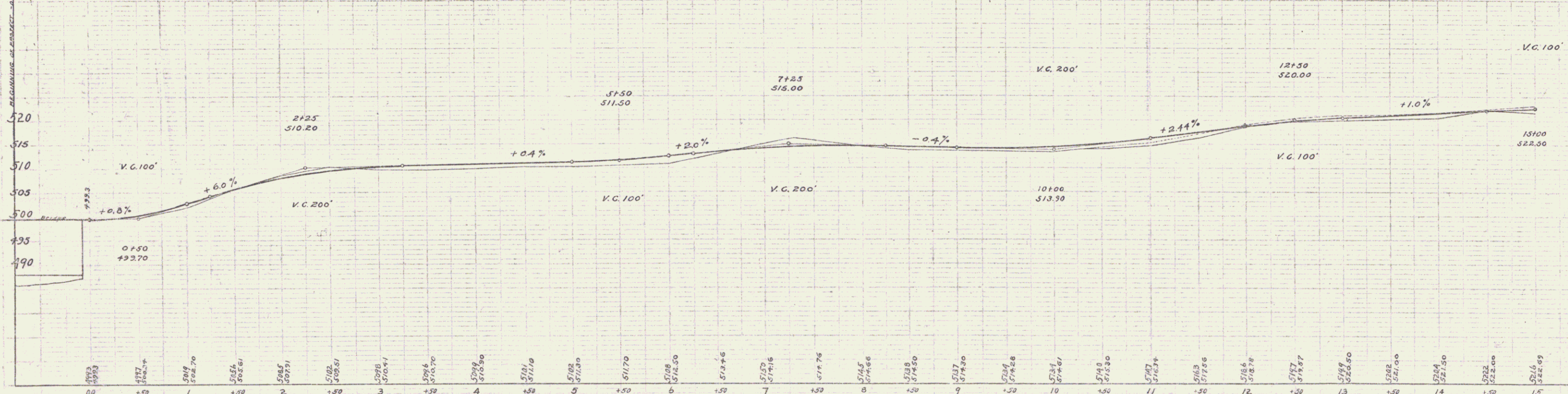
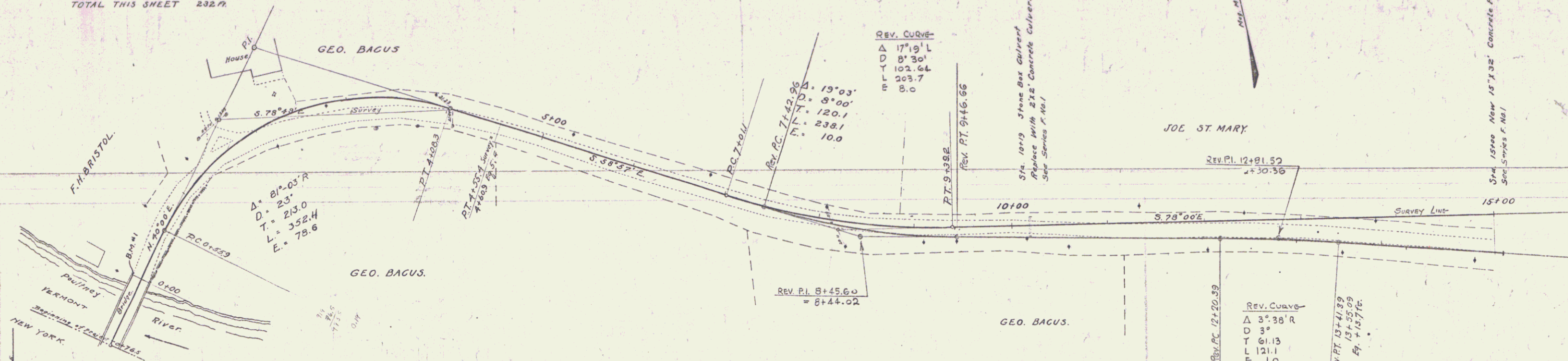

B.M. #1. Top of Curb North End of Bridge. East Side. Sta. 0+00 Elev. 500.00

Series No. 11
Sheet 9 of 11