

Guard Rail Required
 On Right
 Sta. 3143 to Bridge 24'
 Bridge to Sta. 4142 24'

On Left
 Sta. 2196 to Bridge 64'
 Bridge to Sta. 4130 24'
 Total on sheet 136'

STATE OF MISSOURI
 DEPARTMENT OF HIGHWAYS
 DISTRICT NO. 1
 PROJECT NO. 17924
 SHEET NO. 13

Br 11

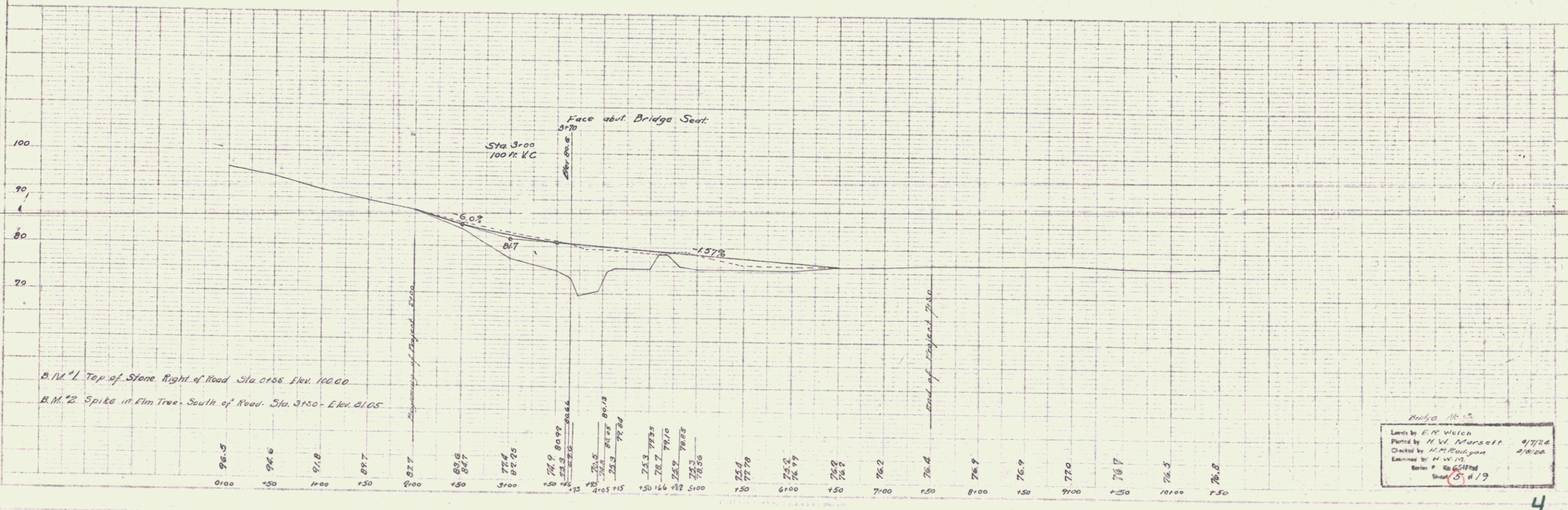
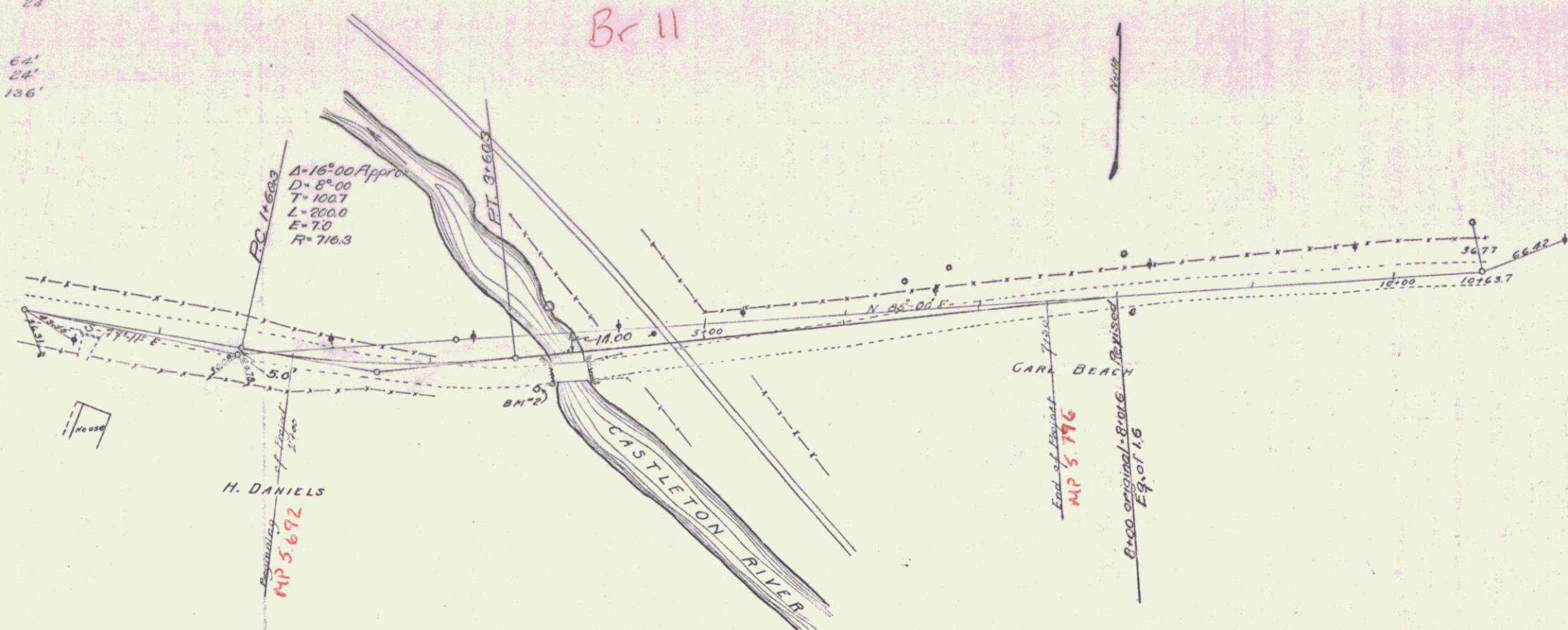

PLAN
 E. M. VITCH
 DISTRICT ENGINEER
 DISTRICT NO. 1

PROFILE
 H. M. MARSHALL
 DISTRICT ENGINEER
 DISTRICT NO. 1

Bridge No. 5
 Lined by E. M. Vitich
 Plotted by H. M. Marshall 4/7/26
 Checked by H. M. Marshall 4/8/26
 Examined by H. W. 10
 Series P. No. 617
 Sheet 8 of 19