

PROPERTY LINE FENCE WITH STEEL POSTS ITEM 583-II MOD.		
STATION	STATION	POS.
EB 994+85	1007+18	CP
997+20	1006+83	CP

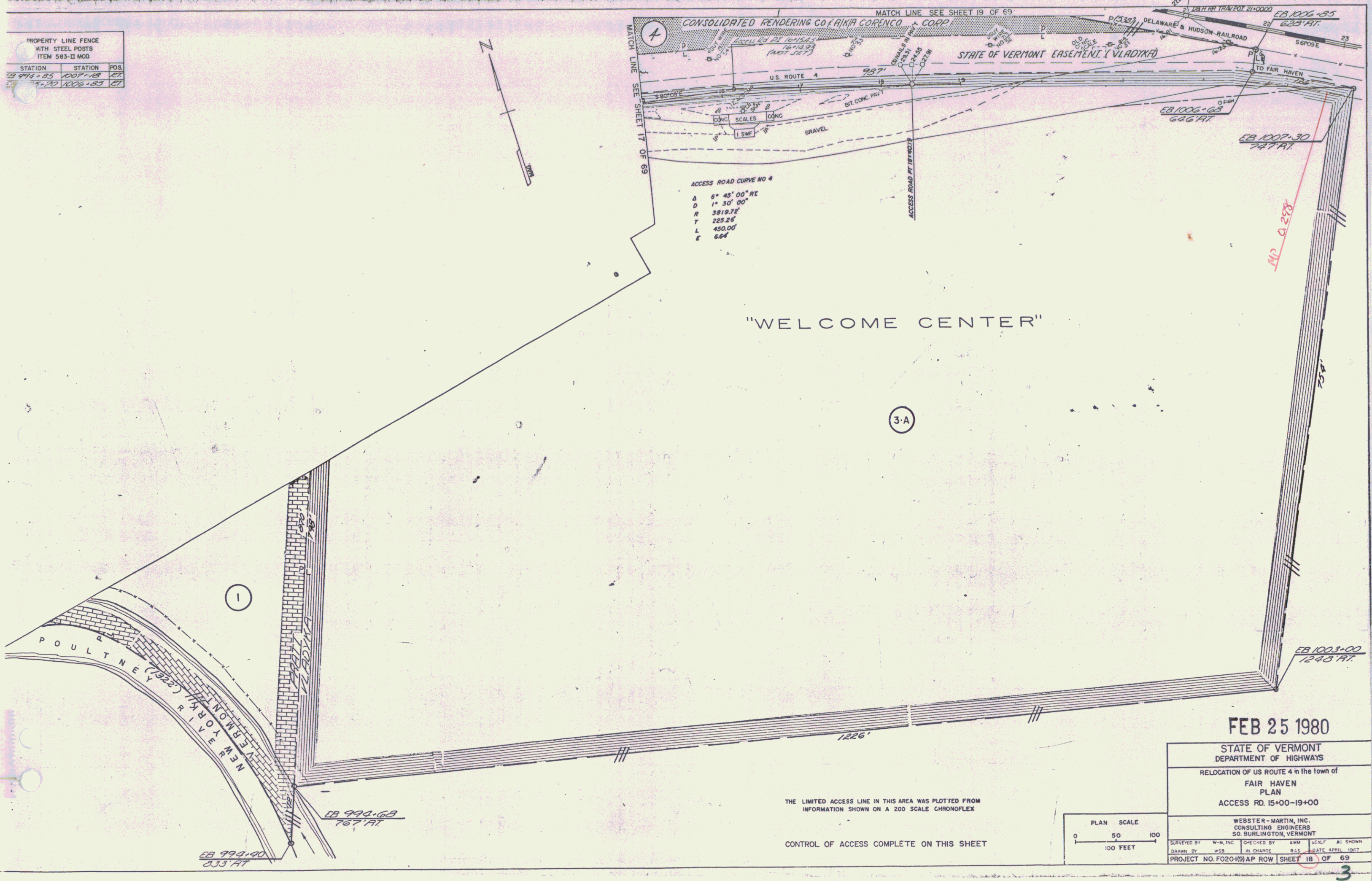

ACCESS ROAD CURVE NO 4  
 Δ 8° 45' 00" RT  
 D 1° 30' 00"  
 R 3819.72'  
 T 225.26'  
 L 450.00'  
 E 6.64'

"WELCOME CENTER"

3-A

FEB 25 1980

STATE OF VERMONT DEPARTMENT OF HIGHWAYS RELOCATION OF US ROUTE 4 in the town of FAIR HAVEN PLAN ACCESS RD. 15+00-19+00
WEBSTER-MARTIN, INC. CONSULTING ENGINEERS 30 BURLINGTON, VERMONT
SURVEYED BY: W.M. INC. CHECKED BY: W.M. LOCAL: AS SHOWN DRAWN BY: WSB IN CHARGE: RAS DATE: APRIL 1967 PROJECT NO. F02049) AP ROW SHEET 18 OF 69

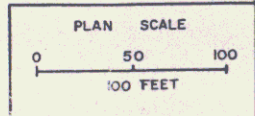

THE LIMITED ACCESS LINE IN THIS AREA WAS PLOTTED FROM INFORMATION SHOWN ON A 200 SCALE CHRONOFLEX  
 CONTROL OF ACCESS COMPLETE ON THIS SHEET

3