

GUARD RAIL REQUIRED
OIL LEFT
 STA 532+05 TO 533+41 LENGTH 136 FT.
 " 535+74 " 536+38 " 64 "
OIL RIGHT
 STA 532+05 TO 532+93 LENGTH 88 FT.
 " 535+34 " 536+38 " 104 "
 TOTAL OF SHEET 392 FT

NEW CULVERTS REQUIRED
 STA 532+74.5 2x2 CONC. BOX 33ft
 1-2' CONC. 9.2 CU YDS.
 1-2 1/2' CONC. 8.3 " "
 Rein Steel 727 lbs.

PL. ROAD STATE PROJ. AGI. FISCA. BURE. 1914
 DIST. NO. 1000 1914
 1914 1914 1914 1914

Δ 53°-51' HOR
 D 74.30' 12°
 R 784.0 242.5
 T 308.0 449.9
 L 718.0 492.9
 E 92.9 58.0

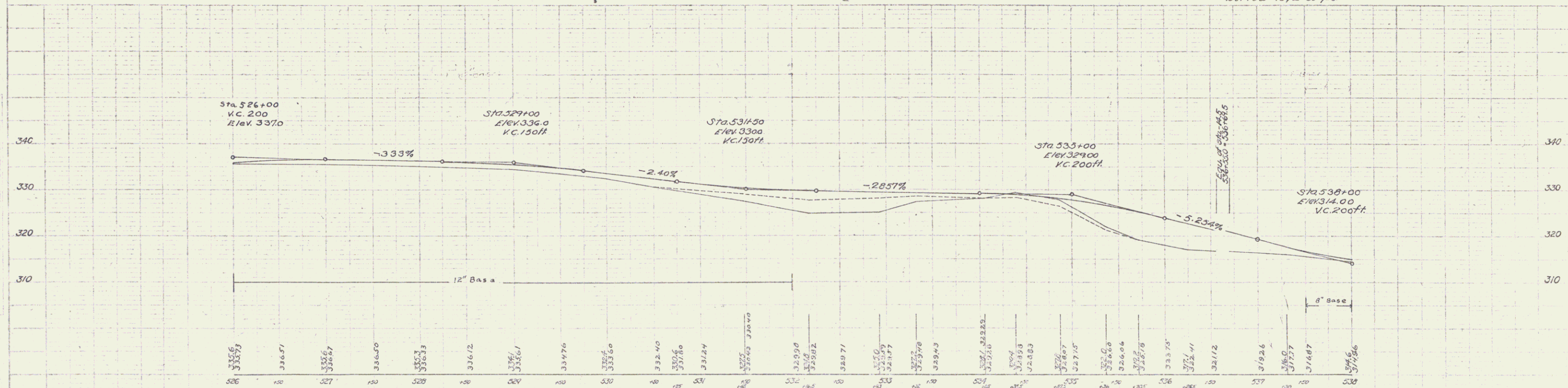
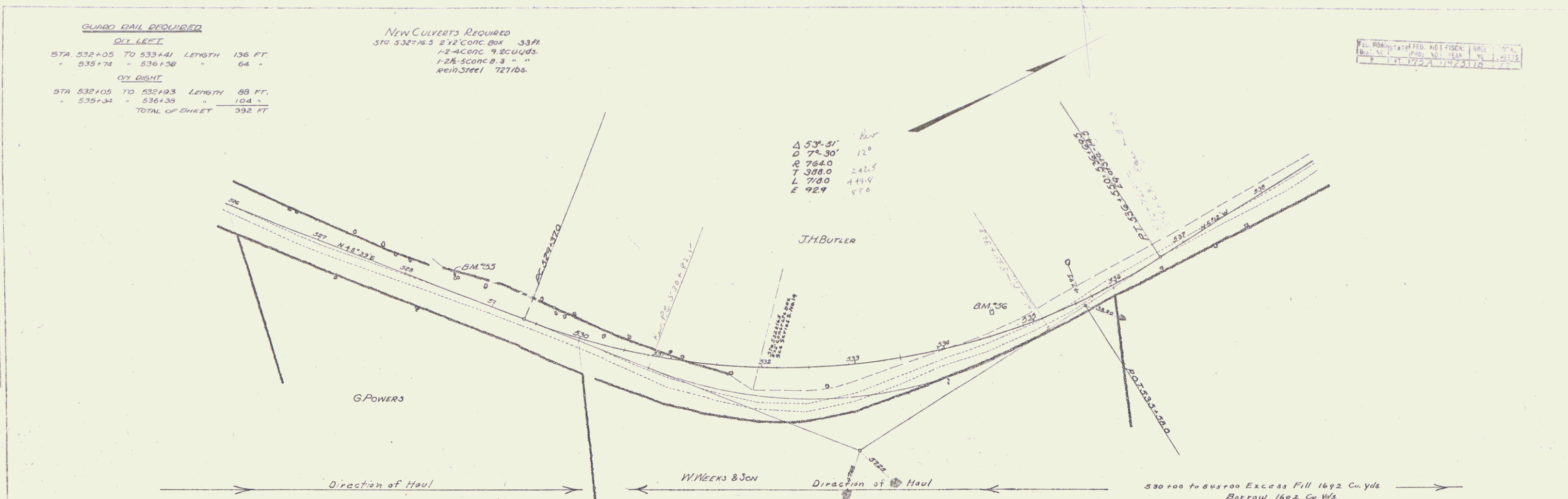

BM #55 Spike in roots of 8" Elm 14' to left of Sta 528+54 Elev. 335.33
 BM #56 Spike " " " 30' Elm 34' to left of Sta 534+75 Elev. 330.42