

GRADE BAR REQUIRED  
 ON LEFT  
 STA. 473+03 TO STA. 473+27 LENGTH 24 FT.  
 - 479+03 - 480+12 - 104"  
 ON RIGHT  
 STA. 473+03 TO STA. 473+27 LENGTH 24 FT.  
 - 479+08 - 479+32 - 24"  
 TOTAL THIS SHEET 176 FT.

NEW CULVERTS REQUIRED  
 473+15 18" Conc Pipe 30 ft.  
 Conc Class B (1-2 1/2-5) 25 cy  
 479+20 18" Conc Pipe 33 ft.  
 Conc Class D (1-2 1/2-5) 25 cy.

PLAN	176	1	1
SECTION	176	1	1
TOTAL	352	2	2

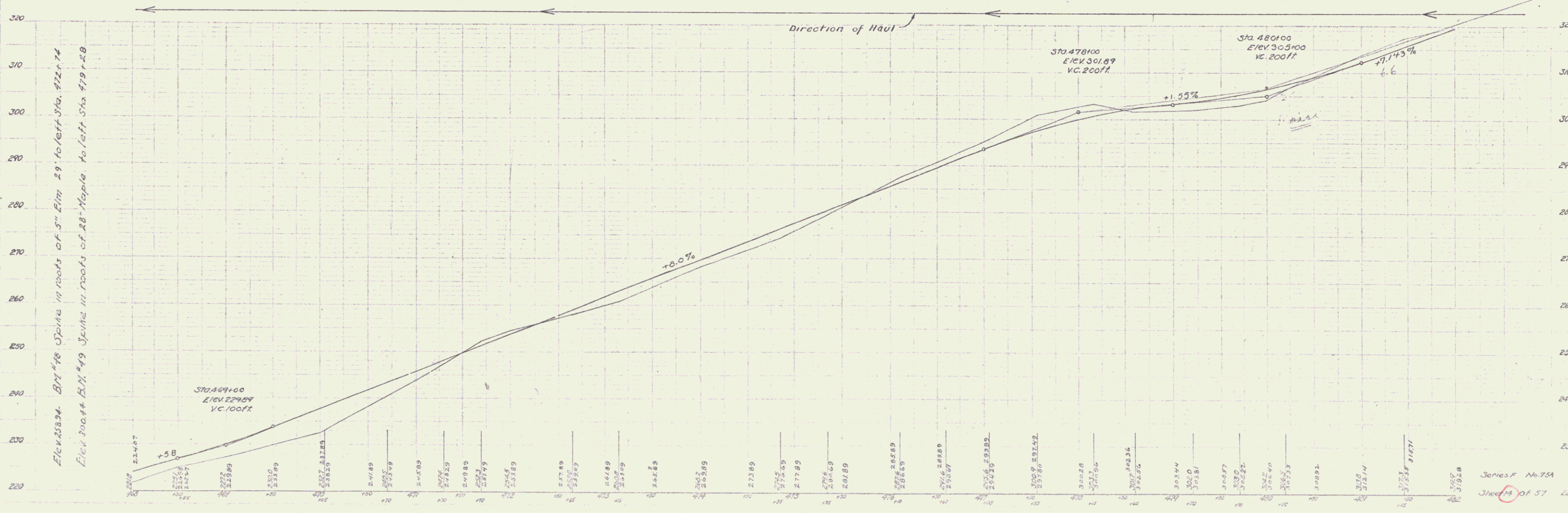
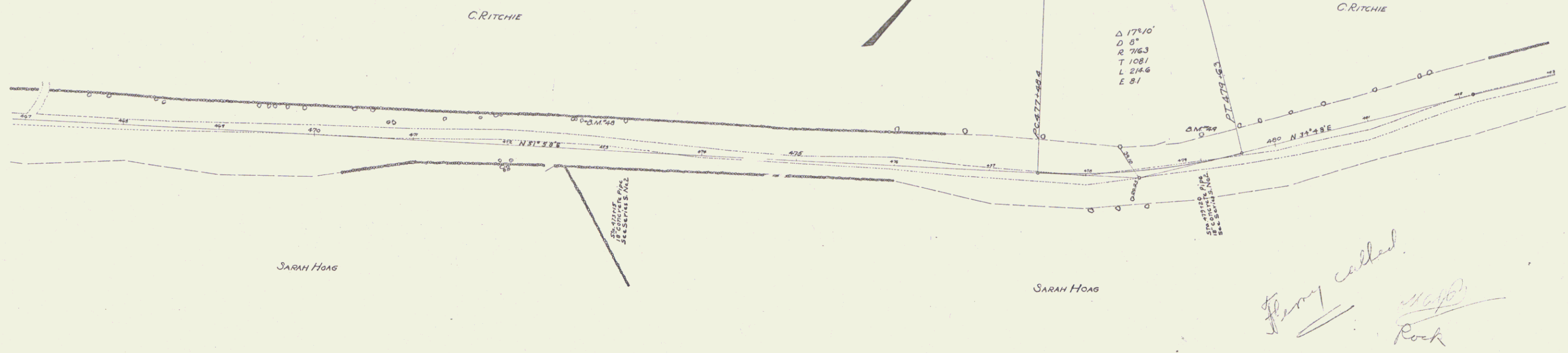

B.M. Stations 4-27  
 B.M. Stations 4-28

B.M. Stations 4-28  
 B.M. Stations 4-29

Elev. 227.00 B.M. 49 Spine in roots of 5" Elm 29' to left Sta. 472+74  
 Elev. 200.44 B.M. 49 Spine in roots of 28" Maple to left Sta. 479+48